

编带产品规格 Taping Specifications (Radial Type)

■ Taping Specifications

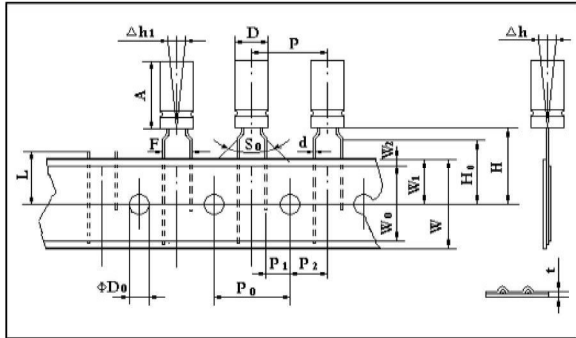

Figure 1

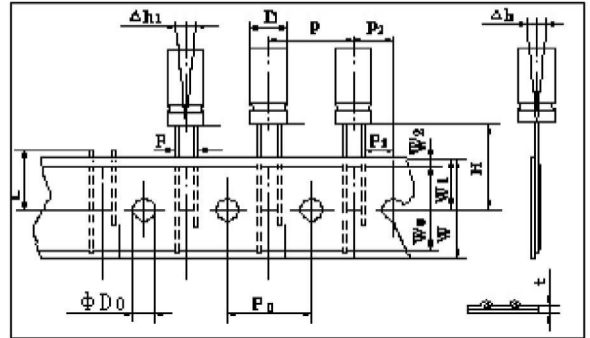

Figure 2

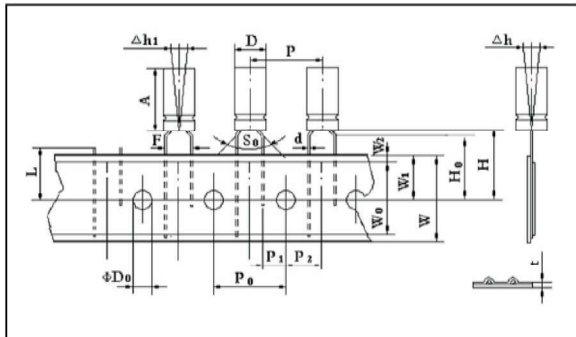

Figure 3

■ Packaging Specification

Diameter	Ammunition	
	Quantity/Box(pcs)	Ammunition packing dimensions(mm)
φ 4	3000	330 × 296 × 49
φ 5	2000	330 × 250 × 49
φ 6.3	2000	330 × 296 × 49
φ 8	1000	330 × 250 × 49

Code F1	Case Size				Tol
	4*5 4*7	5*5 5*7 5*11	6.3*5 6.3*7 6/6.3*11	8*5 8*7 8*11.5	
Reference figure	Figure 1				--
φ d	0.45	0.45 0.5 (5*11)	0.45 0.5 (6*11)	0.45 0.5(8*7) 0.5(8*11.5)	± 0.05
p	12.7				± 1.0
P ₀	12.7				± 0.3
P ₁	3.85				± 0.5
F	5.0				+0.6/-0.2
Δh	0				± 1.0
W	18.0				± 0.5
W ₀	12min				--
W ₁	9.0				± 0.5
W ₂	2.0 max				--
H	18.5 (17.5) *				± 0.5
H ₀	16.0				± 0.5
D ₀	4.0				± 0.3
t	0.6				± 0.2
Δh1	0				± 0.2

Code F2	Case Size					Tol
	4*5 4*7	5*5 5*7 5*11	6.3*5 6.3*7 6/6.3*11	8*5 8*7 8*11.5	ϕ 10	
Reference figure	Figure 2					--
ϕ d	0.45	0.45 0.5 (5*11)	0.45 0.5 (6*11)	0.45 0.5(8*7) 0.5(8*11.5)	0.60	± 0.05
p	12.7					± 1.0
P ₀	12.7					± 0.3
P ₁	5.6	5.35	5.1	4.6	3.85	± 0.5
F	1.5	2.0	2.5	3.5	5.0	+0.6/-0.2
Δ h	0					± 1.0
W	18.0					± 0.5
W ₀	12min					--
W ₁	9.0					± 0.5
W ₂	2.0 max					--
H	18.5 (17.5) *					± 0.5
H ₀	--					--
D ₀	4.0					± 0.3
t	0.6					± 0.2
Δ h1	0					± 0.2

Code F3	Case Size			Tol
	4*5 4*7	5*5 5*7 5*11	8*5 8*7	
Reference figure	Figure 3		Figure 2	--
ϕ d	0.45	0.45 0.5 (5*11)	0.45 0.5(8*7)	± 0.05
p	12.7			± 1.0
P ₀	12.7			± 0.3
P ₁	5.1			± 0.5
F	2.5			+0.6/-0.2
Δ t	0			± 1.0
W	18.0			± 0.5
W _c	12min			--
W ₁	9.0			± 0.5
W ₂	2.0 max			--
H	18.5 (17.5) *			± 0.5
H ₀	16.0		--	± 0.5
D ₀	4.0			± 0.3
t	0.6			± 0.2
Δ h1	0			± 0.2

成型产品规格

Lead Forming Specifications (Radial Type)

■ Lead Forming Specifications

Code		Case Size				Shape Figure
		D	d ± 0.05	s ± 0.5	h	
C	1	φ 4	φ 0.45	1.5	h ± 0.3	
		φ 5	φ 0.45/0.5	2.0		
		φ 6.3	φ 0.45/0.5	2.5		
		φ 8	φ 0.45/0.5	3.5		
C	B	φ 4	φ 0.45	5	h ± 0.3	
		φ 5	φ 0.45/0.5	5	h ± 0.3	
		φ 6.3	φ 0.45/0.5	5	h ± 0.3	
		φ 8	φ 0.45/0.5	5	h ± 0.3	
C	K	φ 4	φ 0.45	1.5	h ± 0.5	
		φ 5	φ 0.45	2.0	h ± 0.5	
		φ 6.3	φ 0.45	2.5	h ± 0.5	
		φ 8	φ 0.45	3.5	h ± 0.5	
	φ 0.50					
C	N	φ 4	φ 0.45	1.5	h ± 0.5	
		φ 5	φ 0.45	2.0	h ± 0.5	
		φ 6.3	φ 0.45	2.5	h ± 0.5	
C	M	φ 4	φ 0.45	1.5	h ± 0.5	
		φ 5	φ 0.45	2.0	h ± 0.5	
		φ 6.3	φ 0.45	2.5	h ± 0.5	

Note: "h" depends on customer's requirement.