

NO. 序号	Specified voltage and frequency 额定电压及频率	Specified capacity and capacity deviation 额定电容及电容偏差	Over all dimension 外形尺寸 (mm) ($\phi D \times H$) \pm	Remark 备注
1	450VAC 50/60Hz	1.5 μ F \pm 5%	$\phi 30 \times 57$ M8	
2	450VAC 50/60Hz	2.5 μ F \pm 5%	$\phi 30 \times 57$ M8	
3	450VAC 50/60Hz	4 μ F \pm 5%	$\phi 30 \times 57$ M8	
4	450VAC 50/60Hz	4.5 μ F \pm 5%	$\phi 30 \times 57$ M8	
5	450VAC 50/60Hz	5 μ F \pm 5%	$\phi 30 \times 57$ M8	
6	450VAC 50/60Hz	6 μ F \pm 5%	$\phi 30 \times 57$ M8	
7	450VAC 50/60Hz	8 μ F \pm 5%	$\phi 35 \times 65$ M8	
8	450VAC 50/60Hz	10 μ F \pm 5%	$\phi 35 \times 65$ M8	
Carry out standard		GB 3667.1-2016/IEC60252-1 : 2013		
Operating temp range		-25 \sim +70 $^{\circ}$ C	Lifespan garden 寿命等级	C CLASS
Withstanding standard	Between terminals	2.0UN 2S no breakdown flashover 2.0UN 2S 无击穿及飞弧现象		
	Terminals to case	-----		
Capacitance tolerance 电容偏差		\pm 5%		
Loss angle tangent 损耗角正切		\leq 0.0020 (100 Hz)		
	Shape 外形	See right picture 见右图		
	Condenser fuse 电容器芯子	Have self-healing 具有自愈性		

Customer recognizes

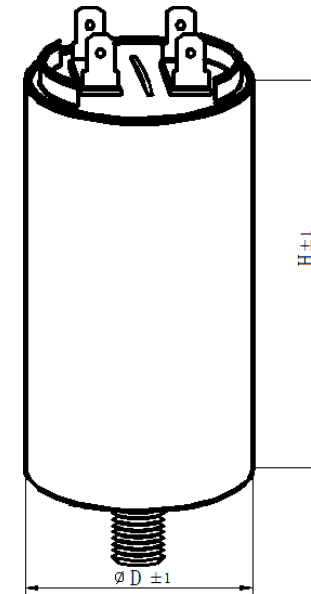

	Case	White of plastics outer shell	Drafts system:	Name: : CBB60 metallized polypropylene film capacitor. 名称: CBB60
	Terminals	250# Terminal 2+2 250 型 端子 2+2	Approval	
	Filling	Epoxy resin		