

The product advantages



Euromas II represents not only visually an alternative to the classic EUROMAS industrial enclosure. Special attention was paid to the numerous mounting opportunities for PCBs and keypads.



The F-versions have a recessed surface in the lid for the flush mounting of membrane keypads.



Fixing domes for PCBs are available not only in the base but also in the lid.



Depending on the model, the bases are equipped with additional specially matched fixings for DIN rails or integrated clamp profiles.



The LP versions are available for the vertical mounting of PCBs.



Quick-Finder:
www.bopla.de/62

Examples of use





BOPLA

A Phoenix Mecano Company

Euromas II



Colour:

● Light grey, similar to RAL 7035

Special colours on request

Protection class:

IP65 / DIN EN 60529

Material:

Enclosure: ABS or PC (UV stabilized)

Seal: CR

For details see technical information.



Enclosure sizes

EM / ET 205



EM / ET 206



EM / ET 208

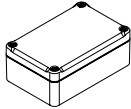

EM / ET 210

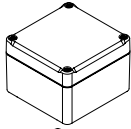

EM / ET 212

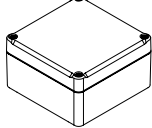

EM / ET 213

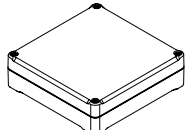

EM / ET 215

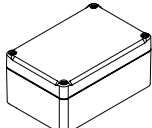

EM / ET 217

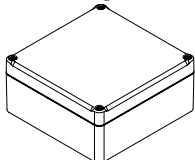

EM / ET 220

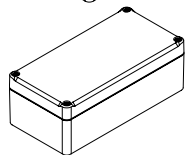

EM / ET 221

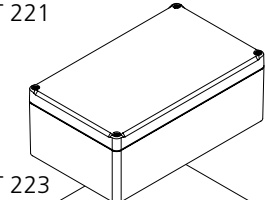

EM / ET 223

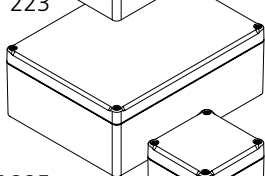

EM / ET 225

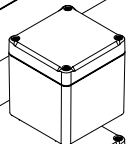

EM / ET 227

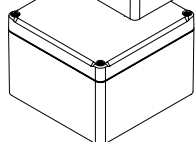

EM / ET 229

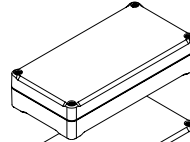

EM / ET 231

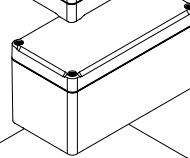

EM / ET 232

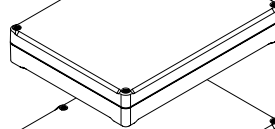

EM / ET 233

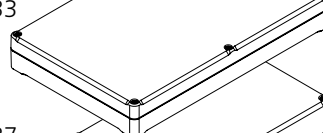

EM / ET 237

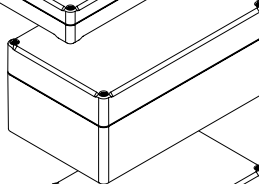

EM / ET 238

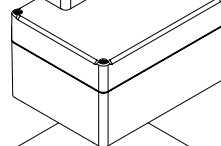

EM / ET 239

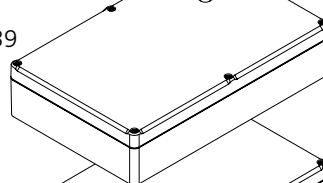

EM / ET 240

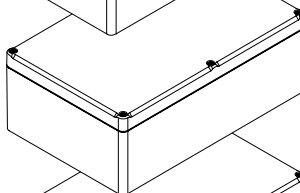

EM / ET 241

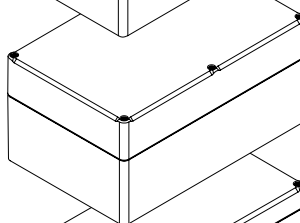

EM / ET 242

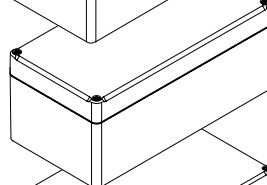

EM / ET 247

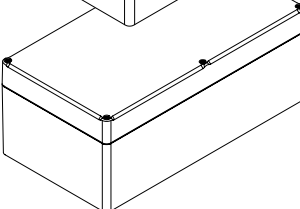

Design types

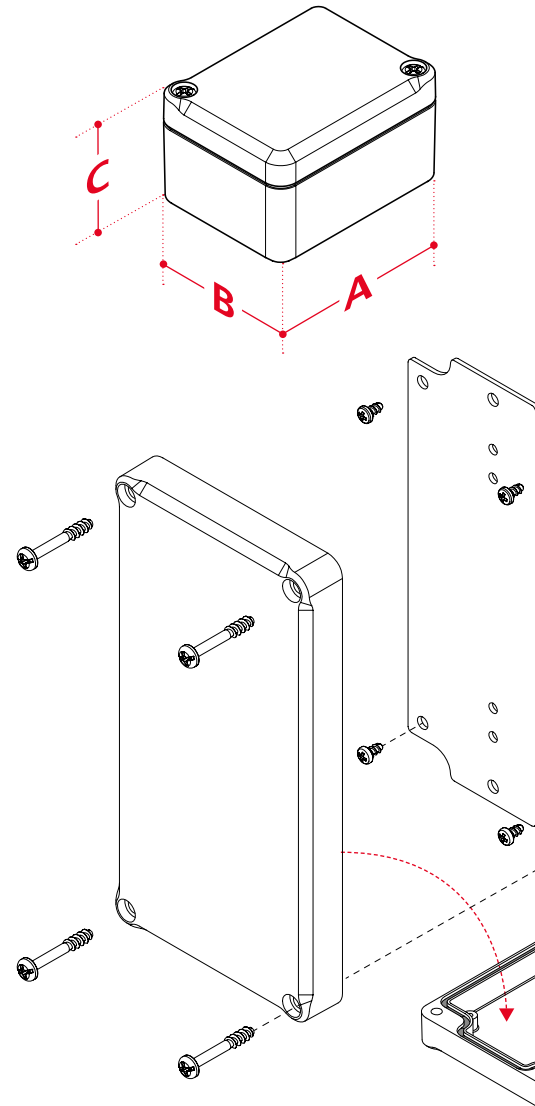

Integrated row of domes

Terminal blocks for direct mounting

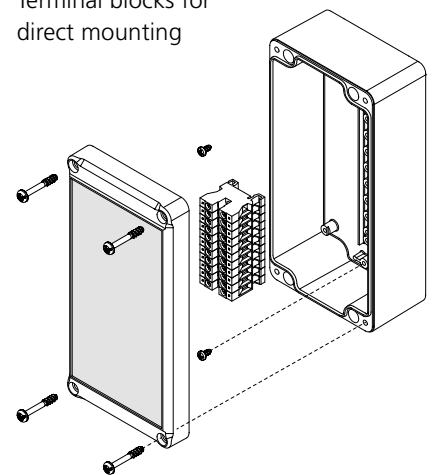



BOPLA

A Phoenix Mecano Company

Euromas II

EM-WL

Screw-on wall brackets
as an alternative

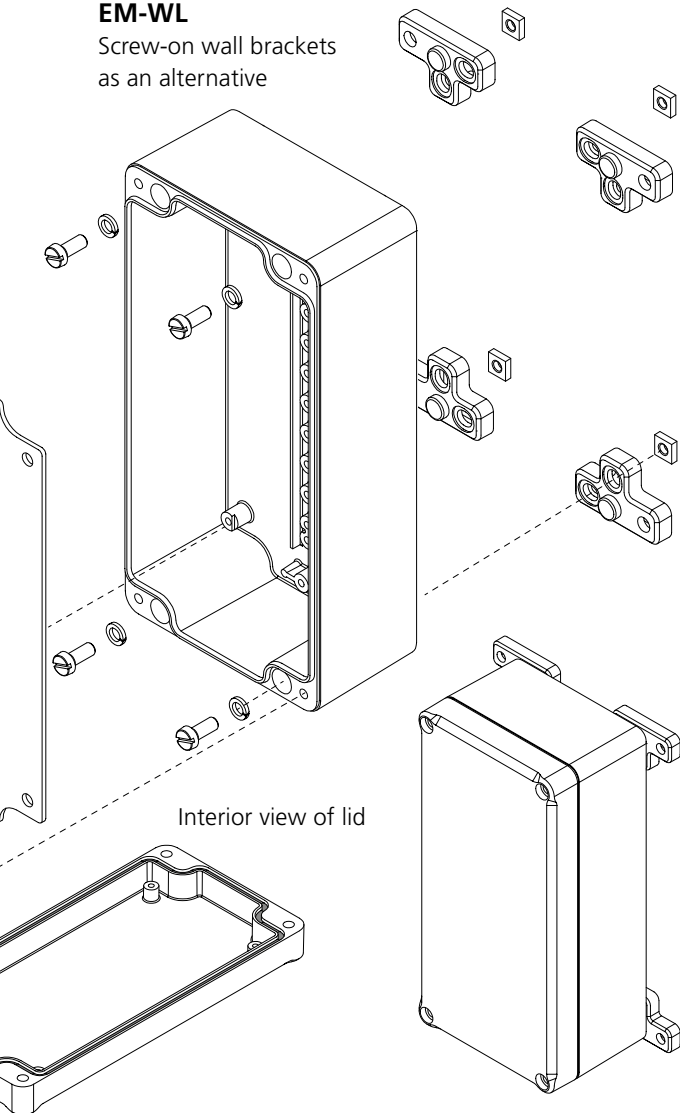

Interior view of lid

Variant EM / ET...LP

with grooves for the vertical
mounting of PCBs

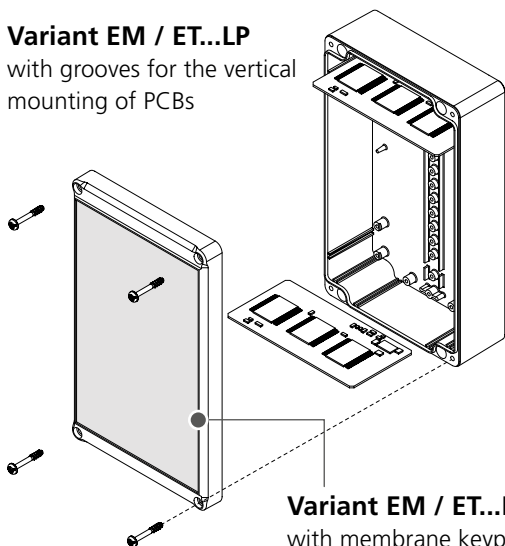

Variant EM / ET...F

with membrane keypad edge

Dimensions

Model	A	B	C	F	LP	F+LP
EM / ET 205	74	50	37	✓		
EM / ET 206	65	50	37	✓		
EM / ET 207	82	60	57		✓	✓
EM / ET 208	98	64	38	✓		
EM / ET 210	82	80	57	✓		
EM / ET 212	100	100	57	✓		
EM / ET 213	122	120	37	✓		
EM / ET 214	200	120	57		✓	✓
EM / ET 215	120	80	57	✓		
EM / ET 217	122	120	57	✓		
EM / ET 218	150	150	57		✓	✓
EM / ET 220	160	80	57	✓		
EM / ET 221	200	120	77	✓		
EM / ET 223	200	150	77	✓		
EM / ET 224	240	80	60		✓	✓
EM / ET 225	82	80	87	✓		
EM / ET 227	122	120	87	✓		
EM / ET 229	160	80	37	✓		
EM / ET 231	160	80	87	✓		
EM / ET 232	200	150	37	✓		
EM / ET 233	250	160	37	✓		
EM / ET 236	240	80	80		✓	✓
EM / ET 237	200	120	92	✓		
EM / ET 238	160	120	92	✓		
EM / ET 239	250	160	57	✓		
EM / ET 240	250	160	92	✓		
EM / ET 241	250	160	122	✓		
EM / ET 242	240	120	102	✓		
EM / ET 247	300	160	120		✓	✓

EM-F / ET-F versions: because of the membrane keypad edge on the lid, dimension C is 1 mm higher.

Accessories



Rubber feet



Screw covers



DIN rails
TH 15, G 32, TH 35



Mast mounting

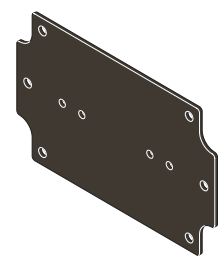

Mounting panels in different versions

Euromas II

ABS, single-colored

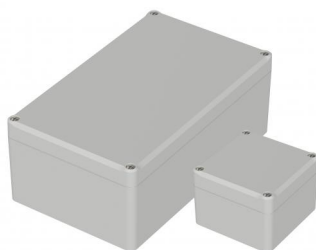

Enclosure, ABS

Model	Order no.	A	B	C	a1	a2	b1	b2	b3	c1	c2
ET 205	63205000	52	50	37	46.5	30	44.5	28	-	10	33
ET 206	63206000	65	50	37	59.5	43	44.5	28	-	10	32
ET 207 LP	63207300	82	60	57	75.3	56.5	53.3	25.5	-	15	51
ET 208	63208000	98	64	38	89.5	73.5	55.5	32.2	-	10	31.5
ET 210	63210000	82	80	57	75.3	56.5	73.3	36.5	-	15	51
ET 212	63212000	100	100	57	93.3	74.5	93.3	56.5	-	15	51
ET 213	63213000	122	120	37	115.6	96.8	113.6	76.8	-	15	31
ET 214 LP	63214300	200	120	57	193.2	174.4	113.2	74.3	-	15	51
ET 215	63215000	120	80	57	113.3	94.5	73.3	36.5	-	15	51
ET 217	63217000	122	120	57	115.3	96.5	113.3	76.5	-	15	51
ET 218 LP	63218300	150	150	57	143.3	124.5	143.3	106.5	-	15	51
ET 220	63220000	160	80	57	153.3	134.5	73.3	36.5	-	15	51
ET 221	63221000	200	120	77	192.9	174.1	112.9	74	-	15	71
ET 223	63223000	200	150	77	192.9	174.1	142.9	105.1	-	15	71
ET 224 LP	63224300	240	80	60	233.3	214.5	73.3	36.5	-	20	54
ET 225	63225000	82	80	87	75	56.2	73	36.2	-	15	81
ET 227	63227000	122	120	87	115	96.2	113	76.2	-	15	81
ET 229	63229000	160	80	37	153.6	134.8	73.6	36.8	-	15	31
ET 231	63231000	160	80	87	153	134.2	73	36.2	-	15	81
ET 232	63232000	200	150	37	193.6	174.8	143.6	105.8	-	15	31
ET 233	63233000	250	160	37	243.6	224.8	153.6	115.8	134.4	15	31
ET 236 LP	63236300	240	80	80	233.3	214.5	73.3	36.5	-	40	74
ET 237	63237000	200	120	92	192.9	174.1	112.9	74	-	30	86
ET 238	63238000	160	120	92	152.9	134.1	112.9	74	-	30	86
ET 239	63239000	250	160	57	243.4	224.6	153.4	115.6	134.5	15	51
ET 240	63240000	250	160	92	242.9	224.1	152.9	115.1	134.1	15	86
ET 241	63241000	250	160	122	242.9	224.1	152.9	115.1	134.1	45	116
ET 242	63242000	240	120	102	232.9	214.1	112.9	76.1	-	25	96
ET 247 LP	63247300	300	160	120	292.7	272.9	152.7	112.9	134.4	30	114

Scope Of Delivery: Lid and base, self-tapping coarse-pitch thread lid screws made of V2A

Notes: Material shrinkage may result in ABS enclosures being approx. 0.1 – 0.25 % larger.



BOPLA

A Phoenix Mecano Company

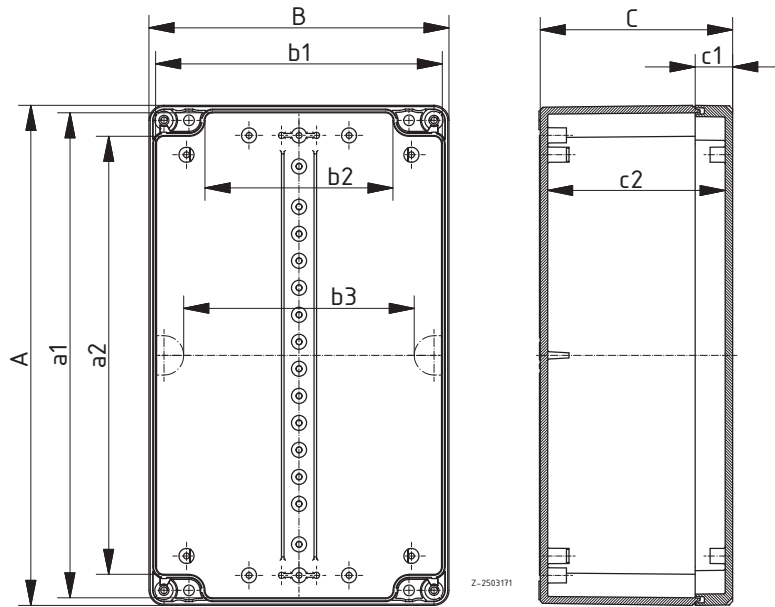

Euromas II

ABS, with membrane keypad edge



Enclosure, ABS

Model	Order no.	A	B	C	a1	a2	b1	b2	b3	c1	c2
ET 205 F	63205200	52	50	37	46.5	30	44.5	28	-	10	33
ET 206 F	63206200	65	50	37	59.5	43	44.5	28	-	10	32
ET 207 F-LP	63207400	82	60	57	75.3	56.5	53.3	25.5	-	15	51
ET 208 F	63208200	98	64	38	89.5	73.5	55.5	32.2	-	10	31.5
ET 210 F	63210200	82	80	57	75.3	56.5	73.3	36.5	-	15	51
ET 212 F	63212200	100	100	57	93.3	74.5	93.3	56.5	-	15	51
ET 213 F	63213200	122	120	37	115.6	96.8	113.6	76.8	-	15	31
ET 214 F-LP	63214400	200	120	57	193.2	174.4	113.2	74.3	-	15	51
ET 215 F	63215200	120	80	57	113.3	94.5	73.3	36.5	-	15	51
ET 217 F	63217200	122	120	57	115.3	96.5	113.3	76.5	-	15	51
ET 218 F-LP	63218400	150	150	57	143.3	124.5	143.3	106.5	-	15	51
ET 220 F	63220200	160	80	57	153.3	134.5	73.3	36.5	-	15	51
ET 221 F	63221200	200	120	77	192.9	174.1	112.9	74	-	15	71
ET 223 F	63223200	200	150	77	192.9	174.1	142.9	105.1	-	15	71
ET 224 F-LP	63224400	240	80	60	233.3	214.5	73.3	36.5	-	20	54
ET 225 F	63225200	82	80	87	75	56.2	73	36.2	-	15	81
ET 227 F	63227200	122	120	87	115	96.2	113	76.2	-	15	81
ET 229 F	63229200	160	80	37	153.6	134.8	73.6	36.8	-	15	31
ET 231 F	63231200	160	80	87	153	134.2	73	36.2	-	15	81
ET 232 F	63232200	200	150	37	193.6	174.8	143.6	105.8	-	15	31
ET 233 F	63233200	250	160	37	243.6	224.8	153.6	115.8	134.4	15	31
ET 236 F-LP	63236400	240	80	80	233.3	214.5	73.3	36.5	-	40	74
ET 237 F	63237200	200	120	92	192.9	174.1	112.9	74	-	30	86
ET 238 F	63238200	160	120	92	152.9	134.1	112.9	74	-	30	86
ET 239 F	63239200	250	160	57	243.4	224.6	153.4	115.6	134.5	15	51
ET 240 F	63240200	250	160	92	242.9	224.1	152.9	115.1	134.1	15	86
ET 241 F	63241200	250	160	122	242.9	224.1	152.9	115.1	134.1	45	116
ET 242 F	63242200	240	120	102	232.9	214.1	112.9	76.1	-	25	96
ET 247 F-LP	63247400	300	160	120	292.7	272.9	152.7	112.9	134.4	30	114

Scope Of Delivery: Lid and base, self-tapping coarse-pitch thread lid screws made of V2A

Notes: Material shrinkage may result in ABS enclosures being approx. 0.1 – 0.25 % larger.



BOPLA

A Phoenix Mecano Company

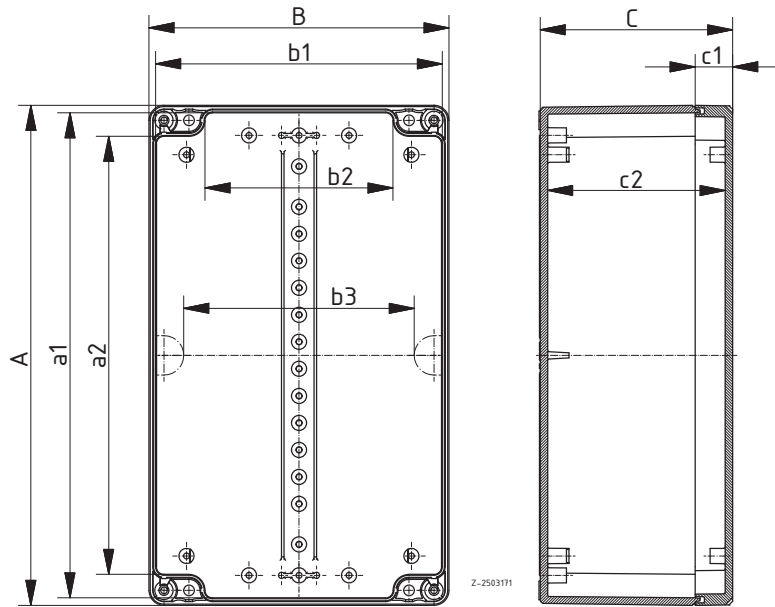

Euromas II

PC, single-coloured

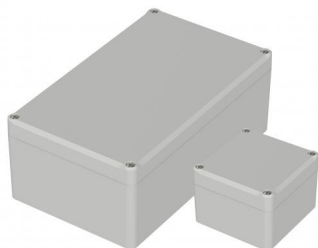

Enclosure, polycarbonate

Model	Order no.	A	B	C	a1	a2	b1	b2	b3	c1	c2
EM 205	62205000	52	50	37	46.5	30	44.5	28	-	10	33
EM 206	62206000	65	50	37	59.5	43	44.5	28	-	10	32
EM 207 LP	62207300	82	60	57	75.3	56.5	53.3	25.5	-	15	51
EM 208	62208000	98	64	38	89.5	73.5	55.5	32.2	-	10	31.5
EM 210	62210000	82	80	57	75.3	56.5	73.3	36.5	-	15	51
EM 212	62212000	100	100	57	93.3	74.5	93.3	56.5	-	15	51
EM 213	62213000*	122	120	37	115.6	96.8	113.6	76.8	-	15	31
EM 214 LP	62214300	200	120	57	193.2	174.4	113.2	74.3	-	15	51
EM 215	62215000	120	80	57	113.3	94.5	73.3	36.5	-	15	51
EM 217	62217000	122	120	57	115.3	96.5	113.3	76.5	-	15	51
EM 218 LP	62218300	150	150	57	143.3	124.5	143.3	106.5	-	15	51
EM 220	62220000	160	80	57	153.3	134.5	73.3	36.5	-	15	51
EM 221	62221000	200	120	77	192.9	174.1	112.9	74	-	15	71
EM 223	62223000	200	150	77	192.9	174.1	142.9	105.1	-	15	71
EM 224 LP	62224300	240	80	60	233.3	214.5	73.3	36.5	-	20	54
EM 225	62225000	82	80	87	75	56.2	73	36.2	-	15	81
EM 227	62227000	122	120	87	115	96.2	113	76.2	-	15	81
EM 229	62229000*	160	80	37	153.6	134.8	73.6	36.8	-	15	31
EM 231	62231000	160	80	87	153	134.2	73	36.2	-	15	81
EM 232	62232000*	200	150	37	193.6	174.8	143.6	105.8	-	15	31
EM 233	62233000*	250	160	37	243.6	224.8	153.6	115.8	134.4	15	31
EM 236 LP	62236300	240	80	80	233.3	214.5	73.3	36.5	-	40	74
EM 237	62237000	200	120	92	192.9	174.1	112.9	74	-	30	86
EM 238	62238000	160	120	92	152.9	134.1	112.9	74	-	30	86
EM 239	62239000	250	160	57	243.4	224.6	153.4	115.6	134.5	15	51
EM 240	62240000	250	160	92	242.9	224.1	152.9	115.1	134.1	15	86
EM 241	62241000	250	160	122	242.9	224.1	152.9	115.1	134.1	45	116
EM 242	62242000	240	120	102	232.9	214.1	112.9	76.1	-	25	96
EM 247 LP	62247300	300	160	120	292.7	272.9	152.7	112.9	134.4	30	114

Scope Of Delivery: Lid and base, self-tapping coarse-pitch thread lid screws made of V2A

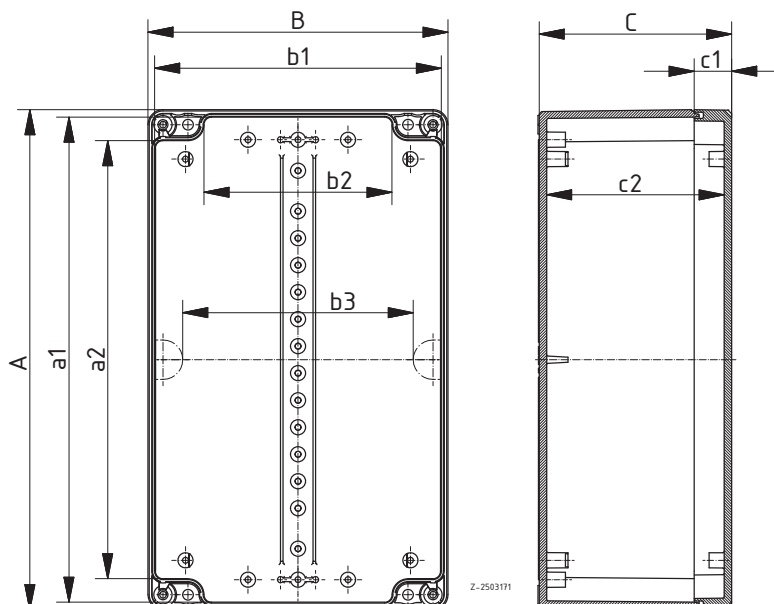

Euromas II

PC, with membrane keypad edge

Enclosure, polycarbonate

Model	Order no.	A	B	C	a1	a2	b1	b2	b3	c1	c2
EM 205 F	62205200	52	50	37	46.5	30	44.5	28	-	10	33
EM 206 F	62206200	65	50	37	59.5	43	44.5	28	-	10	32
EM 207 F-LP	62207400	82	60	57	75.3	56.5	53.3	25.5	-	15	51
EM 208 F	62208200	98	64	38	89.5	73.5	55.5	32.2	-	10	31.5
EM 210 F	62210200	82	80	57	75.3	56.5	73.3	36.5	-	15	51
EM 212 F	62212200	100	100	57	93.3	74.5	93.3	56.5	-	15	51
EM 213 F	62213200*	122	120	37	115.6	96.8	113.6	76.8	-	15	31
EM 214 F-LP	62214400	200	120	57	193.2	174.4	113.2	74.3	-	15	51
EM 215 F	62215200	120	80	57	113.3	94.5	73.3	36.5	-	15	51
EM 217 F	62217200	122	120	57	115.3	96.5	113.3	76.5	-	15	51
EM 218 F-LP	62218400	150	150	57	143.3	124.5	143.3	106.5	-	15	51
EM 220 F	62220200	160	80	57	153.3	134.5	73.3	36.5	-	15	51
EM 221 F	62221200	200	120	77	192.9	174.1	112.9	74	-	15	71
EM 223 F	62223200	200	150	77	192.9	174.1	142.9	105.1	-	15	71
EM 224 F-LP	62224400	240	80	60	233.3	214.5	73.3	36.5	-	20	54
EM 225 F	62225200	82	80	87	75	56.2	73	36.2	-	15	81
EM 227 F	62227200	122	120	87	115	96.2	113	76.2	-	15	81
EM 229 F	62229200*	160	80	37	153.6	134.8	73.6	36.8	-	15	31
EM 231 F	62231200	160	80	87	153	134.2	73	36.2	-	15	81
EM 232 F	62232200*	200	150	37	193.6	174.8	143.6	105.8	-	15	31
EM 233 F	62233200*	250	160	37	243.6	224.8	153.6	115.8	134.4	15	31
EM 236 F-LP	62236400	240	80	80	233.3	214.5	73.3	36.5	-	40	74
EM 237 F	62237200	200	120	92	192.9	174.1	112.9	74	-	30	86
EM 238 F	62238200	160	120	92	152.9	134.1	112.9	74	-	30	86
EM 239 F	62239200	250	160	57	243.4	224.6	153.4	115.6	134.5	15	51
EM 240 F	62240200	250	160	92	242.9	224.1	152.9	115.1	134.1	15	86
EM 241 F	62241200	250	160	122	242.9	224.1	152.9	115.1	134.1	45	116
EM 242 F	62242200	240	120	102	232.9	214.1	112.9	76.1	-	25	96
EM 247 F-LP	62247400	300	160	120	292.7	272.9	152.7	112.9	134.4	30	114



Scope Of Delivery: Lid and base, self-tapping coarse-pitch thread lid screws made of V2A

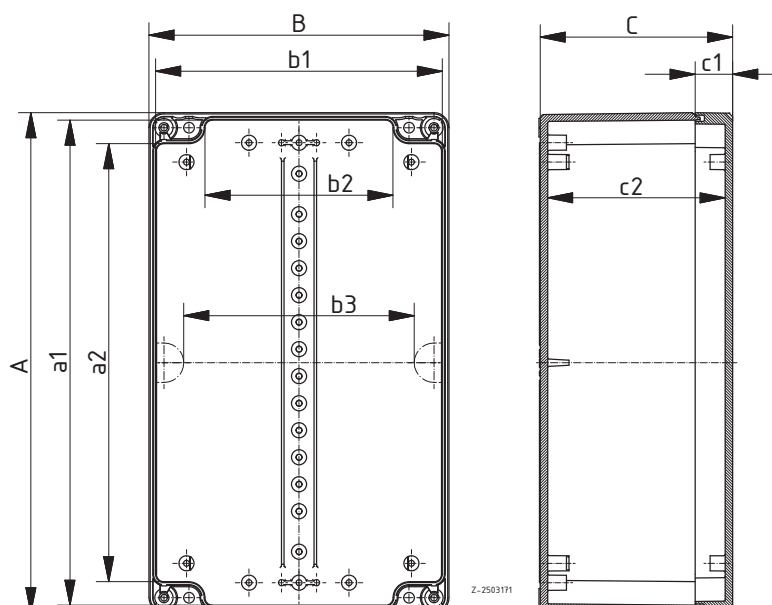

Euromas II

Mounting panels



Mounting panels, laminated paper

Model	Order no.	Note
M	22000100	For EM/ET 205, M/T 205
M	22000200	For EM/ET 206, M/T 206
M	22207001	For EM/ET 207**
M	22000300	For EM/ET 210, EM/ET 225, M/T 210, M/T 225
M	22000400	For EM/ET 215, M/T 215-216, M/T 226, M/T 230
M	22212000	For EM/ET 212**
M	22000500	For EM/ET 217, EM/ET 227, M/T 217, M/T 227-228
M	22214001	For EM/ET 214**
M	22000600	For EM/ET 220, EM/ET 231, M/T 219-220, M/T 231-235
M	22000700	For EM/ET 221, EM/ET 237, M/T 221, M/T 237
M	22000800	For EM/ET 223, M/T 223
M	22218001	For EM/ET 218**
M	22000900	For EM/ET 239-241, M/T 240, M/T 241, M/T 250
M	22001100	For EM/ET 238, M/T 238, M/T 246
M	22001200	For EM/ET 242, M/T 242
M	22224001	For EM/ET 224, EM/ET 236**
M	22247001	For EM/ET 247**

Scope Of Delivery: 1 mounting panel

Notes: * = The mounting panel can also be fitted in the enclosure lid.

Euromas II

Accessories

Mast mounting, stainless steel V2A, uncoated

Model	Order no.
MH 080	96500080
MH 122	96500122
MH 167	96500167
MH 220	96500220
MH 265	96500265

Scope Of Delivery: MH: 1 set (2 pieces) BFS: 20 pieces

Notes: Please order the assembly kit and mast clamp as per the table.



Assembly kit for mast mounting

Model	Order no.	Note
BFS MH 1	96500001	Fixing kit
BFS MH 2	96500002	Fixing kit
BFS MH 3	96500003	Fixing kit

Scope Of Delivery: 20 pieces (for 5 sets of mast mountings)

Notes: Details of the matching mast mounting for each enclosure size and the accompanying assembly kit can be found in the table (see "Product information").



Clamp for mast mounting, stainless steel

Model	Order no.	Note
MH S 32-50	96500050	Terminal area 32-50 mm
MH S 50-70	96500070	Terminal area 50-70 mm
MH S 70-90	96500090	Terminal area 70-90 mm
MH S 90-110	96500110	Terminal area 90-110 mm
MH S 110-130	96500130	Terminal area 110-130 mm
MH S 130-150	96500150	Terminal area 130-150 mm
MH S 150-170	96500175	Terminal area 150-170 mm
MH S 170-190	96500190	Terminal area 170-190 mm
MH S 190-210	96500210	Terminal area 190-210 mm

Scope Of Delivery: 10 pieces



Verwendung der Mastbefestigung für Euromas II
Use of the mast mounting for Euromas II



Bitte wählen Sie anhand dieser Tabelle je nach Größe und Ausrichtung des Gehäuses die passende Mastbefestigung und den dazugehörigen Befestigungssatz aus.

Please use this table to select the appropriate mast mounting and the associated mounting kit, depending on the size and alignment of the enclosure.

Ausrichtung des Gehäuses / Alignment of the enclosure :

H = horizontal V = vertical

Gehäuse Enclosure	Mastbefestigung Mast mounting		Befestigungssatz Mounting kit
EM/ET 210 H	= MH 080	+	BFS MH 1
EM/ET 210 V	= MH 080	+	BFS MH 1
EM/ET 212 H	= MH 122	+	BFS MH 1
EM/ET 212 V	= MH 080	+	BFS MH 1
EM/ET 213 V/H	= MH 122	+	BFS MH 1
EM/ET 214-LP H	= MH 220	+	BFS MH 1
EM/ET 214-LP V	= MH 122	+	BFS MH 1
EM/ET 215 H	= MH 122	+	BFS MH 1
EM/ET 215 V	= MH 080	+	BFS MH 1
EM/ET 217 V/H	= MH 122	+	BFS MH 1
EM/ET 218-LP H	= MH 167	+	BFS MH 1
EM/ET 218-LP V	= MH 167	+	BFS MH 1
EM/ET 220 H	= MH 167	+	BFS MH 1
EM/ET 220 V	= MH 080	+	BFS MH 1
EM/ET 221 H	= MH 220	+	BFS MH 1
EM/ET 221 V	= MH 122	+	BFS MH 1
EM/ET 223 H	= MH 220	+	BFS MH 1
EM/ET 223 V	= MH 167	+	BFS MH 1
EM/ET 224 H	= MH 265	+	BFS MH 1
EM/ET 224 V	= MH 080	+	BFS MH 1
EM/ET 225 H	= MH 080	+	BFS MH 1
EM/ET 225 V	= MH 080	+	BFS MH 1
EM/ET 227 V	= MH 122	+	BFS MH 1
EM/ET 229 H	= MH 167	+	BFS MH 1
EM/ET 229 V	= MH 080	+	BFS MH 1
EM/ET 231 H	= MH 167	+	BFS MH 1
EM/ET 231 V	= MH 080	+	BFS MH 1
EM/ET 232 H	= MH 220	+	BFS MH 1
EM/ET 232 V	= MH 167	+	BFS MH 1
EM/ET 233 V	= MH 167	+	BFS MH 1
EM/ET 236-LP H	= MH 265	+	BFS MH 1
EM/ET 236-LP V	= MH 080	+	BFS MH 1
EM/ET 237 H	= MH 220	+	BFS MH 1
EM/ET 237 V	= MH 122	+	BFS MH 1
EM/ET 238 H	= MH 167	+	BFS MH 1
EM/ET 238 V	= MH 122	+	BFS MH 1
EM/ET 239 H	= MH 265	+	BFS MH 1
EM/ET 239 V	= MH 167	+	BFS MH 1
EM/ET 240 H	= MH 265	+	BFS MH 1
EM/ET 240 V	= MH 167	+	BFS MH 1
EM/ET 241 H	= MH 265	+	BFS MH 1
EM/ET 241 V	= MH 167	+	BFS MH 1
EM/ET 242 H	= MH 265	+	BFS MH 1
EM/ET 242 V	= MH 122	+	BFS MH 1
EM/ET 247 V	= MH 167	+	BFS MH 1

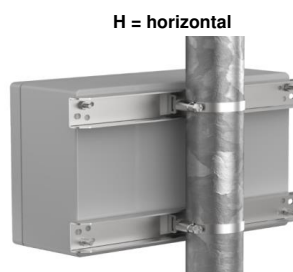

Stand 23.03.2021

Euromas II

Accessories

Wall brackets, screw-on at rear

Model	Order no.
EM-WL	22010000

Scope Of Delivery: 4 wall brackets (polycarbonate), screws



Rubber feet, self-adhesive

Model	Order no.	Colour	Note
GF	22009000	Black	Polyurethane, 65-75 Shore

Scope Of Delivery: 4 pieces



Screw covers

Model	Order no.
EM-SA	22080000

Scope Of Delivery: 6 screw covers (polycarbonate)



DIN rail acc. to DIN EN 60715 TH 15

Model	Order no.	Note
TS 15	22150501	For EM/ET 206
TS 15	22150701	For EM/ET 207-210, EM/ET 225, B 1008..
TS 15	22150901	For EM/ET 212
TS 15	22151101	For EM/ET 213, EM/ET 215-217, EM/ET 227, B 1408.., B 1413..
TS 15	22151901	For EM/ET 214, EM/ET 221-223, EM/ET 232, EM/ET 237, BCD 200, B 2213..
TS 15	22151401	For EM/ET 218
TS 15	22151501	For EM/ET 220, EM/ET 229-231, EM/ET 238, B 1808.., B 1813..
TS 15	22152301	For EM/ET 224, EM/ET 233-236, EM/ET 239-242, B 2617.., B 2613.., B 2736.. (crosswise)
TS 15	22152901	For EM/ET 247

Scope Of Delivery: 1 DIN rail



Euromas II

Accessories



DIN rail acc. to DIN EN 60715 G 32

Model	Order no.	Note
TS 32	22320701	For EM/ET 208-210, EM/ET 225, B 1008..
TS 32	22320901	For EM/ET 212
TS 32	22321101	For EM/ET 213, EM/ET 215-217, EM/ET 227, B 1408.., B 1413..
TS 32	22321901	For EM/ET 214, EM/ET 221-223, EM/ET 232, EM/ET 237, B 22130.
TS 32	22321401	For EM/ET 218
TS 32	22321501	For EM/ET 220, EM/ET 229-231, EM/ET 238, B 1808.., B 1813..
TS 32	22322301	For EM/ET 224, EM/ET 233-236, EM/ET 239-242, B 2617.., B 2613.., B 2736.. (crosswise)
TS 32	22322901	For EM/ET 247

Scope Of Delivery: 1 DIN rail



DIN rail acc. to DIN EN 60715 TH 35

Model	Order no.	Note
TS 35	22350701	For EM/ET 208-210, EM/ET 225, B 1008..
TS 35	22350901	For EM/ET 212
TS 35	22351101	For EM/ET 213, EM/ET 215-217, EM/ET 227, B 1408.., B 1413..
TS 35	22351901	For EM/ET 214, EM/ET 221-223, EM/ET 232, EM/ET 237, BCD 200, B 2213..
TS 35	22351401	For EM/ET 218
TS 35	22351501	For EM/ET 220, EM/ET 229-231, EM/ET 238, B 1808.., B 1813..
TS 35	22352301	For EM/ET 224, EM/ET 233-236, EM/ET 239-242, B 2617.., B 2613.., B 2736.. (crosswise)
TS 35	22352901	For EM/ET 247

Scope Of Delivery: 1 DIN rail



BOPLA

A Phoenix Mecano Company