

A : 11 mm Max

B :  $15 \pm 2$  mm

C : 7.5 mm Max

D :  $3.0 \pm 0.5$  mm

E :  $0.65 \pm 0.05$  mm

**1.DIMENSION (UNIT : mm):**

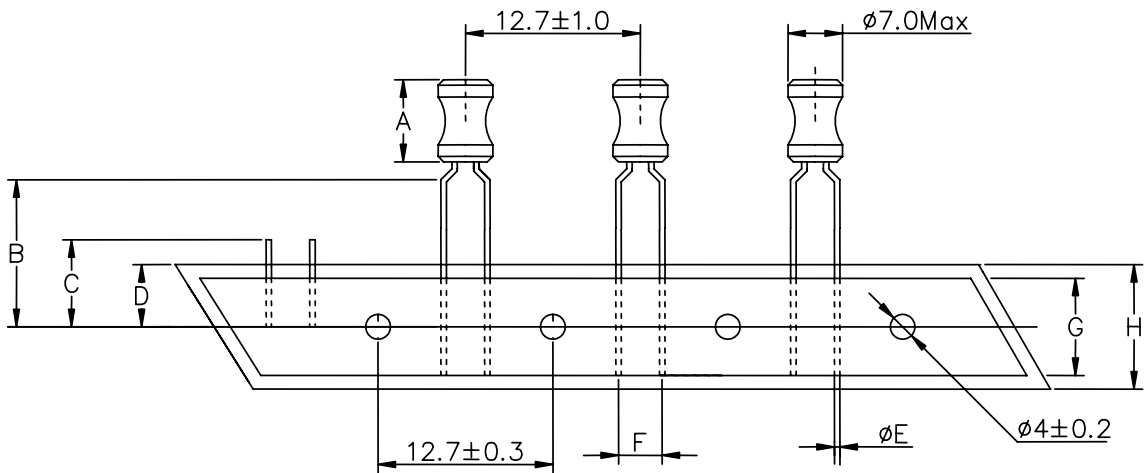

A: 12. Max.	B: $18.0 \pm 0.5$	C: 11.0 Max.	D: $9.0 \pm 0.5$	E: $0.65 \pm 0.05$
F: $5.0 + 0.8 / -0.5$	G: 12.5 Min.	H: $18.0 + 1.0 / -0.5$	I:	J:

