

TPYE 1

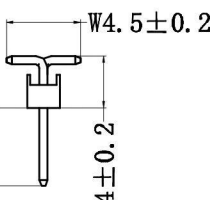

TPYE 1

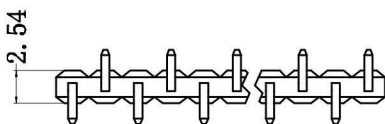

TPYE 2

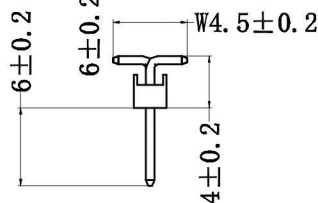

TPYE 2

SPECIFICATIONS

- Current Rating:3Amps
- Insulation Resistance:1000MΩ min
- Withstanding Voltage: 1000VAC
- Contact Resistance:20mΩ max
- Operating Temperture:-40° C to+105° C
- Standard:PA6T
- Contact Material:Brass
- Contact Plating:Au or Sn Over Ni
- Max.Processing Temp:260°Cfor10second
- Code Description
- CH-254-PH-1-XX-H-M-XXY-B**
- (1) (2) (3) (4) (5) (6) (7) (8)
- (1) Pin Spacing: 254=2.54mm
- (2) Product Name:PH=Pin Header
- (3) No.of Rows:1=Single 2=Dual Row
- (4) No.of Pins Per Row:2-40
- (5) Insulator Material Height:25=2.5mm
- (6) ContactType:S=Straight;R=Right/Angle;M=SMT
- (7) ContactPlating:SN=Tin;XXY=12Y, 14Y, 18Y, 20Y, 25Y, 30Y, 35Y;S0=Gold Flash/Tin
- (8) Insulator Material Option:
A=BK-PBT;B=BK-PA6T;C=BK-PA46;D=KB-LCP;S=Special



No. of	DIN. A	DIN. B	No. of	DIN. A	DIN. B	No. of	DIN. A	DIN. B	No. of	DIN. A	DIN. B
1	0.00	2.54	11	25.40	27.94	21	50.80	53.35	31	76.20	78.74
2	2.54	5.08	12	27.94	30.48	22	53.35	55.88	32	78.74	81.28
3	5.08	7.62	13	30.48	33.02	23	55.88	58.42	33	81.28	83.82
4	7.62	10.16	14	33.02	35.56	24	58.42	60.96	34	83.82	86.36
5	10.16	12.70	15	35.56	38.10	25	60.96	63.50	35	86.36	88.90
6	12.70	15.24	16	38.10	40.64	26	63.50	66.04	36	88.90	91.44
7	15.24	17.78	17	40.64	43.18	27	66.04	68.58	37	91.44	93.98
8	17.78	20.32	18	43.18	45.72	28	68.58	71.12	38	93.98	96.62
9	20.32	22.86	19	45.72	48.26	29	71.12	73.66	39	96.62	99.06
10	22.86	25.40	20	48.26	50.80	30	73.66	76.20	40	99.06	101.6

UNLESS OTHEWIXE SPECIFIED TOLERANCE
 X :±0.3 X° :±5°
 X.X :±0.2 X.X° :±1°
 X.XX :±0.2 X.XX° :±0.5°

DRAWM NAME: 254-PH-1-XX-M-XXY-B

SIZE	A4	SCALE	N:1	PROUCT	
REV	A	UNIT	mm	PROJECT	⊕ ⊖ PAGE 1/1

CHECKED	LIU SHENG HUI	DATE	05/28	CHECKED		DATE	/
---------	---------------	------	-------	---------	--	------	---