

Seria D DL4N

Shape And Dimensions

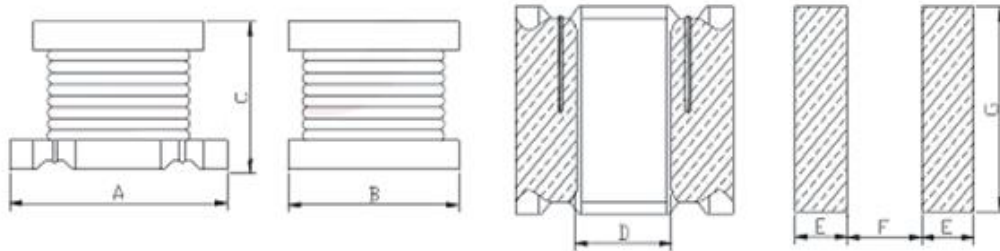

UNIT:mm	No Tube
A	4.5± 0.3
B	3.2± 0.3
C	2.6± 0.3
D	1.5REF
E	1.6REF
F	1.3REF
G	3.5REF

packaging requirement

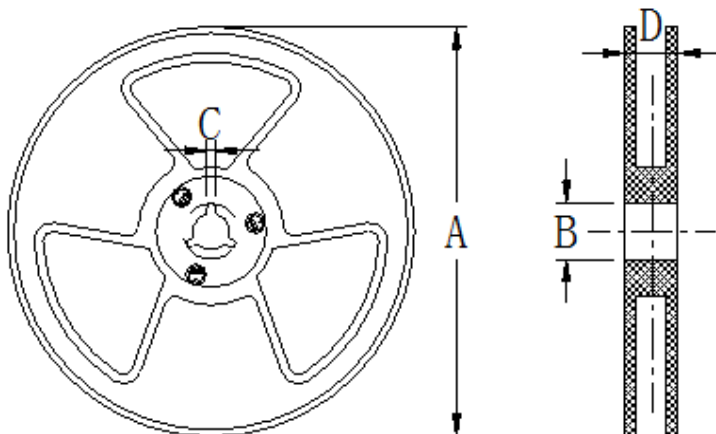

specifications	13"	7"
A	Φ 330±2.0	Φ 178±2.0
B	Φ 90 ± 2.0	
C	2.3	
D	21.5	

Welding temperature diagram

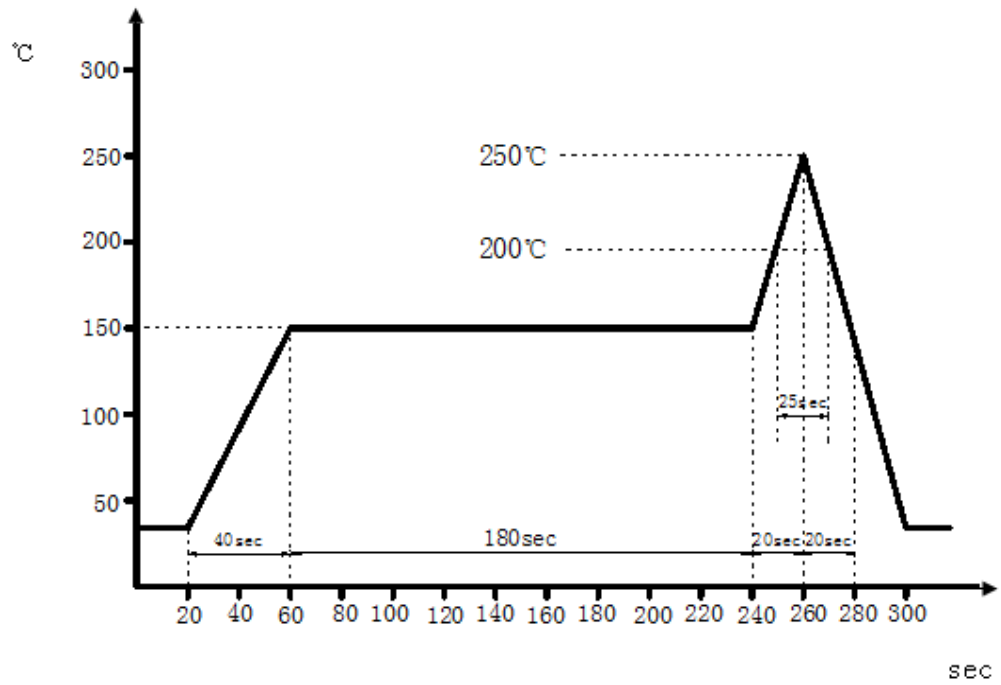

	NOMINAL INDUCTANCE (uH)	DCR (Ω)MAX	IDC (A)MAX
	1.0	84.5m	2.70
	2.2	107.9m	2.25
	2.7	127.4m	2.00
	3.3	143m	1.80
	3.9	149.5m	1.65
	4.7	182m	1.60
	5.6	214.5m	1.45
	6.8	204.1m	1.35
	8.2	273m	1.15
	10	286m	1.00
	12	325m	960m
	15	390m	900m
	18	442m	880m
	22	546m	860m
	27	728m	810m
	33	819m	770m
	39	1.08	680m
	47	1.25	590m
	56	1.30	500m
	68	1.56	440m
	82	1.95	390m
	100	2.21	360m
	120	2.47	330m
	150	2.95	290m
	180	3.08	270m
	220	3.51	235m
	270	4.98	210m
	330	5.90	180m
	390	8.23	170m
	470	8.84	160m
	560	9.88	145m
	680	11.7	130m
	820	13.0	115m
	1000	26.0	80m
ELECTREICAL SPECIFICATION	$L \leq 8.2UH$	TEST FREQ.	100KHZ/0.25V: (M± 20%)
	$L \geq 8.2UH$		1KHZ/0.25V:(K± 10%)
test equipment	HP4291B 502BC CH1062		