

# Rotary Switch

(TYPE): RTS-01-403-42RP

## (Specification)

1. (Rating): 16(4)A 125/250V AC
2. (Contact R): 20mΩ max
3. (Insulation R): 500V DC 100MΩ min
4. (Dielectric Strength): 1 Minute 1000V AC
5. (Operating Temperature): 0°C ~ +105°C
6. (Electrical Life): 10, 000 Cycles

## (Outline Drawing)

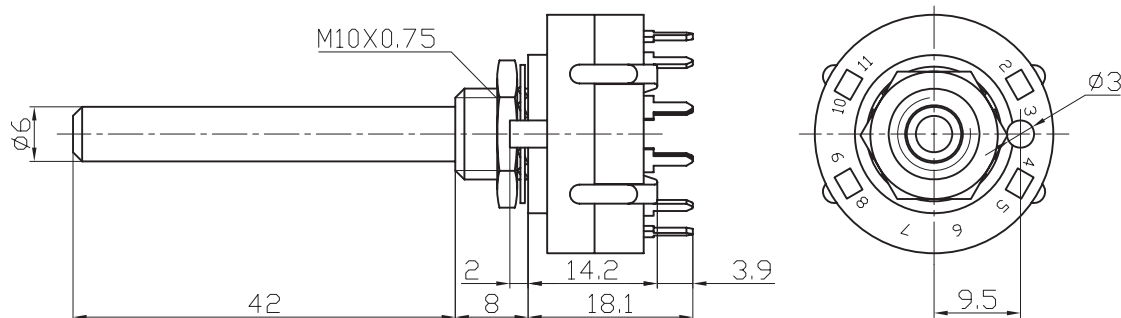

## (Mounting)

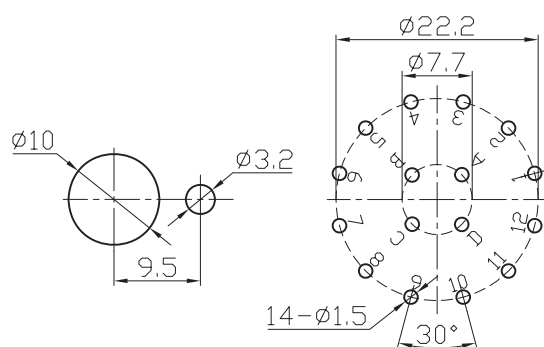

## (Circuitry)

