

RoHS

| REVISION DATE | | |
|---------------|-------------|------|
| ITEM | DESCRIPTION | DATE |
| A | Issue | |

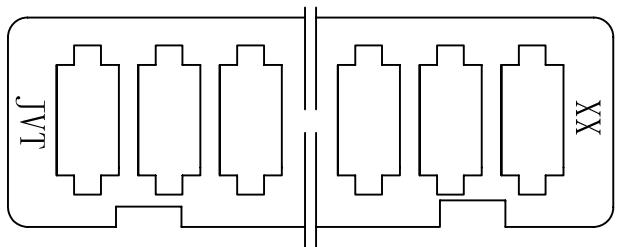
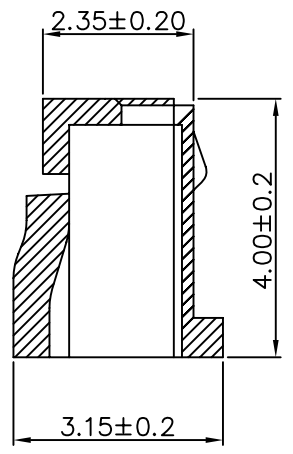
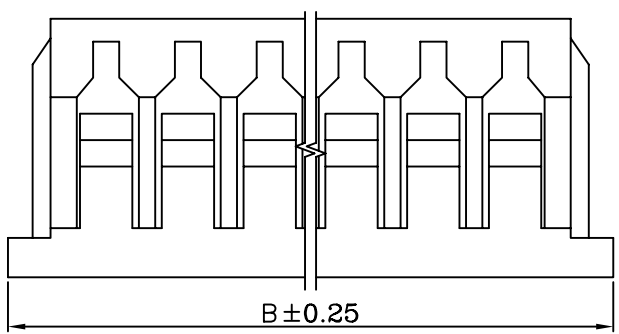
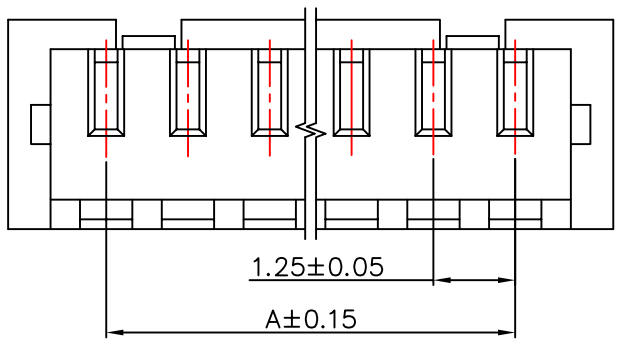

SPECIFICATION

- Voltage rating: AC, 250V, DC, 350V
- Current Rating: AC, DC, 3A
- Withstand voltage: 1000V AC/minute
- Insulation resistance: 1000MΩ/min
- Temperature range: -25° C ~ +85° C
(Including temperature rise in applying electrical current)
- Applicable PC board thickness: 0.063" (1.6mm)
- Contact resistance: Initial Value/30mΩ max after environmental testing/30mΩ max

HOUSING

- Part No: JVT1146HN2-XXN
- Poles: 02-16
- Material: PA66 UL94V-2/V-0
- Q'ty: 1000pcs/bag or 2000pcs/bag

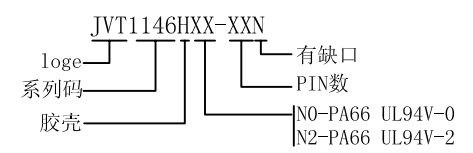

| Poles | Dimensions (mm) | | Poles | Dimensions (mm) | |
|-------|-----------------|-------|-------|-----------------|-------|
| | A | B | | A | B |
| 2 | 1.25 | 4.20 | 10 | 11.25 | 14.20 |
| 3 | 2.50 | 5.50 | 11 | 12.50 | 15.50 |
| 4 | 3.75 | 6.70 | 12 | 13.75 | 16.70 |
| 5 | 5.00 | 8.00 | 13 | 15.00 | 18.00 |
| 6 | 6.25 | 9.20 | 14 | 16.25 | 19.20 |
| 7 | 7.50 | 10.50 | 15 | 17.50 | 20.50 |
| 8 | 8.75 | 11.70 | 16 | 18.75 | 21.70 |
| 9 | 10.00 | 13.00 | | | |

| | | | |
|--------------|------------|----------------|--|
| 投影 (PROJECT) | | 公差 (TOLERANCE) | |
| 单位 (UNIT) | mm | 0 ±0.40 | |
| 比例 (SCALE) | FIT | 0.0 ±0.30 | |
| 版本 (EDITION) | A | 0.00 ±0.20 | |
| 日期 (DATE) | 2013 06 26 | 0.000 ±0.05 | |

东莞市乔业电子有限公司
DONG GUAN CHYAO YEE (JVT) CONNECTORS CO., LTD.

| | | | | | |
|--------------|------|--------------|--------------------|-----------|-----|
| 绘图 (DRAWN) | TONY | 品号 (PART NO) | JVT1146HXX-XX | 页次 (PAGE) | |
| 审核 (CHECKED) | CHEN | 图号 (DRAW NO) | 031-1146-02 | | 1/1 |
| 核准 (APPROVE) | | 品名 (NAME) | MLX1.25mm 公HSG 无缺口 | | |