

REV	DESCRIPTION	DRAWN	DATE

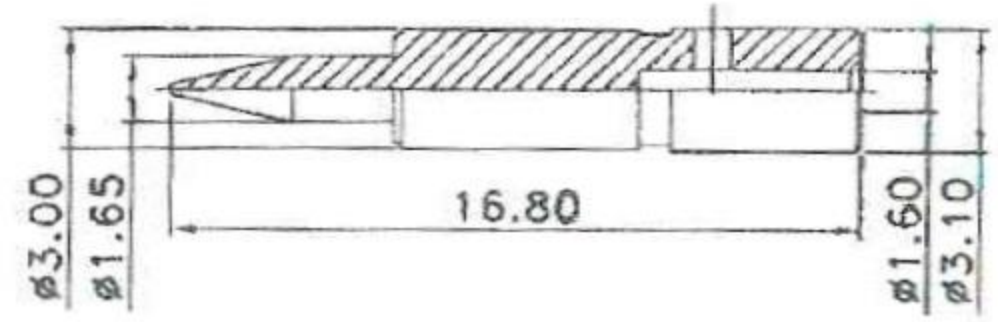
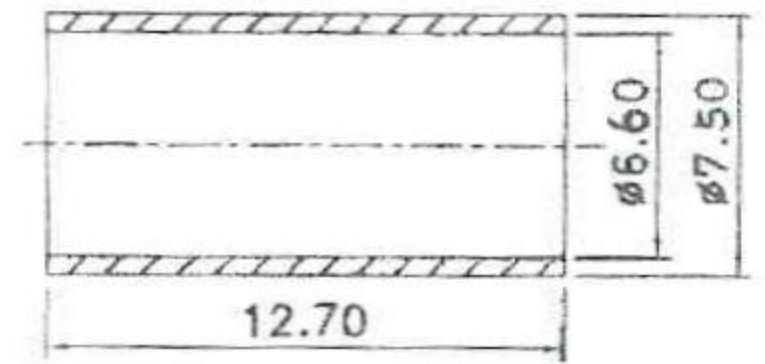
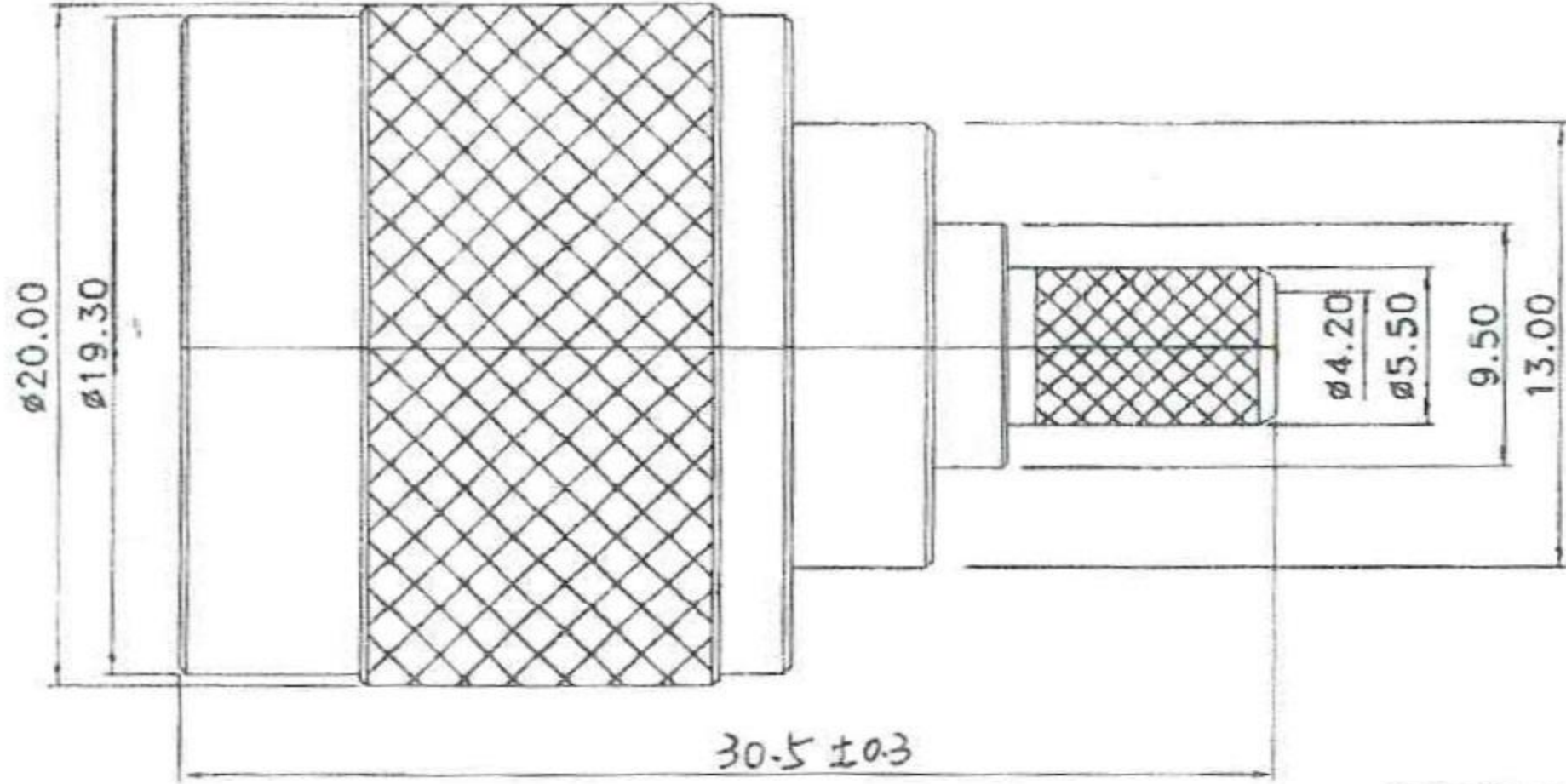

8	GASKET	1	SI-RUBBER	ORANGE
7	RETAINING RING	1	BRASS	
6	SHELL	1	BRASS	NICKEL
5	FERRULE	1	BRASS	NICKEL
4	DIELECTRIC	1		
3	DIELECTRIC	1	PTFE	NONE
2	PIN	1	BRASS	GOLD
1	BODY	1	BRASS	NICKEL

UNLESS OTHERWISE SPECIFIED
 1. REMOVE ALL BURRS.
 2. BREAK ALL CORNERS & EDGES TO 15 MAX.
 3. CHAMFER 1ST & LAST THREADS 45°.
 4. DIAMETERS ON COMMON CENTERS TO BE CONCENTRIC WITHIN 0.1 T.I.R.
 5. ALL DIMENSIONS ARE AFTER PLATING

MAJOR DIMENSION
 UNLESS OTHERWISE NOTED TOLERANCES
 0.5-6 = ±0.2
 6-30 = ±0.4
 30-120 = ±0.6
 120-315 = ±1.0
 ANGLES = ±1°



N102

TITLE
 N MALE CRIMP FOR LMR240

REV A

SCALE 4/1 UNIT MM DRAWN DATE 03/07/14 FILE NO.