

IP67

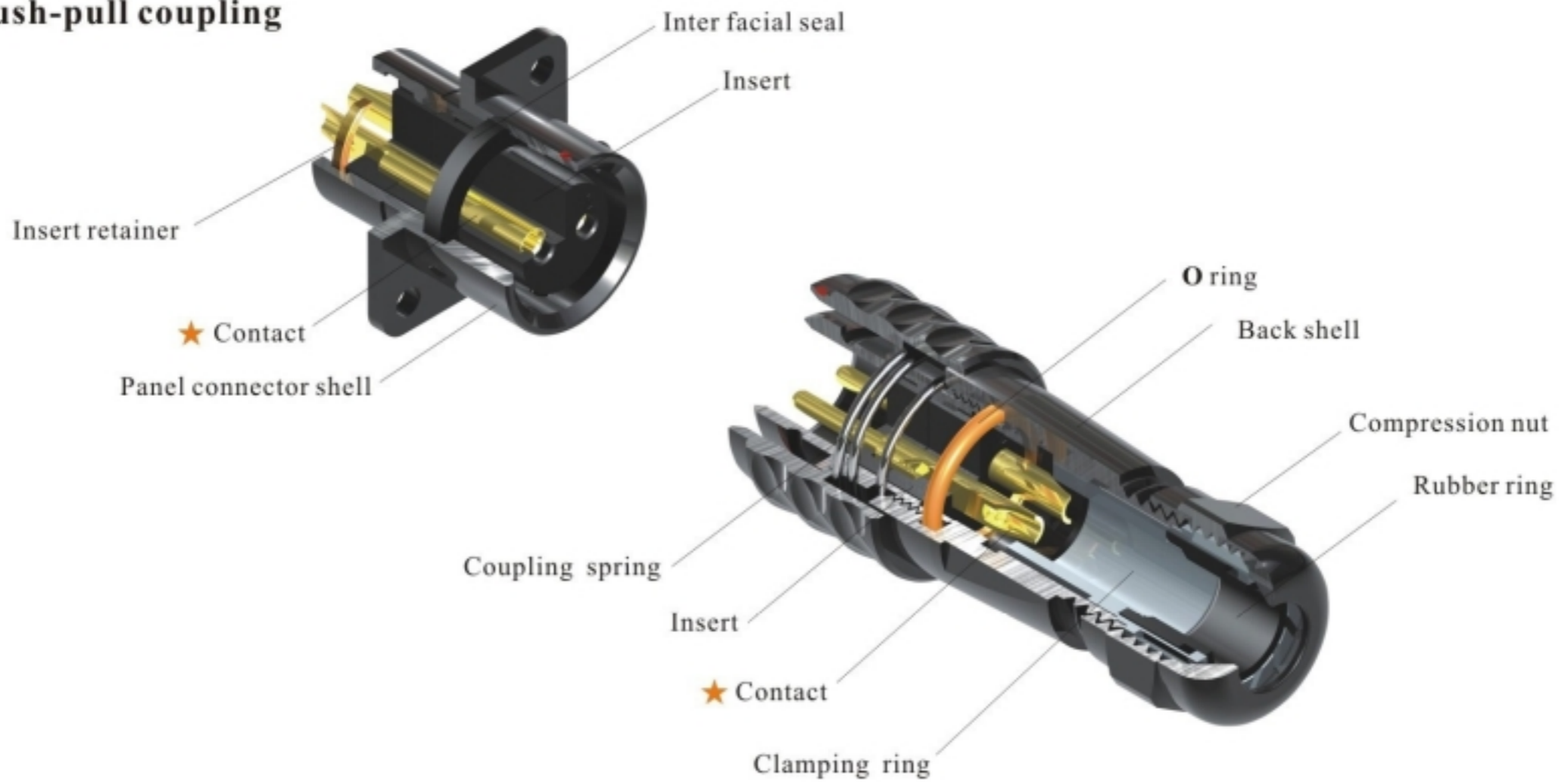

- SA Series IP67
- Push-pull coupling



★ Each side can be male or female contact

### Material and spec

Coupling	Push-pull
Shell material	Anodized aluminium
Insert material	PPS, max temperature 260 °C
Contact material	Brass with gold plating
Termination	Solder: SA10, SA12, SA16, SA20, SA28 Crimp: SA16, SA20, SA28 Screw: SA20, SA28 (∅2.5, ∅3.5mm contact)
IP rating	IP67
Mating cycle	500
Temperature range	-40°C~+85°C
Insulation resistance (MΩ)	2000



**SA28 Series**



**Cable connector**  
Mate with SA2811, SA2812, SA2813

SA2810/P — — — SA2810/S

Number of contact

Cable outer diameter: I: 13-16mm

1: solder, 2: screw, 3: crimp  
Colour:  
B: Black  
S: Silver  
L: Blue  
G: Green } special order  
R: Red

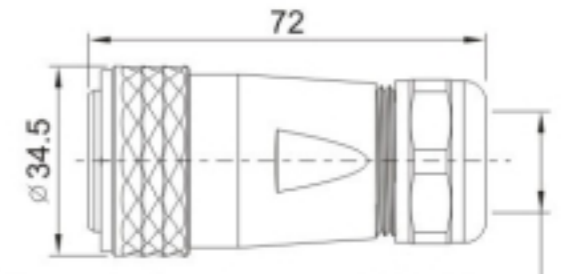

Cable outer diameter range: I: 13-16mm



**In-line cable connector**  
Mate with SA2810

SA2811/P — — — SA2811/S — — —

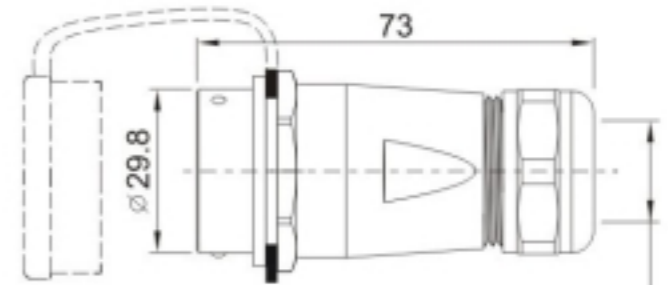

Cable outer diameter range: I: 13-16mm



**Rear-nut mount**  
Mate with SA2810

SA2812/P — — — SA2812/S — — —

Number of contact

1: solder, 2: screw, 3: crimp  
Colour:  
B: Black  
S: Silver  
L: Blue  
G: Green } special order  
R: Red

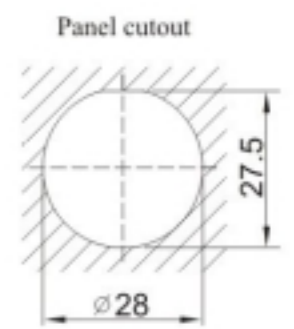
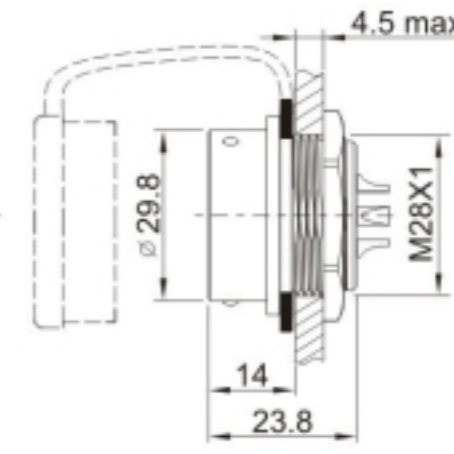

**Square flange**  
Mate with SA2810

SA2813/P — — — SA2813/S — — —

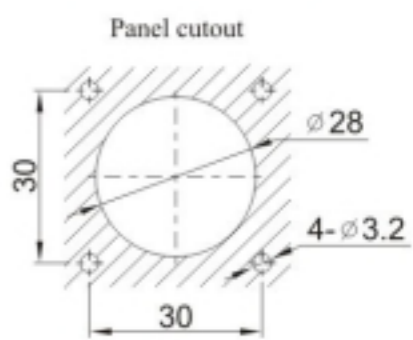
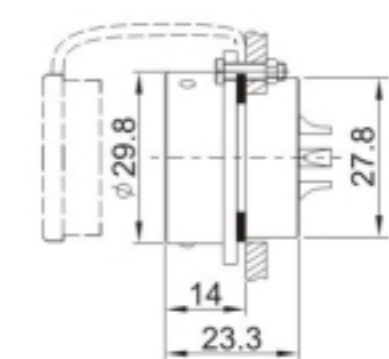
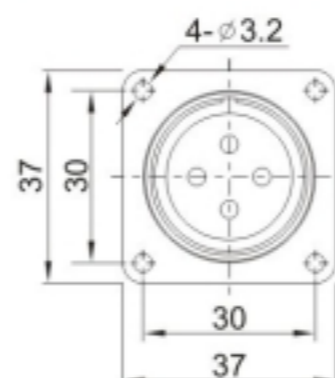

**Solder contact spec**

★ Crimp contact spec see page 77-80

Number of contact	2	3	4	7	8	9	10	10B	12	16	17	20	24	26
Male contact face view														
Rated current (A)	50	50	25	25	25	25 5	25	10	10	10	10	5	5	5
Contact diameter(mm)	3.5	3.5	2.5	2.5	2.5	2.5X4 1X5	2.5	1.5	1.5	1.5	1.5	1	1	1
Rated voltage (AC.V)	500	500	500	500	500	500	500	500	500	500	500	400	400	400
Test voltage(AC.V) 1 min	1500	1500	1500	1500	1500	1500	1500	1500	1500	1500	1500	1200	1200	1200
Contact resistance (mΩ)	0.5	0.5	1	1	1	1 5	1	2.5	2.5	2.5	2.5	5	5	5
Termination	solder / screw	solder / screw	solder / screw	solder / screw	solder / screw	solder / screw	solder / screw	solder	solder	solder	solder	solder	solder	solder
Wire size for solder (mm <sup>2</sup> / AWG)	≤10/7	≤10/7	≤4/11	≤4/11	≤4/11	≤4/11 ≤0.785/18	≤4/11	≤2/14	≤2/14	≤2/14	≤2/14	≤0.785/18	≤0.785/18	≤0.785/18
Wire size for screw termination (mm <sup>2</sup> / AWG)	≤6/10	≤6/10	≤1.5/15	≤1.5/15	≤1.5/15	/	≤1.5/15	/	/	/	/	/	/	/

## ● SA28 Series Mating diagram

**In-line cable connector**  
Mate with SA2810  
**SA2811/S** \_ \_ \_ \_



**Rear-nut mount**  
Mate with SA2810  
**SA2812/S** \_ \_ \_ \_



**Square flange**  
Mate with SA2810  
**SA2813/S** \_ \_ \_ \_



Number of contact | 1: solder, 2: screw, 3: crimp  
Colour:  
B: Black  
S: Silver  
L: Blue  
G: Green } special order  
R: Red

**Cable connector**  
Mate with SA2811, SA2812,  
SA2813



**SA2810/P** \_ \_ \_ \_  
Number of contact | 1: solder, 2: screw, 3: crimp  
Cable outer diameter: I:13-16mm  
Colour:  
B: Black  
S: Silver  
L: Blue  
G: Green } special order  
R: Red

**In-line cable connector**  
Mate with SA2810  
**SA2811/P** \_ \_ \_ \_



**Rear-nut mount**  
Mate with SA2810  
**SA2812/P** \_ \_ \_ \_



**Square flange**  
Mate with SA2810  
**SA2813/P** \_ \_ \_ \_



Number of contact | 1: solder, 2: screw, 3: crimp  
Colour:  
B: Black  
S: Silver  
L: Blue  
G: Green } special order  
R: Red

**Cable connector**  
Mate with SA2811, SA2812,  
SA2813



**SA2810/S** \_ \_ \_ \_  
Number of contact | 1: solder, 2: screw, 3: crimp  
Cable outer diameter: I:13-16mm  
Colour:  
B: Black  
S: Silver  
L: Blue  
G: Green } special order  
R: Red

### Application

#### SA28

This state of the art, miniature IP67 waterproof connector is designed for any high-end products need a high-end connector to match with, such as medical devices, high-end equipments, testing or measuring equipments, communications, marine equipment etc., for data and power.