

**Material :**

- (a) Housing : PA6T+GF(UL94V-0)
- (b) Pin Header : Brass , Tin Plated

**Electrical :**

- 1.Rated Voltage : UL 300V IEC 250V
- 2.Rated Current : 10A 12A
- 3.Reflow Soldering
- 4.Soldering Temperature : 265 °C±10°C/5 Sec
- 5.Operating Temperature : -40 °C~+105°C
- 6.RoHS Compliance
- 7.Safety Approval :
- 8.Undimensioned Tolerances:

Pitch Range In mm			Nominal Dimension Range In mm					-	∩	□
≤6	6 ~ 10	10 ~ 24	≤30	30 ~ 60	60 ~ 100	100 ~ 150	>150	0.05/10		
±0.10	±0.15	±0.25	±0.20	±0.30	±0.50	±0.70	±1.00	±0.1°		

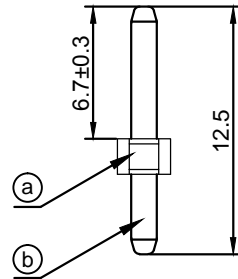

GT332J - 5.0 - XXP - X X - 00 AH

①      ②      ③      ④   ⑤      ⑥      ⑦

- ① Series No.
- ② Pitch
- ③ Poles  
02 02Contacts  
03 03Contacts  
...  
24 24Contacts
- ④ 1 Single Pitch  
2 Double Pitch
- ⑤ Color: 1 Grey  
2 Blue  
3 Black(Standard For AH)  
4 Green  
5 Orange  
6 Red  
7 Transparent  
8 Yellow  
9 White
- ⑥ Customer Request : 00--Standard
- ⑦ AH--Standard(PA6T+GF)

DETACHED LISTS	<b>Grolten</b> 宁波冠泰电子有限公司 NINGBO GOLTEN ELECTRONICS CO., LTD.	
	APPD: MA_8/13/16'	PART NO. GT332J-5.0-XXP-XX-00AH
	CHKD: Yu_8/12/16'	
	DRFT: Chen_8/11/16'	
	THIRD ANGLE PROJECTION	
	MM (INCH)	DO NOT SCALE DRAWING

H  
G  
F  
E  
D  
C  
B  
A