

# FULLY INSULATED FEMALE QUICK DISCONNECTS

- Material
- Insulation: Vinyl
- Terminal Body: Brass
- Plating: Tin

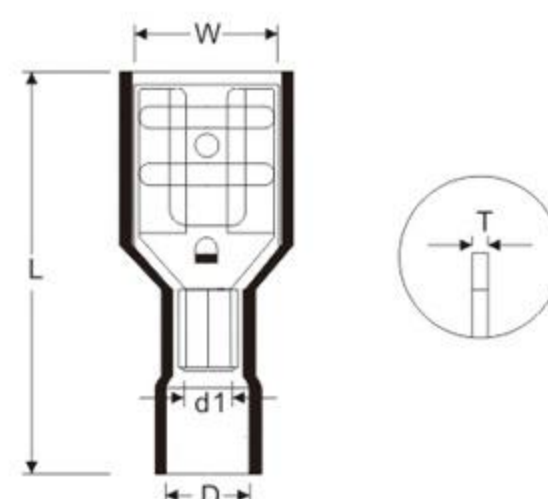

| ITEM NO.         | Name Tab | DIMENSIONS |      |     |     |     | COLOR  | EXPLANATION   |
|------------------|----------|------------|------|-----|-----|-----|--------|---|
|                  |          | W          | L    | d1  | D   | T   |        |   |
| FDFD 1.25-110(5) | 0.5×2.8  | 3.8        | 19.0 | 1.7 | 3.7 | 0.3 | RED    | PVC<br>75°C<br>Wire range : 0.5-1.5mm <sup>2</sup><br>A.W.G.:(22-16)<br>Max.current=10A |
| FDFD 1.25-110(8) | 0.8×2.8  |            |      |     |     |     |        |   |
| FDFD 1.25-187(5) | 0.5×4.75 | 5.8        | 20.0 |     |     |     |        |   |
| FDFD 1.25-187(8) | 0.8×4.75 |            |      |     |     |     |        |   |
| FDFD 1.25-205(5) | 0.5×5.2  | 6.5        | 20.0 |     |     |     |        |   |
| FDFD 1.25-205(8) | 0.8×5.2  |            |      |     |     |     |        |   |
| FDFD 1.25-250    | 0.8×6.35 | 7.5        | 21.5 | 0.4 |     |     |        |   |
| FDFD 2-110(5)    | 0.5×2.8  | 3.8        | 19.0 | 2.3 | 4.2 | 0.3 | BLUE   | PVC<br>75°C<br>Wire range : 1.5-2.5mm <sup>2</sup><br>A.W.G.:(16-14)<br>Max.current=15A |
| FDFD 2-110(8)    | 0.8×2.8  |            |      |     |     |     |        |   |
| FDFD 2-187(5)    | 0.5×4.75 | 5.8        | 20.0 |     |     |     |        |   |
| FDFD 2-187(8)    | 0.8×4.75 |            |      |     |     |     |        |   |
| FDFD 2-205(5)    | 0.5×5.2  | 6.5        | 20.0 |     |     |     |        |   |
| FDFD 2-205(8)    | 0.8×5.2  |            |      |     |     |     |        |   |
| FDFD 2-250       | 0.8×6.35 | 7.5        | 21.5 | 0.4 |     |     |        |   |
| FDFD 5.5-250     | 0.8×6.35 | 7.5        | 25.0 | 3.4 | 5.6 | 0.4 | YELLOW | PVC<br>75°C<br>Wire range : 4-6mm <sup>2</sup><br>A.W.G.:(12-10)<br>Max.current=24A     |

