

Battery Holder BH800 for Coin Type Lithium Battery

- *The battery is solidly anchored in the holder
- *Battery can be charged very easily and you are assured of reliable firm contact
- *There is no battery damage from short circuiting or soldering.
- *BH800 battery holder for CR and LIR series 2032 to 2025, 2016.

Battery Holder Dimension (Unit: mm)

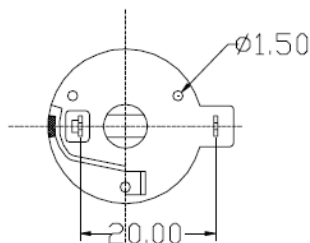
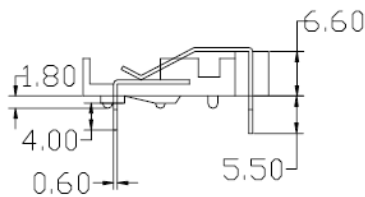
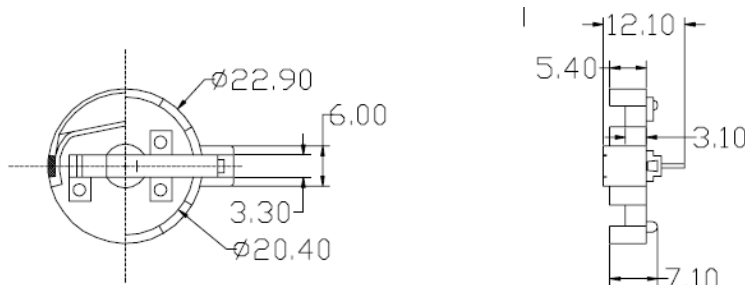

NOTE:

1.MATERIAL:

a.HOUSING:PA BK VD GF30.15

b.CONTACT:C2680

(SURFACE PLATING:Sn 10 μ)

2.ELECTRIC:

a.CONTACT RESISTANCE:30 MILLIOHMS MAX

b.INSULATION RESISTANCE: 1000 MEGA OHMS MIN

c.DIELECTNIC VOLTAGE: 500V AC ONE SEC LEVEL

d.OPERATING TEMPERATURE: -55°C TO 105°C

TOLERANCE	
LINEAR	ANGLE
x. ± 1	x. $^{\circ}$ $\pm 5^{\circ}$
.x ± 0.35	.x. $^{\circ}$ $\pm 2^{\circ}$
.xx ± 0.20	.xx. $^{\circ}$ $\pm 1^{\circ}$
.xxx ± 0.10	