

AVAILABLE ON TAPE AND REEL

- Manufactured using flat wire to provide a large mounting surface area
- Efficient, safe, board level testing
- Simplifies testing on dense circuit boards
- Compatible with vacuum and mechanical pick & place assembly systems
- All conductive polystyrene carrier tape meets ANSI/EIA-481 standards

Operational Temperature: -50°F to 185°F (-45°C to 85°C)

- Ideal for use with miniature probes, clips and hooks
- Ultra low profile, ideal for advanced surface mount PCB applications

### MICRO MINIATURE

#### SPECIFICATIONS

##### Material:

.010 (.25) Phosphor Bronze

CAT. NO.	Finish	Pieces Per Reel
5015	SILVER PLATE	1000
5084	MATTE-TIN PLATE	1000
5017	SILVER PLATE	5000
5085	MATTE-TIN PLATE	5000

Tape & Reel Spec's: 8mm Wide, 4mm Pitch

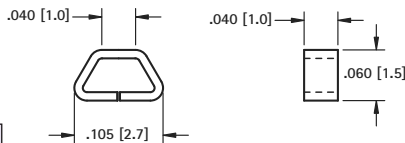

#### Pad Layout

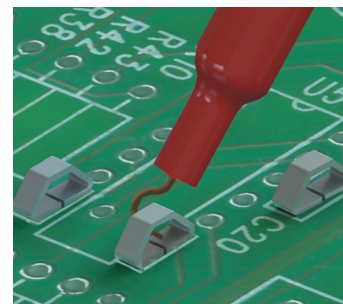
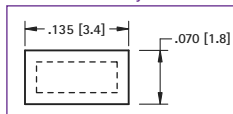

- Ideal for use with most standard probes, clips and hooks
- Unique design provides exceptional strength and durability

### MINIATURE

#### SPECIFICATIONS

##### Material:

.015 (.38) Phosphor Bronze, Silver Plate

CAT. NO. 5019 - 1000 pieces per reel    CAT. NO. 5029 - 5000 pieces per reel

Tape & Reel Spec's: 12mm Wide, 4mm Pitch

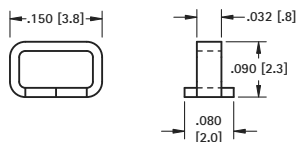

#### Pad Layout

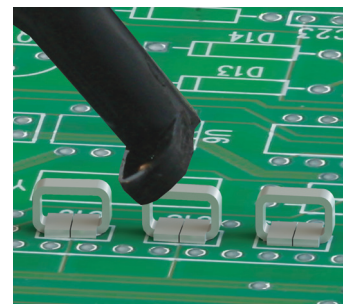
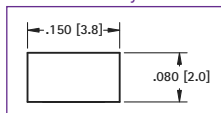

- Ideal for use with most standard probes, clips and hooks
- Color keyed for visibility and quick identification

### COLOR KEYED

#### MATERIAL

Terminal: .008 (.20) Phosphor Bronze, Silver Plate

Base: LCP UL Rated 94V-0

CAT. NO.	Base Color	CAT. NO.	Base Color
5190TR	RED	5195TR	BROWN
5191TR	BLACK	5196TR	GREEN
5192TR	WHITE	5197TR	BLUE
5193TR	ORANGE	5198TR	GREY
5194TR	YELLOW	5199TR	PURPLE

Tape & Reel Spec's: 12mm Wide, 4mm Pitch, 1,000 pieces per 7" reel

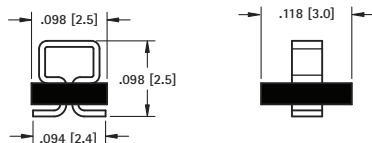

#### Pad Layout

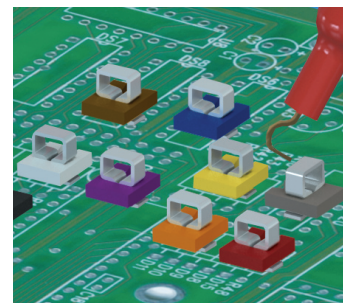
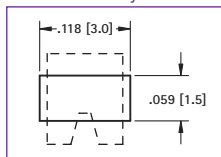

- Ideal for use with standard probes, clips and hooks
- Unique design provides exceptional strength and durability

### COMPACT

#### SPECIFICATIONS

##### Material:

.015 (.38) Phosphor Bronze, Silver Plate

CAT. NO.	Finish	Pieces Per Reel
5016	SILVER PLATE	1000
5091	MATTE TIN PLATE	1000
5018	SILVER PLATE	5000
5095	MATTE TIN PLATE	5000

Tape & Reel Spec's: 12mm Wide, 4mm Pitch

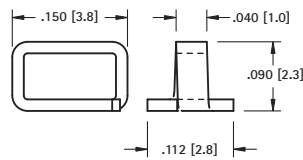

#### Pad Layout

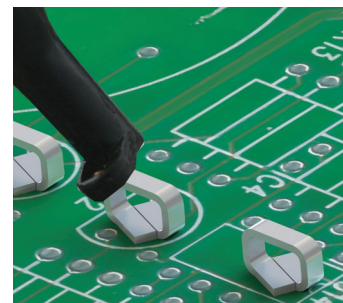
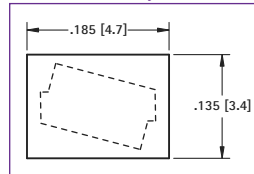

- Locating Pin provides positive location during assembly process
- Increased solder strength
- Can be used as a SMT test point or when used with a .032 [.81] board, as a THM test point

### HYBRID MOUNT

#### SPECIFICATIONS

##### Material:

.010 (.25) Phosphor Bronze, Silver Plate

CAT. NO. 5027 - 800 pieces per reel

Tape & Reel Spec's: 12mm Wide, 4mm Pitch

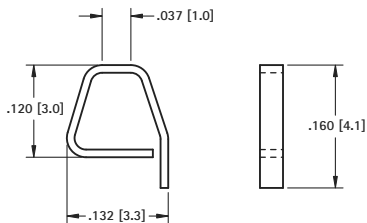

#### Pad Layout

