



YETDA INDUSTRY LTD.

Technical Data Sheet

MODEL NO : Q196Y4-585nm

Package: 1.6*08*0.6mm LED

Features : <ul style="list-style-type: none"> ● Package in 8mm tape on 7" diameter reel ● Compatible with automatic placement equipment ● Compatible with reflow solder process Applications : <ul style="list-style-type: none"> ● Optical Indicator ● Indoor Display ● Automotive Lighting ● Backlight for LCD, Display ● Tubular Light Application 	Features <ul style="list-style-type: none"> ■ High lumen output and efficacy ■ Uses the eutectic technology, with low thermal resistance and high reliability characteristics. ■ Suitable for different working environment
---	--

Dice material	Emitted color	Lens Color
AlGaInP	Yellow	Water Clear

Electrical/Optical Characteristics(Ta=25°C)

Parameter	Test Condition	Symbol	Value			Unit
			Min	Typ	Max	
Dominant wavelength	I _F =20mA	WD	584		590	nm
Forward voltage	I _F =20mA	V _F	1.8		2.4	V
Luminous intensity	I _F =20mA	I _v	120		180	mcd
Reverse current	V _R =5V	I _R			10	μA
Viewing angle at 50% I _v	I _F =20mA	2θ 1/2		120		Deg

Absolute Maximum Ratings(Ta=25°C)

Parameter	Symbol	Value	Unit
Power dissipation	P _d	72	mW
Forward current	I _F	20	mA
Reverse voltage	V _R	5	V
Operating temperature range	T _{op}	-20 ~+80	°C
Storage temperature range	T _{stg}	-40 ~+85	°C
Peak pulsing current (1/8 duty f=1kHz)	I _{FP}	125	mA



YETDA INDUSTRY LTD.

PACKAGING DIMENSIONS (mm):

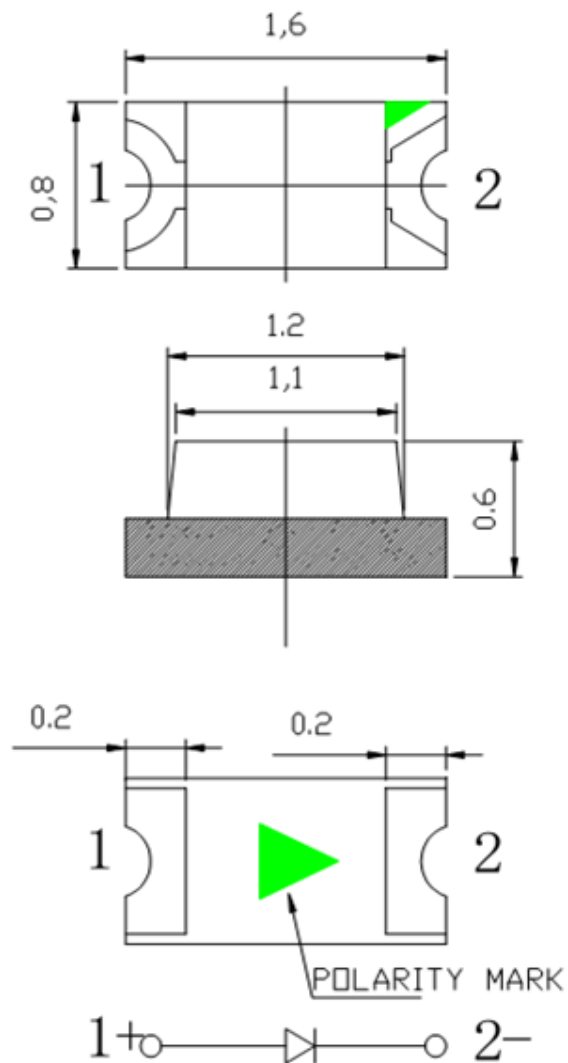

Notes: (备注)

1. All dimension units are millimeters. (所有标注尺寸单位为毫米)

2. All dimension tolerance is $\pm 0.15\text{mm}$ unless otherwise noted. (除特别标注外, 所有尺寸允许公差 $\pm 0.15\text{mm}$)



YETDA INDUSTRY LTD.

Typical optical characteristics curves 典型光学特性曲线

Ambient Temperature vs. Forward Current 环境温度与正向电流特性曲线		Forward Current VS. Relative Intensity 正向电流与相对光强特性曲线	
Forward Current(mA)			Relative luminous Intensity
	Soldering Temperature °C		
Forward Voltage VS. Forward Current 正向电压与正向电流特性曲线		Ambient Temperature VS. Relative Intensity 环境温度与相对光强特性曲线	
Forward Current(mA)			Relative luminous Intensity
	Forward Voltage(V)		
Relative spectral emission 相对光谱分布特性曲线		Radiation diagram 辐射图特性曲线	
Relative luminous intensity			
	Wavelength(nm)		

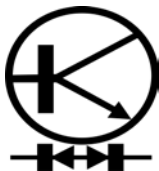

YETDA INDUSTRY LTD.

Precautions For Use :
Over - current - proof
Customer must apply resistors for protection, otherwise slight voltage shift will cause big current change (Burn out will happen)
Storage
1. The operation of temperature and R.H. are : $5^{\circ}\text{C} \sim 30^{\circ}\text{C}$, 60%R.H. Max.
2. Once the package is opened, the products should be used within a week. Otherwise, they should be kept in a dampproof box with desiccating regent. Considering the tape life, we suggest our customers to use our products within 1.5 year (from production date) .
3. It's recommended to bake before soldering when the package is unsealed after 72 hrs. The condition is : $60^{\circ}\text{C} \pm 5^{\circ}\text{C}$ for 15hrs.

■ Reflow Temp/Time

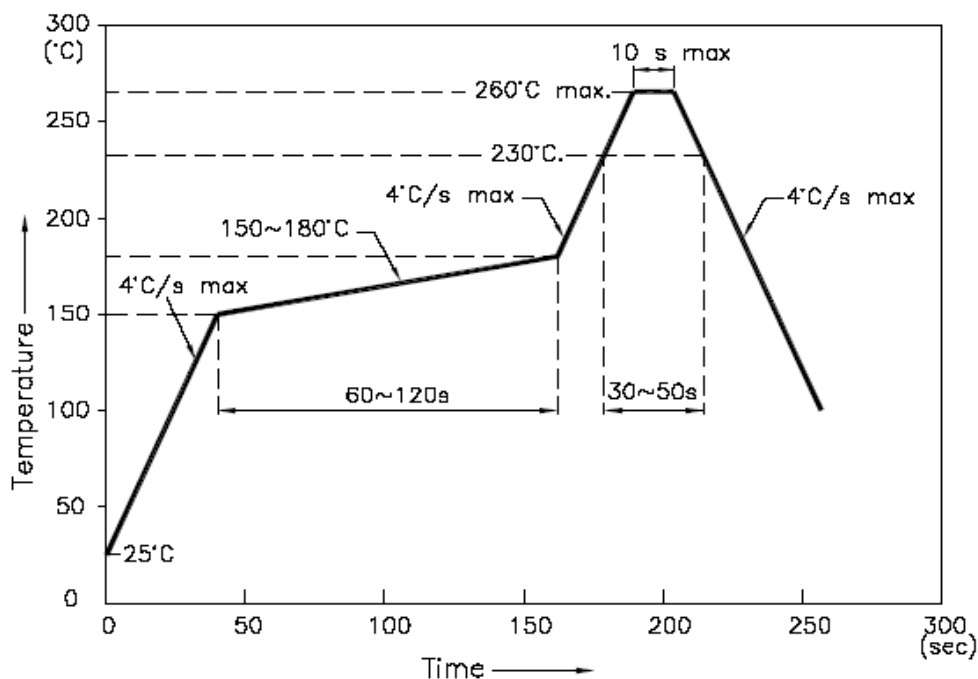

NOTES:

1. We recommend the reflow temperature $245^{\circ}\text{C} (\pm 5^{\circ}\text{C})$. the maximum soldering temperature should be limited to 260°C .
2. dont cause stress to the epoxy resin while it is exposed to high temperature.
3. Number of reflow process shall be 2 times or less.



YETDA INDUSTRY LTD.

■Soldering iron

Basic spec is $\leq 5\text{sec}$ when 260°C . If temperature is higher, time should be shorter ($+10^{\circ}\text{C} \rightarrow -1\text{sec}$). Power dissipation of iron should be smaller than 20W, and temperatures should be controllable. Surface temperature of the device should be under 230°C .

■Rework

1. Customer must finish rework within 5 sec under 260°C .
2. The head of iron can not touch copper foil
3. Twin-head type is preferred.

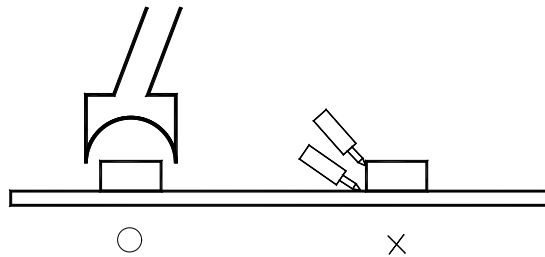

- Avoid rubbing or scraping the resin by any object, during high temperature, for example reflow 、 solder etc.