

PNP General Purpose Amplifier

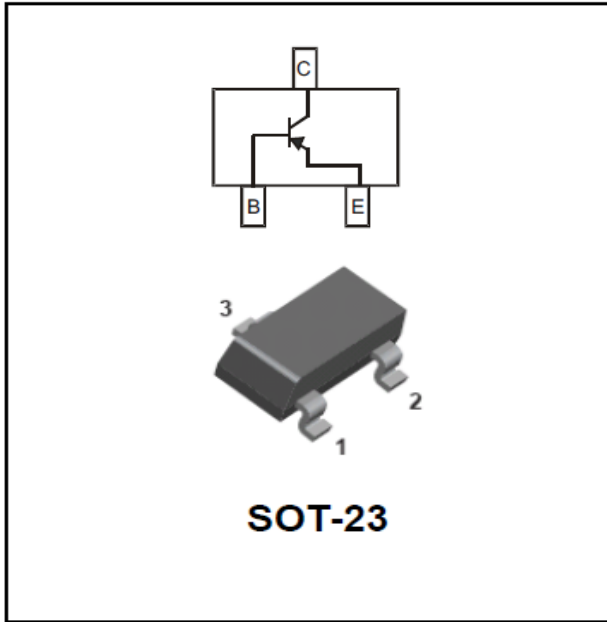

Features

- Epoxy meets UL-94 V-0 flammability rating
- Halogen free available upon request by adding suffix "HF"
- Moisture Sensitivity Level 1
- Marking:

SS8550-L	Y2 • L
SS8550-H	Y2

■ Off Characteristics

Item	Symbol	Unit	Conditions	Value
Collector-Emitter Voltage	V_{CEO}	V	$I_C = -100\mu\text{A}$, $I_B = 0$	-25
Collector-Base Voltage	V_{CBO}	V	$I_C = -100\mu\text{A}$, $I_E = 0$	-40
Emitter-Base Voltage	V_{EBO}	V	$I_E = -100\mu\text{A}$, $I_C = 0$	-5.0
Collector Current	I_C	A		-1.5
Collector-Emmitter Cut-off Current	I_{CEO}	nA	$V_{CE} = -20\text{Vdc}$	-100
Collector-Base Cut-off Current	I_{CBO}	nA	$V_{CB} = -40\text{Vdc}$	-100
Emitter-Base cut-off current	I_{EBO}	nA	$V_{EB} = -5.0\text{Vdc}$	-100
Collector Power Dissipation	P_C	mW		300
Operation Junction Temperature	T_j	°C		-55 to +150
Storage Temperature	T_{stg}	°C		-55 to +150

SS8550-L THRU SS8550-H

■ On Characteristics

Item	Symbol	Unit	Conditions	Min	Max
DC Current Gain	h_{FE}		$I_C = -100\text{mA}$ $V_{CE} = -1.0\text{Vdc}$	120	350
			$I_C = -800\text{mA}$ $V_{CE} = -1.0\text{Vdc}$	40	
Collector-Emitter Saturation Voltage	$V_{CE(sat)}$	Vdc	$I_C = -800\text{mA}$ $I_B = -80\text{mA}$		-0.5
Base-Emitter Saturation Voltage	$V_{BE(sat)}$	Vdc	$I_C = -800\text{mA}$ $I_B = -80\text{mA}$		-1.2

■ Small-signal Characteristics

Item	Symbol	Unit	Conditions	Min	Max
Transition frequency	f_T	MHz	$I_C = -50\text{mA}$ dc, $V_{CE} = -10\text{Vdc}$, $f = 30\text{MHz}$	100	

■ Classification Of h_{fe} (1)

Rank	L	H
Range	120-200	200-350

■ Ordering Information (Example)

PREFERRED P/N	PACKING CODE	UNIT WEIGHT(g)	MINIMUM PACKAGE(pcs)	INNER BOX QUANTITY(pcs)	OUTER CARTON QUANTITY(pcs)	DELIVERY MODE
SS8550	F2	Approximate 0.008	3000	30000	120000	7" reel

SS8550-L THRU SS8550-H

■ Characteristics (Typical)

Static Characteristic

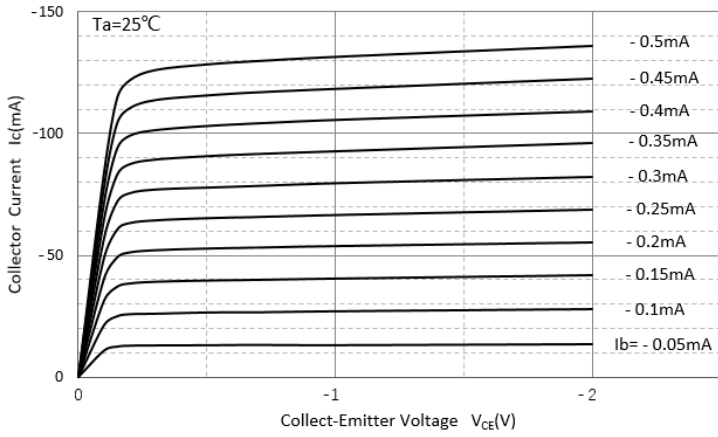

DC Current Gain

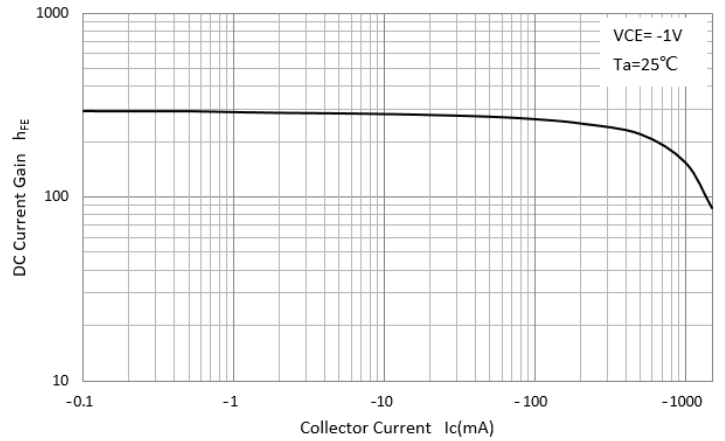

Collector-Emittor Saturation Voltage

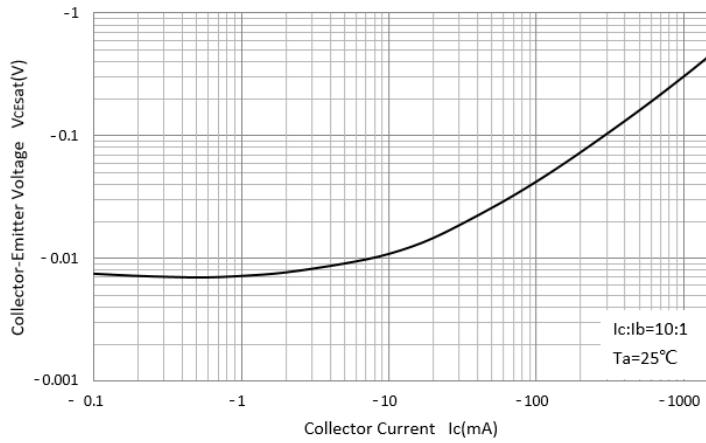

Base-Emittor Saturation Voltage

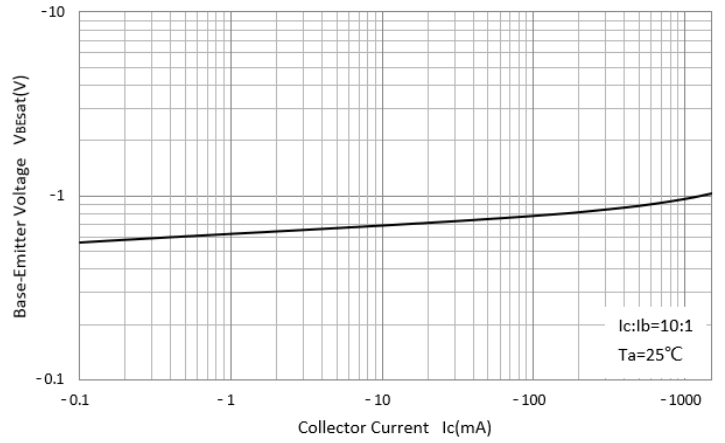

Base-Emittor On Voltage

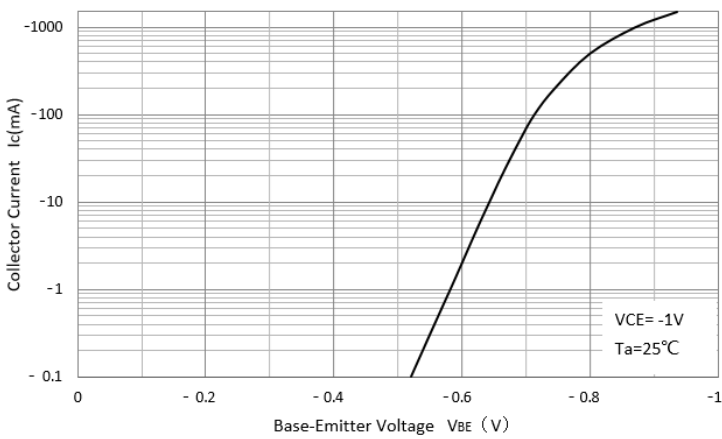

$C_{ob}/C_{ib}-V_{CB}/V_{EB}$

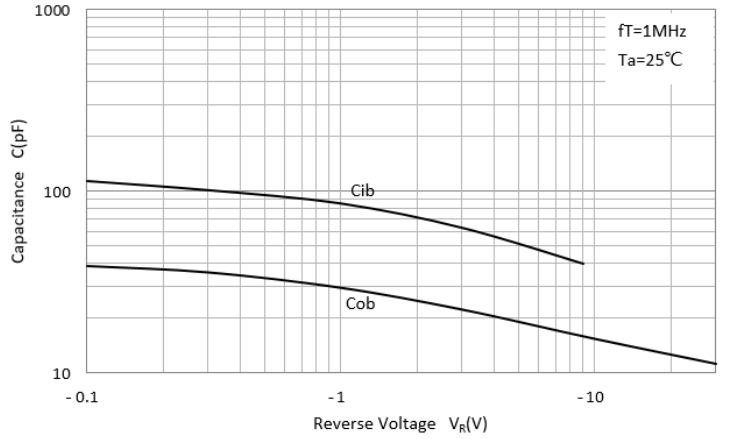

SS8550-L THRU SS8550-H

■SOT-23 Package Outline Dimensions

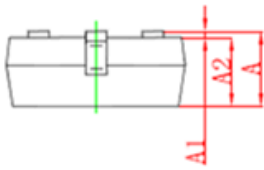
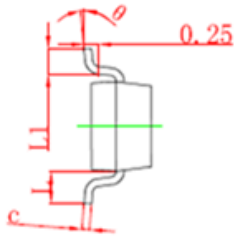
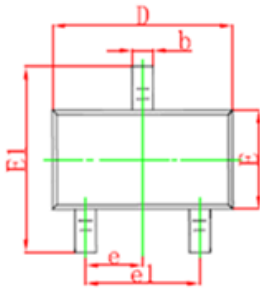

Symbol	Dimensions In Millimeters		Dimensions In Inches	
	Min	Max	Min	Max
A	0.900	1.150	0.035	0.045
A1	0.000	0.100	0.000	0.004
A2	0.900	1.050	0.035	0.041
b	0.300	0.500	0.012	0.020
c	0.100	0.200	0.004	0.008
D	2.800	3.000	0.110	0.118
E	1.200	1.400	0.047	0.055
E1	2.250	2.550	0.089	0.100
e	0.950TYP		0.037TYP	
e1	1.800	2.000	0.071	0.079
L	0.550REF		0.022REF	
L1	0.300	0.500	0.012	0.020
θ	0°	8°	0°	8°

■SOT-23 Soldering Footprint