

Specification Sheet

Max Interrupt Voltage: 130 Vac
 Max Operating Voltage: 60 Vdc
 Maximum Interrupt Current: 20 A

Insulating Material:
 meets UL94 V-0 Requirements

Lead-free, RoHS compliant

Lead Material:
 Tin plated copper, 0.5 Dia.

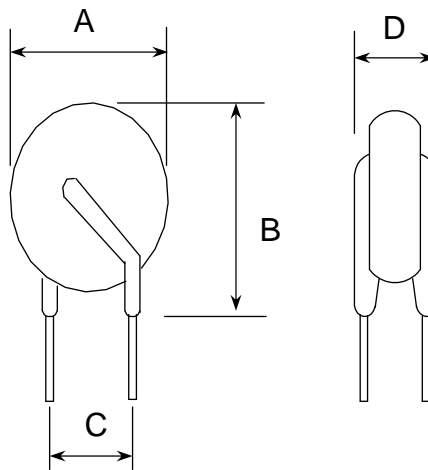

F2

TABLE I. DIMENSIONS:

	A	B	C	D	LEAD
	MAX	MAX	TYP	MAX	TYP
mm	9.9	12.5	5.1±0.5	3.8	F2

TABLE II. PERFORMANCE RATINGS:

Model	V_{max} (Vac)	I_{max} (A)	I_{hold} @25°C (A)	I_{trip} @25°C (A)	Maximum Time To Trip		Resistance	
					Current (A)	Time (Sec)	Ri min (Ω)	Ri max (Ω)
Bp160-130	130	20	0.16	0.32	0.48	15.0	3.50	7.00