

# Specification Sheet

Max Interrupt Voltage: 130 Vac  
 Max Operating Voltage: 60 Vdc  
 Maximum Interrupt Current: 10 A

Insulating Material:  
 meets UL94 V-0 Requirements

Lead-free, RoHS compliant

Lead Material:  
 Tin plated copper, 0.8 Dia.

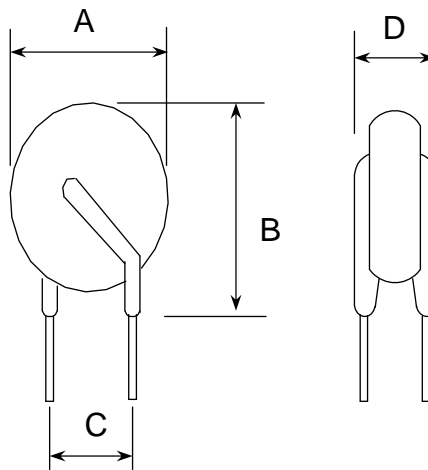

F2

TABLE I. DIMENSIONS:

	A	B	C	D	LEAD
	MAX	MAX	TYP	MAX	TYP
mm	13.2	16.2	5.1±0.5	3.8	F2

TABLE II. PERFORMANCE RATINGS:

Model	V <sub>max</sub> (Vac)	I <sub>max</sub> (A)	I <sub>hold</sub> @25°C (A)	I <sub>trip</sub> @25°C (A)	Maximum Time To Trip		Resistance	
					Current (A)	Time (Sec)	Ri min (Ω)	Ri max (Ω)
BpA01.10-130	130	10	1.10	2.20	3.30	15.0	0.15	0.50