

Description

- Metalized drum core design utilizes board space
- Current Range up to 4.94 Amps
- Low profile 4.80mm Max (H).

Applications

- Mainly used by power supply for VRT,OA equipment
- Digital camera, LCD television set notebook PC,
- part able communication equipments, DC/DC converters, etc.

Environmental Data

- Storage temperature: -25°C to +85°C
- Operating ambient temperature: -20°C to +80°C (Range is application specific).
- Temperature rise is approximately 40°C at rated I_{rms} current.
- Solder reflow temperature: 260°C max. for 10 seconds max.
- Compliant with RoHS legislation and also support lead-free soldering

Mechanical Diagrams (Unit:mm)

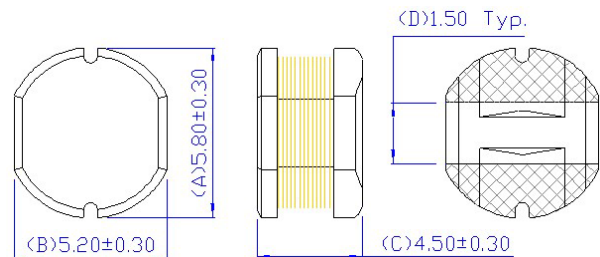

| Part No. | Inductance ⁽¹⁾ (μH) | DC Resistance ⁽²⁾ (Ω) Max | Isat ⁽³⁾ A dc Max | I _{rms} ⁽⁴⁾ (A dc) Max |
|-----------------|-----------------------------------|---|---------------------------------|---|
| D DLG0504-001.0 | 1.0±20% | 0.009 | 4.94 | 4.59 |
| D DLG0504-001.4 | 1.4±20% | 0.010 | 4.28 | 4.29 |
| D DLG0504-002.2 | 2.2±20% | 0.015 | 3.38 | 3.53 |
| D DLG0504-003.3 | 3.3±20% | 0.021 | 2.79 | 3.05 |
| D DLG0504-004.7 | 4.7±20% | 0.028 | 2.38 | 2.61 |
| D DLG0504-006.8 | 6.8±20% | 0.046 | 1.95 | 2.05 |
| D DLG0504-008.2 | 8.2±20% | 0.054 | 1.74 | 1.89 |
| D DLG0504-010.0 | 10±10% | 0.066 | 1.57 | 1.70 |
| D DLG0504-015.0 | 15±10% | 0.11 | 1.31 | 1.33 |
| D DLG0504-022.0 | 22±10% | 0.14 | 1.09 | 1.17 |
| D DLG0504-033.0 | 33±10% | 0.17 | 0.88 | 1.07 |
| D DLG0504-047.0 | 47±10% | 0.24 | 0.74 | 0.89 |
| D DLG0504-068.0 | 68±10% | 0.36 | 0.61 | 0.73 |
| D DLG0504-082.0 | 82±10% | 0.41 | 0.56 | 0.68 |
| D DLG0504-100.0 | 100±10% | 0.47 | 0.51 | 0.64 |
| D DLG0504-150.0 | 150±10% | 0.71 | 0.41 | 0.52 |
| D DLG0504-220.0 | 220±10% | 1.08 | 0.34 | 0.42 |
| D DLG0504-330.0 | 330±10% | 1.65 | 0.28 | 0.34 |
| D DLG0504-470.0 | 470±10% | 2.48 | 0.23 | 0.28 |
| D DLG0504-680.0 | 680±10% | 3.64 | 0.19 | 0.23 |
| D DLG0504-820.0 | 820±10% | 4.15 | 0.18 | 0.22 |
| D DLG0504-1000 | 1000±10% | 5.62 | 0.16 | 0.18 |

Notes:

- 1) Open Circuit Inductance Test Parameters: 100kHz, 0.25V_{rms}, 0.0A_{dc}, Test Equipment : HP4284A or WK3260B LCR Meter.
- 2) DCR limits @ 20°C. Test Equipment: CH502BC.
- 3) Isat current for an approximate 10% rolloff at 20°C
- 4) I_{rms} current for for an approximate T of 40°C. It is recommended that the temperature of the part not exceed 125°C