

# D Series Miniature Snap-in Power Rocker Switches

## Features/Benefits

- Momentary and maintained models
- PC and quick connect terminals
- Recessed bracket available – prevents accidental actuation
- RoHS compliant
- Gold plated options available

## Typical Applications

- Small appliances
- Computers and peripherals
- Medical instrumentation



UL 61058-1



## Specifications

### CONTACT RATING:

D101, D102, D103, D105, D108, D201, D202, D203

### GP (general purpose)

4 AMPS 125 VAC 50/60 Hz T85 10,000 cycles

2 AMPS 250 VAC 50/60 Hz T85 10,000 cycles

### R (resistive)

4 AMPS 30 VDC T85 10,000 cycles

D501, D502, D503, D508, D601, D602, D608

### GP (general purpose)

10 AMPS 125 VAC 50/60 Hz T85 10,000 cycles

5 AMPS 250 VAC 50/60 Hz T85 10,000 cycles

### R (resistive)

10 AMPS 30 VDC T85 10,000 cycles

0.4VA @ 20V AC/DC (gold plating) available upon request

ELECTRICAL LIFE: 10,000 make-and-break cycles at full load.

INSULATION RESISTANCE:  $10^9 \Omega$  min.

DIELECTRIC STRENGTH: 1,000 Vrms min. @ sea level.

## Materials

ACTUATOR & HOUSING: 6/6 nylon (UL 94V-2), color black, finish: matte.

MOVABLE CONTACTS: D10X and D20X Models: Copper, silver plated. D50X and D60X Models: Coin silver, silver plated.

STATIONARY CONTACTS AND TERMINALS: Copper or brass, silver plated. Gold plating available.

CONTACT SPRING: Music wire or stainless steel.

OPERATING TEMPERATURE: -30°C to +65°C

**NOTE:** Specifications and materials listed above are for standard switches. For information on specific and custom switches, consult Customer Service Center.

## Build-A-Switch

To order, simply select desired option from each category and place in the appropriate box. Available options are shown and described on pages G-61 through G-64. For additional options not shown in catalog, consult Customer Service Center.



### Switch Function

- D101** SPDT, On-None-On
- D102** SPST, On-None-Off
- D103** SPDT, On-Off-On
- D105** SPDT, Mom.-Off-Mom.
- D108** SPDT, Mom.-None-On
- D201** DPDT, On-None-On
- D202** DPST, On-None-Off
- D203** DPDT, On-Off-On
- D501** SPDT, On-None-On
- D502** SPST, On-None-Off
- D503** SPDT, On-Off-On
- D508** SPDT, Mom.-None-On
- D601** DPDT, On-None-On
- D602** DPST, On-None-Off
- D608** DPDT, Mom.-None-On

### Actuator

- J1** Rocker
- J5** Lever

### Actuator Color

- 2** Black
- 1** White
- 3** Red

### Mounting Style/Color

- S2** Snap-in, black
- B2** Recessed snap-in actuator guard, black
- G2** Actuator guard, black
- S1** Snap-in, white

### Terminations

- 15** Quick connect
- A** Right angle, PC thru-hole
- 02** PC Thru-hole
- 05** Twisted quick connect
- 06** Extended PC thru-hole
- 17** Wirable quick connect

### Actuator Markings

- NONE** No marking
- D** ON-OFF
- H** O I
- N** Large dot
- P** O -
- R** Red rectangle on end
- U** Large dot on end

### Contact Material

- QA** Silver
- Gold plating options available contact Customer Service



# D Series Miniature Snap-in Power Rocker Switches

## SWITCH FUNCTION

NO. POLES	MODEL NO.	AMP RATING*	SWITCH FUNCTION			CONNECTED TERMINALS			SCHEMATIC	
			POS. 1	POS. 2	POS. 3	POS. 1	POS. 2	POS. 3		
SP	<b>D102</b>	4	ON	NONE	OFF	1-1A	N/A	OPEN		
	<b>D502</b>	10								
	<b>D101</b>	4	ON	NONE	ON			1-1B	OPEN	
	<b>D501</b>	10			ON					
	<b>D103</b>	4		OFF						
	<b>D503</b>	10								
<b>D105</b>	4	MOM.	OFF	MOM.						
<b>D108</b>	4	MOM.	NONE	ON						
	<b>D508</b>	10	MOM.	NONE	ON					

### SPDT

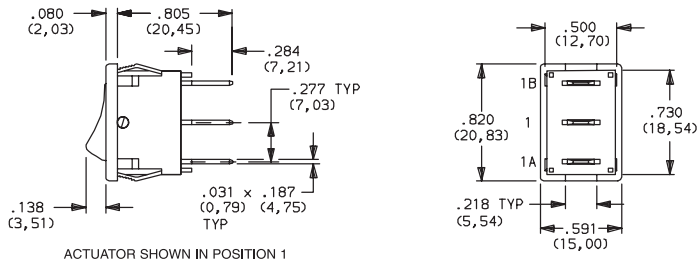

ACTUATOR SHOWN IN POSITION 1

TERMINAL NOS. FOR REF. ONLY

Part number shown: D101J12S215QA

DP	<b>D202</b>	4	ON	NONE	OFF	1-1A, 2-2A	N/A	OPEN		
	<b>D602</b>	10								
	<b>D201</b>	4	ON	NONE	ON			1-1B, 2-2B	OPEN	
	<b>D601</b>	10			ON					
	<b>D203</b>	4		OFF						
<b>D608</b>	10	MOM.	NONE							

### DPDT

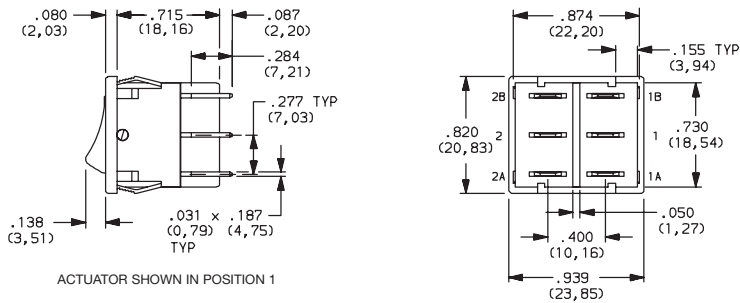

ACTUATOR SHOWN IN POSITION 1

TERMINAL NOS. FOR REF. ONLY

MOM. = Momentary

\*AMP RATING: see G-60

See CONTACT MATERIALS, page G-64.



Rocker

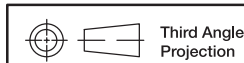

Third Angle Projection

Dimensions are shown: Inches (mm)  
Specifications and dimensions subject to change



# D Series Miniature Snap-in Power Rocker Switches



## J1 ROCKER

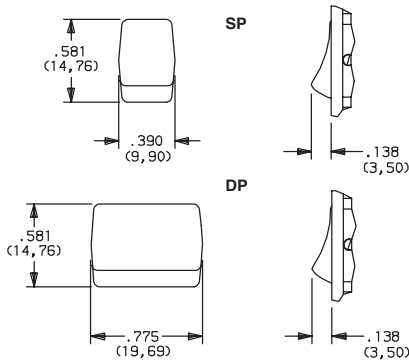

## J5 LEVER

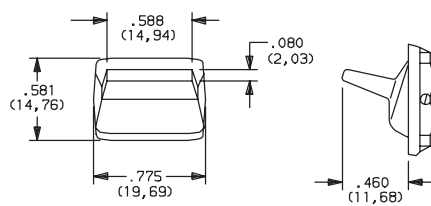

OPTION CODE	ACTUATOR COLOR
2	BLACK
1	WHITE
3	RED

**NOTE:** Actuator finish: matte. Other colors available, consult Customer Service Center.

'J5' actuator available only with DP models D201, D202, D601 and D602.

## MOUNTING STYLE/COLOR

### S SNAP-IN

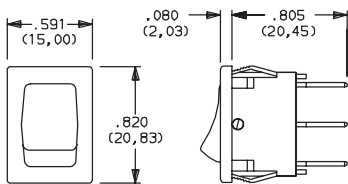

OPTION CODE	HOUSING COLOR
2	(STD.) BLACK
1	WHITE

**NOTE:** Frame finish on housing: matte. Other colors available, consult Customer Service Center.

### B2 RECESSED SNAP-IN ACTUATOR GUARD, BLACK

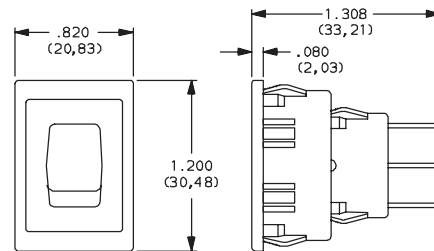

**NOTE:** Vertical mount, SP models only.

### G2 ACTUATOR GUARD, BLACK

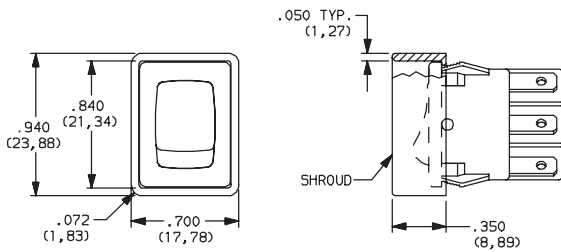

**NOTE:** Vertical mount, SP models only.

### PANEL MOUNTING

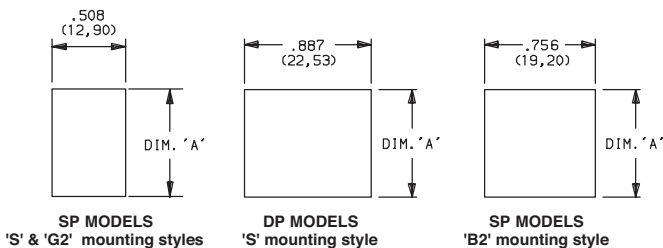

PANEL THICKNESS	DIM 'A' SP & DP MODELS 'S' MOUNTING STYLE	DIM 'A' WITH 'G2' OPTION SP MODELS ONLY	DIM 'A' SP MODELS 'B' MOUNTING STYLE
.030-.049 (0,76) (1,24)	.756 (19,20)	.764 (19,41)	1.068 (27,13)
.049-.079 (1,24) (2,01)	.764 (19,41)	.780 (19,81)	1.076 (27,33)
.079-.118 (2,01) (3,00)	.780 (19,81)	n/a	1.092 (27,74)

**NOTE:** Blank insert available for SP models only, see page G-64.

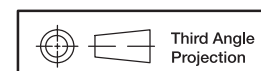

Dimensions are shown: Inches (mm)  
 Specifications and dimensions subject to change



# D Series Miniature Snap-in Power Rocker Switches

## TERMINATIONS

### A RIGHT ANGLE, PC THRU-HOLE

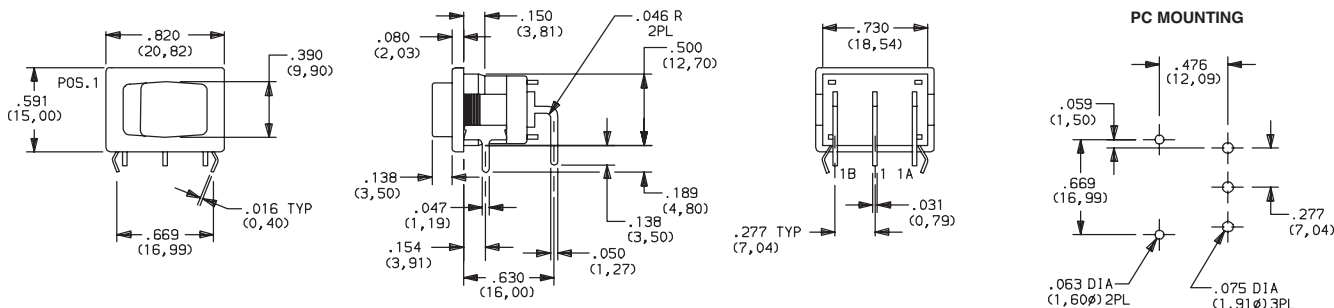

Available with D101, D102, D501, D502 SP models only.

## TERMINATIONS

### 02 PC THRU-HOLE

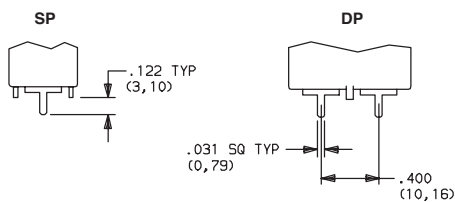

Available with DX01 and DX02 models only.

### 06 EXTENDED PC THRU-HOLE

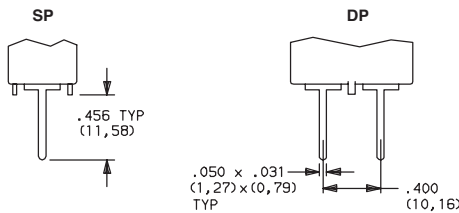

Available with DX01 and DX02 models only.

### PC MOUNTING (02 and 06)

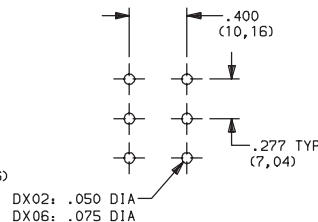

### 15 QUICK CONNECT

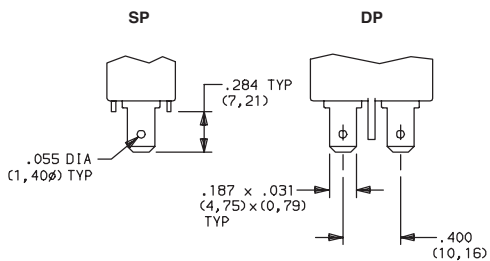

Available with DX01 and DX02 models only.

### 05 TWISTED QUICK CONNECT

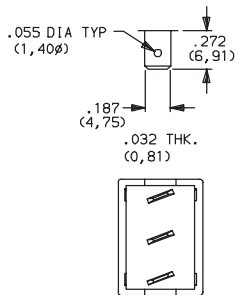

NOTE: Terminals are twisted.

### 17 WIRABLE QUICK CONNECT

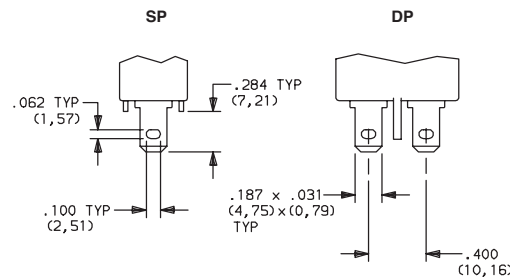

Available with DX01 and DX02 models only.

## ACTUATORS

**NONE** NO MARKING

**D** ON-OFF

**H** O |

**N** LARGE DOT

**P** O -

**R** RED RECTANGLE ON END

**U** LARGE DOT ON END

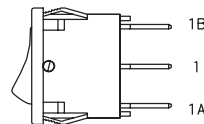

'D, H, P & U' marking options: marking color white, standard for all actuator colors except white. Black marking color, standard for white actuators. 'R & N' marking option: red marking color, standard. Consult Customer Service Center for other available marking colors.

NOTE: Orientation of actuator markings and terminals.

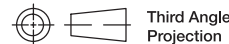

Dimensions are shown: Inches (mm)  
Specifications and dimensions subject to change

# D Series Miniature Snap-in Power Rocker Switches

## CONTACT MATERIAL

OPTION CODE	CONTACT AND TERMINAL MATERIAL	RATINGS
<b>QA</b>	SILVER 1	D101, D102, D103, D105, D108, D201, D202, D203
		GP (general purpose) 4 AMPS 125 VAC 50/60 Hz T85 10,000 cycles
		2 AMPS 250 VAC 50/60 Hz T85 10,000 cycles
		R (resistive) 4 AMPS 30 VDC T85 10,000 cycles
		D501, D502, D503, D508, D601, D602, D608
		GP (general purpose) 10 AMPS 125 VAC 50/60 Hz T85 10,000 cycles
		5 AMPS 250 VAC 50/60 Hz T85 10,000 cycles
		R (resistive) 10 AMPS 30 VDC T85 10,000 cycles

<sup>1</sup>MOVABLE CONTACT: D10X and D20X MODELS: Copper, silver plated.  
D50X and D60X MODELS: Coin silver, silver plated.



0.4VA @ 20V AC/DC Gold plated options available contact Customer Service.

STATIONARY CONTACTS & TERMINALS: Copper or brass, silver plated.

## AVAILABLE HARDWARE

Insert  
SP Only

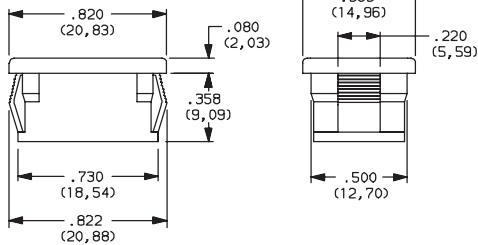

**PART NO.**  
**057190200** BLACK  
Material: Nylon 6/6  
Finish: Matte

Recessed Actuator Guard,  
SP Only

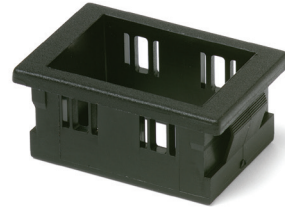

**599D02000** BLACK  
Material: 6/6 Nylon  
Finish: Matte

Actuator Guard

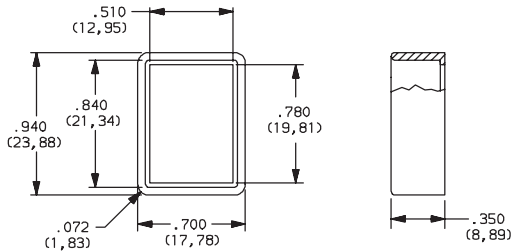

**PART NO.**  
**104C22000**  
Material: PBT thermoplastic  
Finish: Matte

**PART NO.**  
**216C00000** IP65 SPLASH PROOF RUBBER BOOT

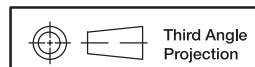
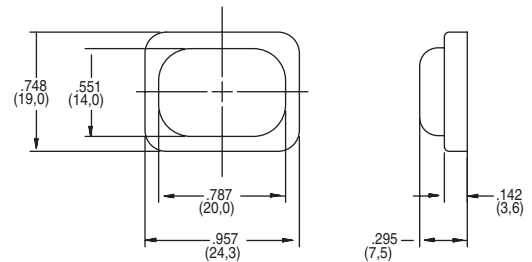

Third Angle Projection  
Dimensions are shown: Inches (mm)  
Specifications and dimensions subject to change



# Mouser Electronics

Authorized Distributor

Click to View Pricing, Inventory, Delivery & Lifecycle Information:

## C&K Switches:

[D501J12S215PQA](#) [D501J12S215QA](#) [D602J11S202PQF](#) [D508J12S205QA](#) [D501J12S215PQF](#) [D101J12S215QA](#)  
[D501J12S2APQF](#) [D501J12S2AHQF](#) [D503J12S205QA](#) [D105J12S205QA](#) [D502J12S215PQF](#) [D502J12S215PQA](#)  
[D102J12S202PQA](#) [D102J12S215PQA](#) [D102J12S217PQA](#) [D102J12S215QA](#) [D608J12S205QA](#) [D601J12S215QA](#)  
[D201J52S215QA](#) [D601J12S215PQF](#) [D602J12S215PQF](#) [D202J12S215DQA](#) [D202J12S215QA](#) [D201J12S205PQA](#)  
[D202J12S205PQA](#) [D502J12S217PQF](#) [D601J12S215PQA](#) [D101J12G215NQA](#) [D101J12S205QF](#) [D101J12S215PQA](#)  
[D101J12S217NQF](#) [D101J12S217QA](#) [D101J12S2APQA](#) [D102J11S115DQA](#) [D102J11S217DQA](#) [D102J12B215HQA](#)  
[D102J12B215HQF](#) [D102J12B217PQF](#) [D102J12G215HQA](#) [D102J12G215PQA](#) [D102J12G217QA](#)  
[D102J12S202DQA](#) [D102J12S2AHQA](#) [D105J11G205PQA](#) [D108J11S205QA](#) [D201J12S202QA](#) [D201J12S202QF](#)  
[D202J12S206HQA](#) [D202J12S206PQA](#) [D202J12S215UQA](#) [D202J12S217HQF](#) [D502J11S115QA](#) [D502J12B215HQA](#)  
[D502J12G215HQA](#) [D502J12S202HQA](#) [D502J12S206HQA](#) [D502J12S206PQA](#) [D502J12S217HQA](#) [D502J12S2AQF](#)  
[D601J12S202QF](#) [D601J52S206QA](#) [D601J53S217DQA](#) [D602J12S215QA](#) [D602J12S217HQF](#) [D101J12G215HQA](#)  
[D101J12S205DQA](#) [D101J12S205PQA](#) [D101J12S205QA](#) [D101J12S215DQA](#) [D101J12S215HQF](#) [D101J12S215PQF](#)  
[D101J12S2APQF](#) [D101J13S205DQA](#) [D102J11S205QA](#) [D102J12B215PQA](#) [D102J12B215PQF](#) [D102J12S115DQA](#)  
[D102J12S115HQA](#) [D102J12S205DQA](#) [D102J12S205NQA](#) [D102J12S205PQF](#) [D102J12S205QA](#)  
[D102J12S215DQA](#) [D102J12S215HQA](#) [D102J12S215HQF](#) [D102J12S215PQF](#) [D102J12S215RQF](#)  
[D102J12S217DQA](#) [D102J12S217PQF](#) [D102J12S2APQA](#) [D102J12S2APQF](#) [D102J13S215HQF](#) [D102J13S217PQF](#)  
[D103J12S205QA](#) [D105J12B205NQA](#) [D105J12S205HQA](#) [D105J19S205QA](#) [D108J12S205QA](#) [D201J12S205QA](#)  
[D201J12S215DQA](#)