

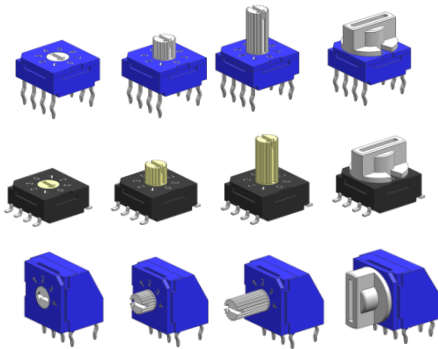

Features

- ◆ Washable Meet IP67
- ◆ Gold plated contacts
- ◆ Surface Mount, Thru-Hole and Right Angle
- ◆ Flush or Extended Rotors
- ◆ Knobs available



Standard Specifications :

Operating temperature range	: -40°C ~ +85°C
Storage temperature range	: -25°C ~ +70°C
Sealing	: Washable "O" ring
Mechanical Life	: 20,000 Steps

Electrical Characteristics

Contact rating :	
Non-switching	: DC 50V, 100mA
Switching	: DC 5V, 100mA
Minimum	: DC 20mV, 1μ A
Contact timing	: Non-shorting
Contact resistance (Initial/after operating life)	: 60mΩ /100mΩ
Insulation resistance	: 100MΩ (DC 100V) Max.
Dielectric strength	: 300VAC/ 1 minute

Soldering Information :

Wave soldering	: 260±5°C for 5 sec. max.
Reflow soldering	: Peak temp. 245°C max. The time above 240 must be 30 sec. max.
Hand soldering	: 350°C 3 Sec. max.

Order Information

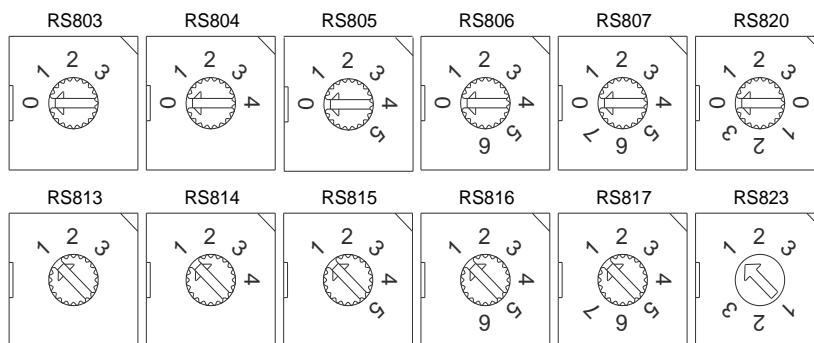
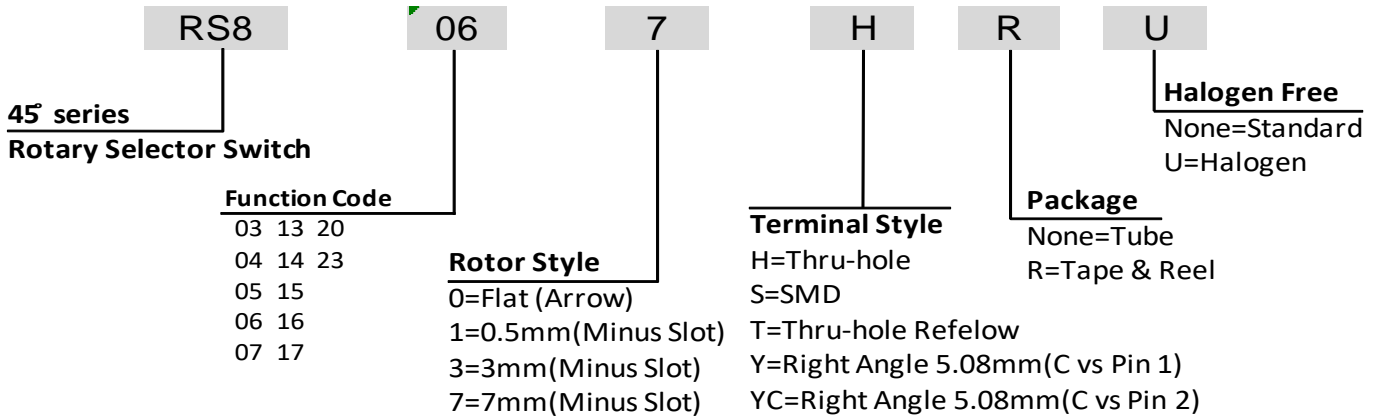

Rotor Style

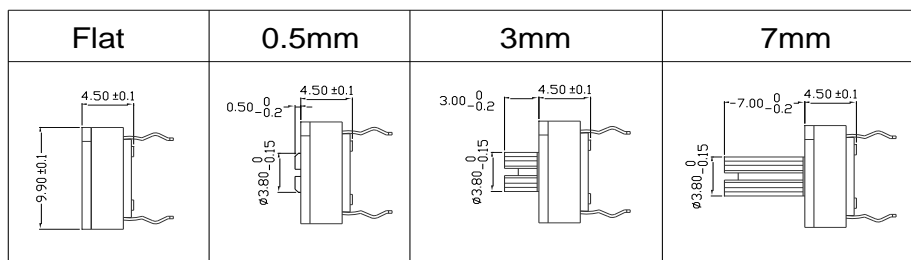



Schematic & Terminal Connection

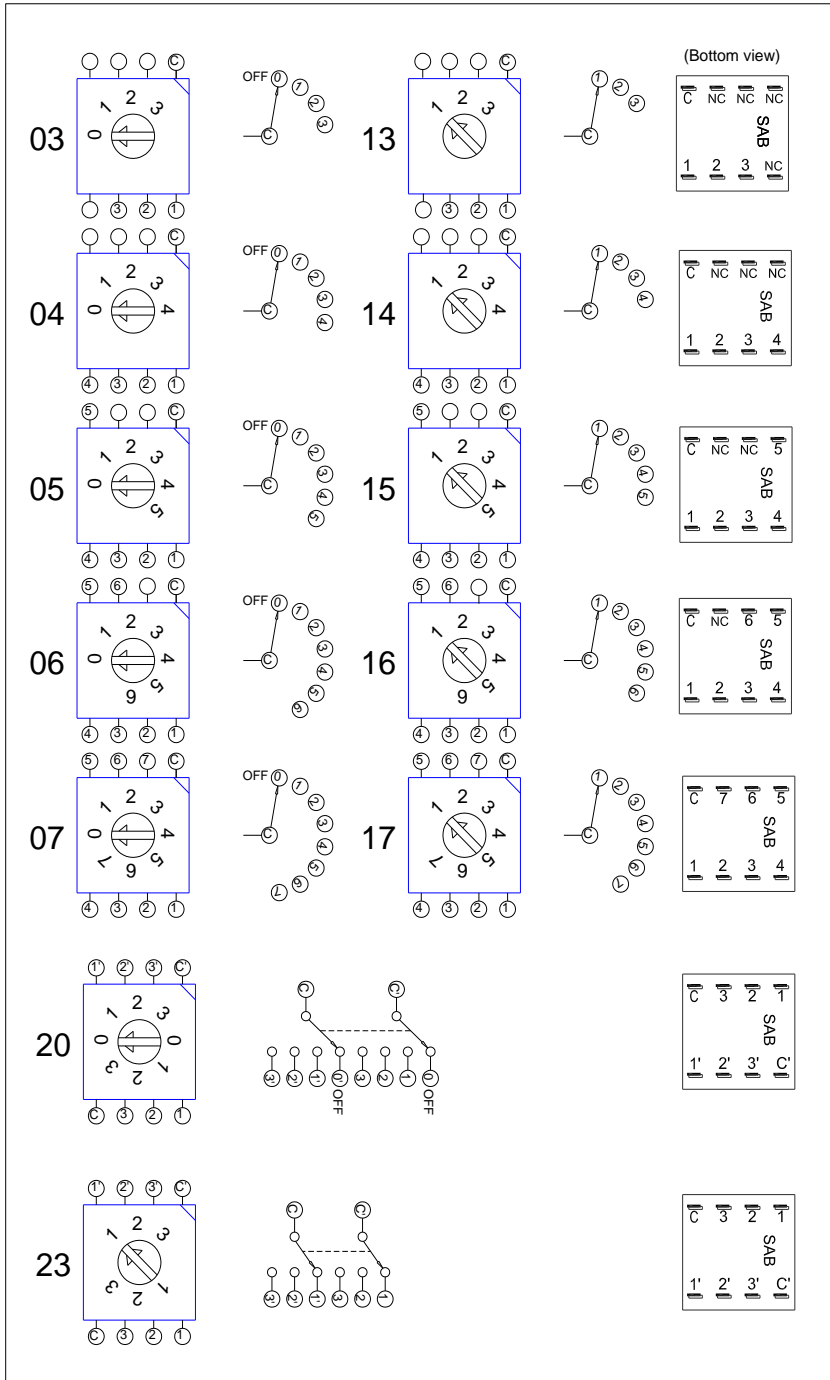

Package

P/N	Function Code	Quantity per Tube
RS8_H/T	03,04,05,06,07	50
RS8_H/T	13,14,15,16,17	50
RS8_H/T	20,23	50
RS8_S	03,04,05,06,07	50
RS8_S	13,14,15,16,17	50
RS8_S	20,23	50
RS8_Y	03,04,05,06,07	45
RS8_Y	13,14,15,16,17	45
RS8_Y	20,23	45
P/N	Function Code	Quantity per Reel
RS8_0/1S-R	03,04,05,06,07	600
RS8_0/1S-R	13,14,15,16,17	600
RS8_0/1S-R	20,23	600
RS8_3S-R	03,04,05,06,07	350
RS8_3S-R	13,14,15,16,17	350
RS8_3S-R	20,23	350
RS8_7S-R	03,04,05,06,07	200
RS8_7S-R	13,14,15,16,17	200
RS8_7S-R	20,23	200
RS8_7H/T-R	03,04,05,06,07	140
RS8_7H/T-R	13,14,15,16,17	140
RS8_7H/T-R	20,23	140

Knob Order Information

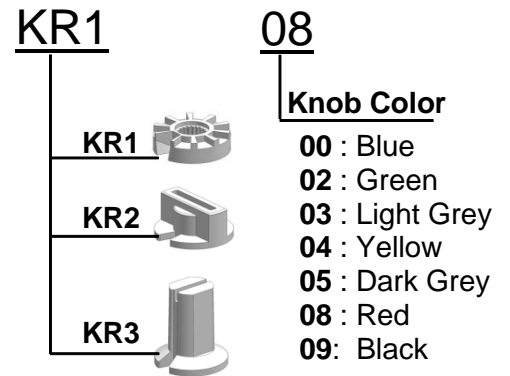

Dummy Terminals

3 positions	④ ⑤ ⑥ ⑦
4 positions	⑤ ⑥ ⑦
5 positions	⑥ ⑦
6 positions	⑦
7 positions	--

* NC= Dummy terminal

Outline Dimensions

Thru-Hole

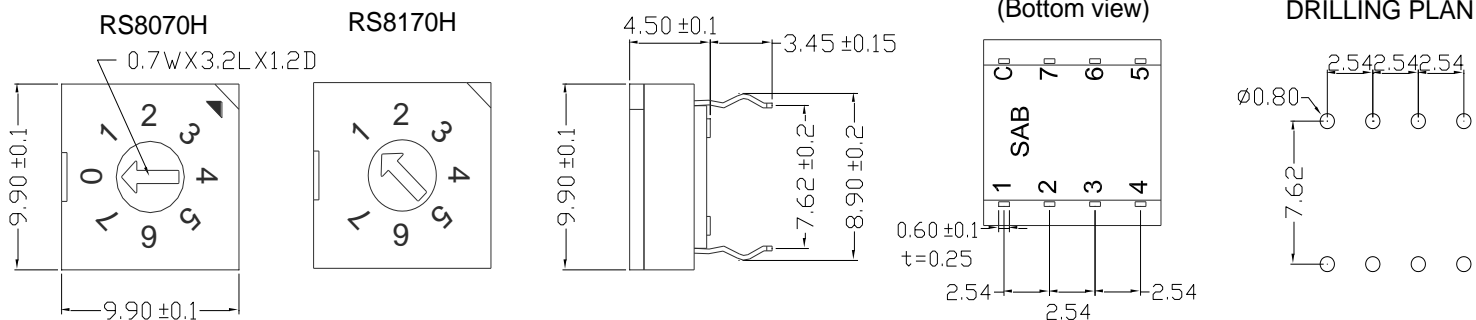

SMD

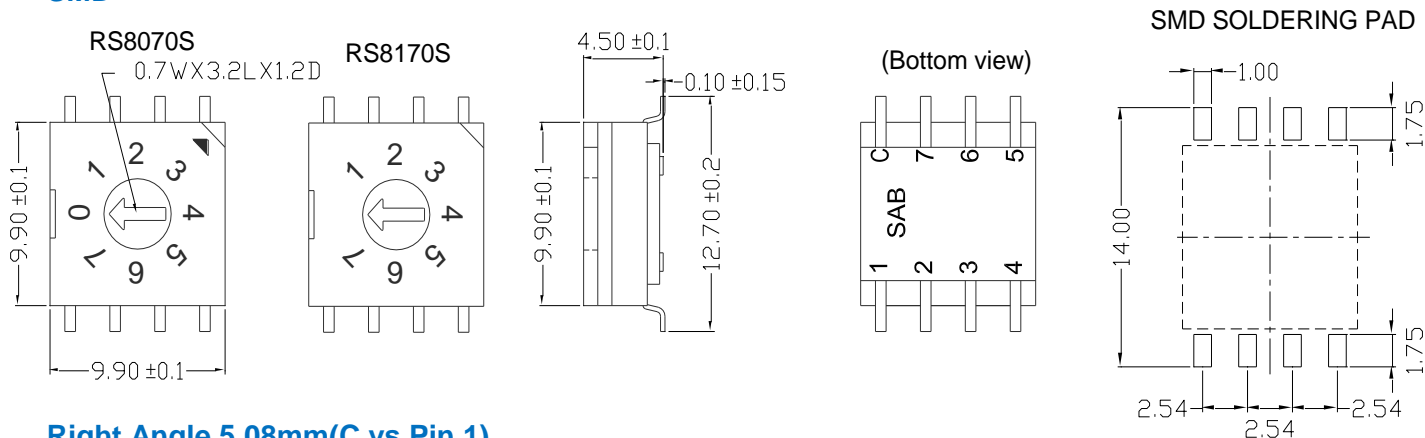

Right Angle 5.08mm(C vs Pin 1)

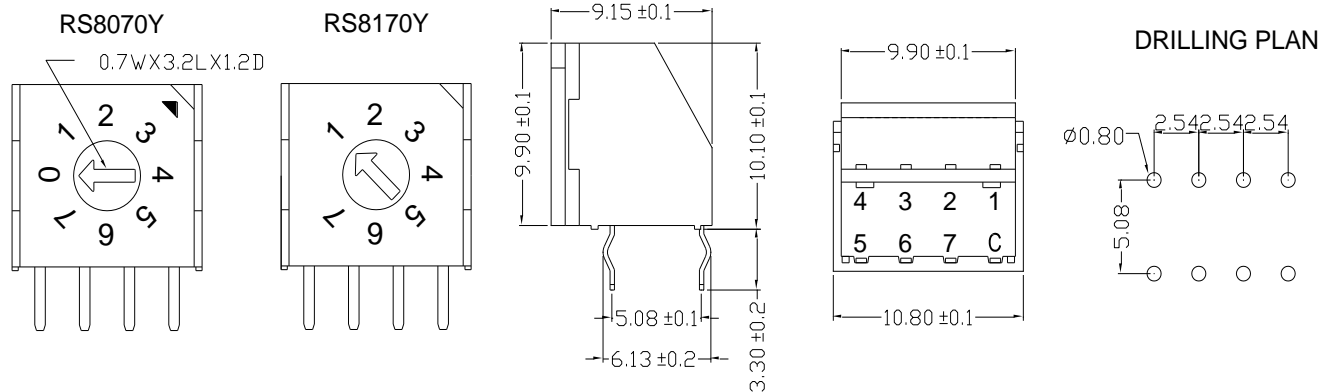

Right Angle 5.08mm(C vs Pin 2)

