

FEATURE

- Very small SMD seam sealed clock crystal oscillators.
- For applications in WLAN, Bluetooth, DSC. DSL and other IT product
- RoHS compliant and pb free.

ELECTRICAL SPECIFICATIONS

Frequency Range	27.000MHz
Output Type	CMOS
Output Load	15pF
Supply Voltage	3.3V
Frequency Tolerance	±15ppm
Frequency Stability	±15ppm
Voltage Vol(Max)/Voh(Min)	0.1VDD/0.9VDD
Operating Temperature Range	-20°C-+70°C
Storage Temperature Range	-55°C-+125°C
Voltage Vol(Max.)/ Voh(Min.)	0.1VDD/ 0.9VDD
Rise(Tr)/Fall(Tf) Time	8ns Max
Supply Current	15mA Max
Symmetry	45-55%
Start-up Time	5ms Max
Phase Jitter(12KHz-20MHz)	2ps Max
Aging(at 25°C)	±3ppm/year Max

DIMENSIONS (Unit: mm)

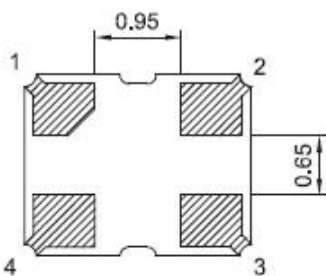
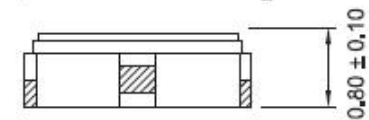
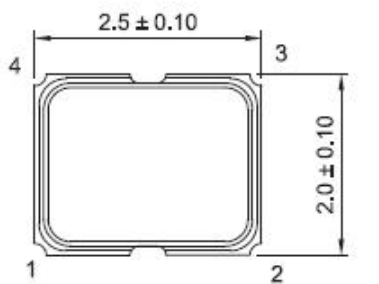

PAD FUNCTION:
 1:ENABLE CONTROL
 2:GND
 3:OUT
 4:VDD

Suggested Layout

