

PC型小圆形电连接器

PC 系列连接器

PC series connector

PC型小圆形电连接器体积小,金属铝合金外壳,重量轻,螺纹连接,电连接可靠,使用方便,目前有4、7、10、19芯,通用俄罗斯的PC产品及国内同类仿制产品,其中4、7芯与Y4M-4、7芯的安装尺寸相同,是Y4M的良好替代品。广泛应用于各种电子仪器、电气设备间的电连接。安装方式有法兰盘式和电缆式两种。

PC series circular connectors have the features of small size, light weight, convenient application with threaded-coupling connection. It can be interchanged with Russian type PC, They are widely used for the electrical connection between electrical equipments and instruments.



命名 How to order

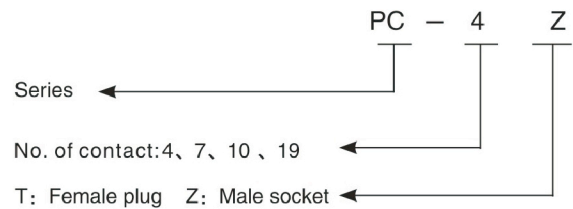
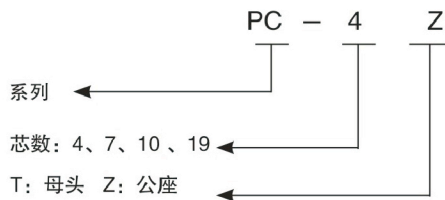

技术特性 Technical characteristics

工作温度 Temperature	相对湿度 Relative humidity	大气压力 Atmosphere	振动 Vibration	使用寿命 Endurance
-40℃~ +105℃	(92~98)% at40+2℃	101.33KPa~6.67Pa	10~2000Hz 196m/s ²	500 cycles
工作电流 Working Current	电压 Voltage	接触阻 Contact resistance	插针直径 Contact φ	
3A	200V	≤8mΩ	φ 1mm	

PC-4T

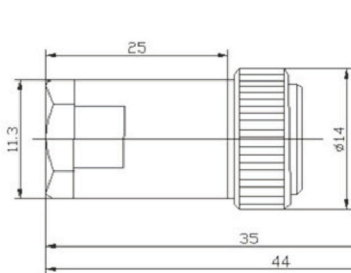

PC-4Z

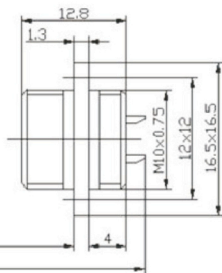

PC-7T

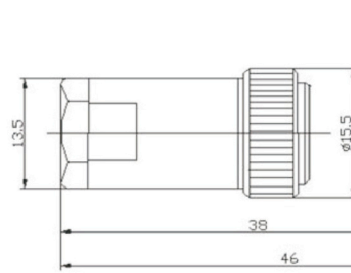

PC-7Z

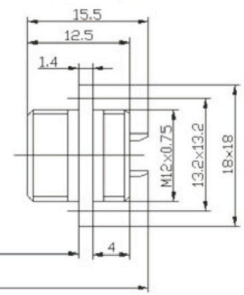

PC-10T

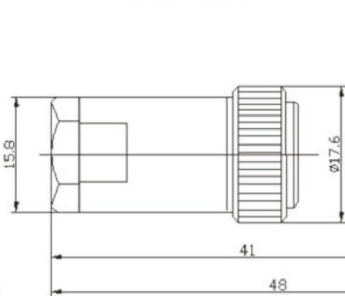

PC-10Z

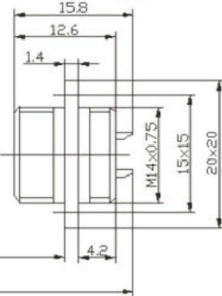

PC-19T

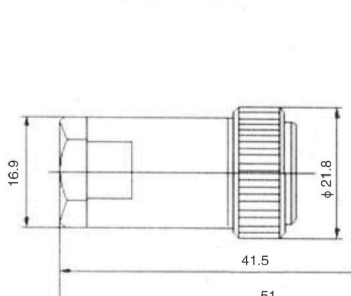

PC-19Z

