

# IP67

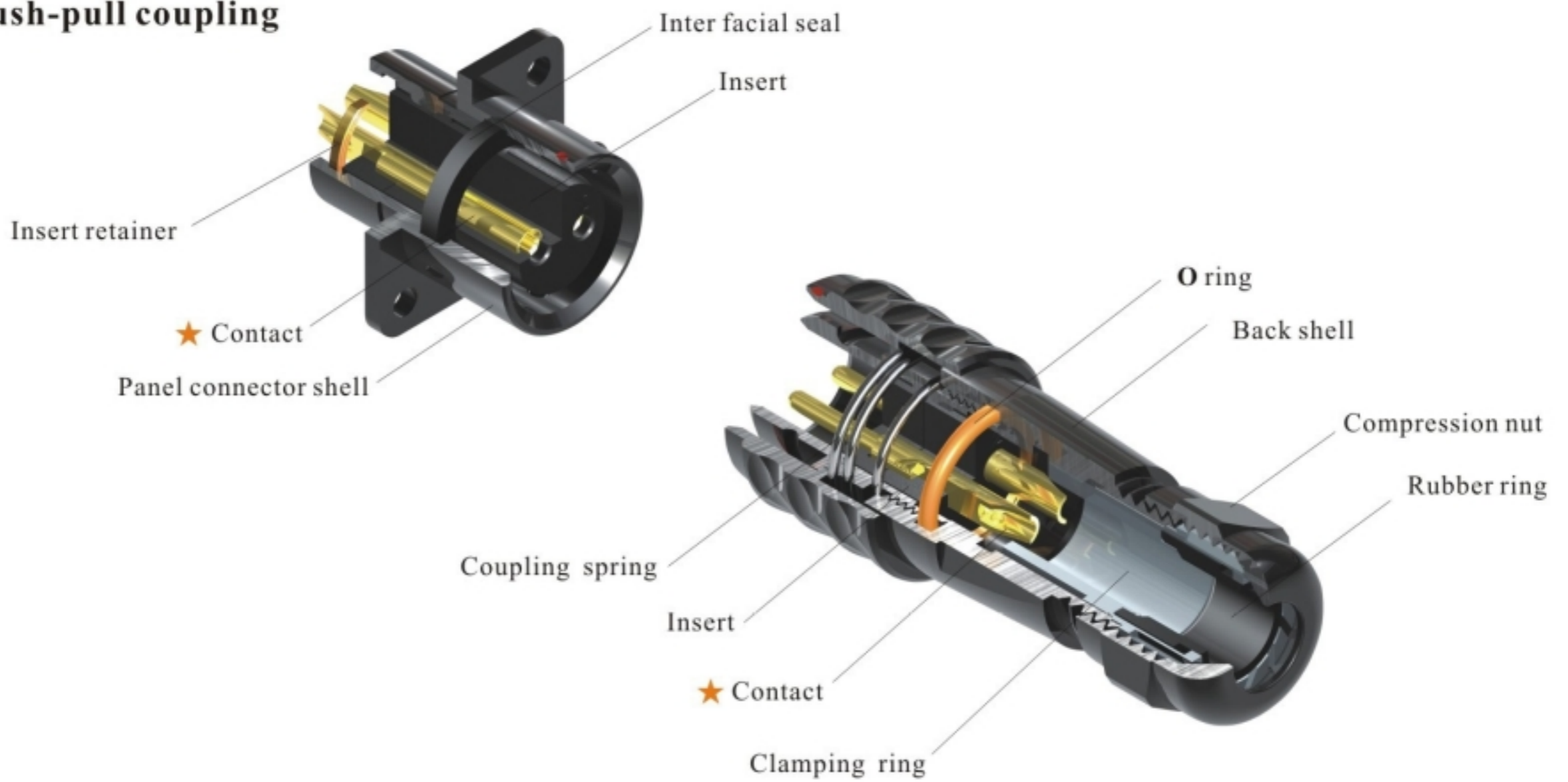

- SA Series IP67
- Push-pull coupling



★ Each side can be male or female contact

## Material and spec

Coupling	Push-pull
Shell material	Anodized aluminium
Insert material	PPS, max temperature 260 °C
Contact material	Brass with gold plating
Termination	Solder: SA10, SA12, SA16, SA20, SA28 Crimp: SA16, SA20, SA28 Screw: SA20, SA28 (∅2.5, ∅3.5mm contact)
IP rating	IP67
Mating cycle	500
Temperature range	-40°C~+85°C
Insulation resistance (MΩ)	2000

**SA16 Series**



**Cable connector**  
Mate with SA1611, SA1612, SA1613

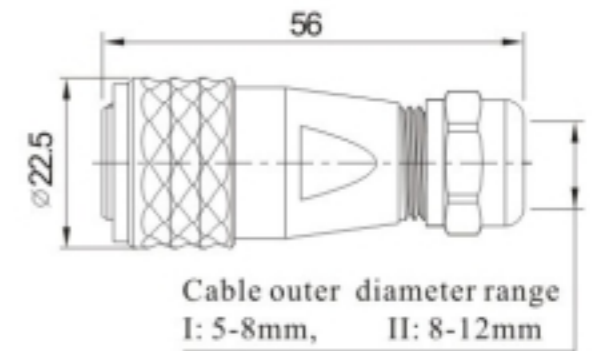

SA1610/P --- SA1610/S

- Number of contact
- Cable outer diameter  
I: 5-8mm, II: 8-12mm
- 1: solder, 3: crimp
- Colour:  
B: Black  
S: Silver  
L: Blue  
G: Green  
R: Red } special order



**In-line cable connector**  
Mate with SA1610

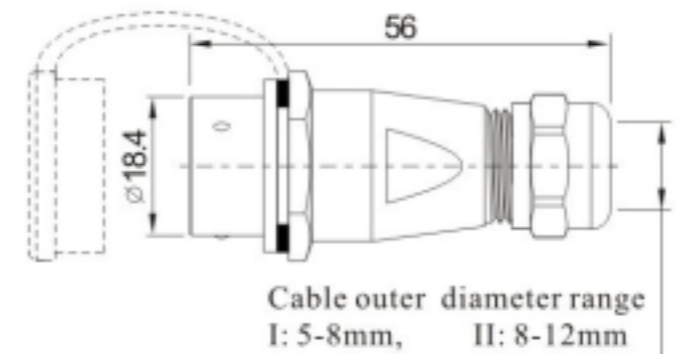

SA1611/P --- SA1611/S



**Rear-nut mount**  
Mate with SA1610

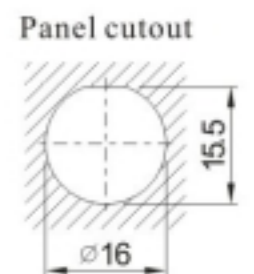
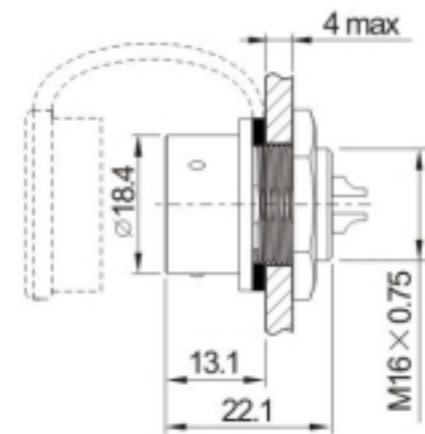

SA1612/P --- SA1612/S

- Number of contact
- 1: solder, 3: crimp
- Colour:  
B: Black  
S: Silver  
L: Blue  
G: Green  
R: Red } special order



**Square flange**  
Mate with SA1610

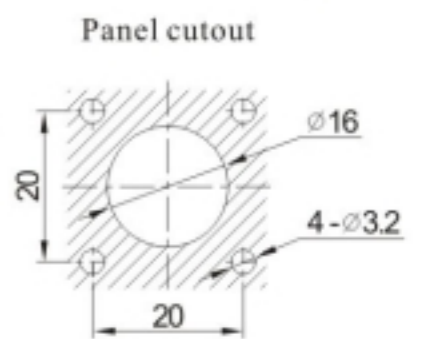
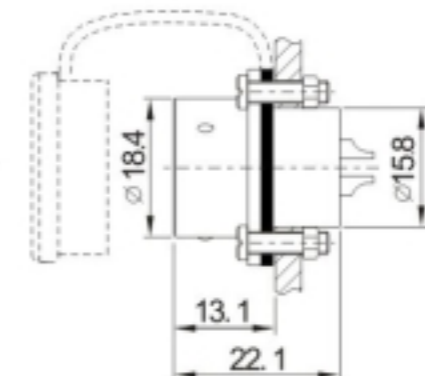
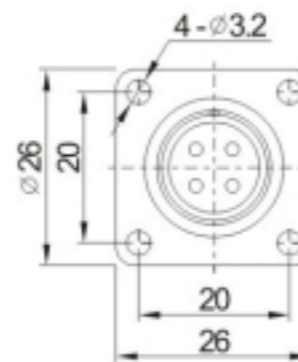

SA1613/P --- SA1613/S

**Solder contact spec**

★ Crimp contact spec see page 77-80

Number of contact	2	3	4	5	7	9	10
Male contact face view							
Rated current (A)	10	10	5	5	5	5	5
Contact diameter (mm)	1.5	1.5	1	1	1	1	1
Rated voltage (AC.V)	500	500	500	500	400	400	400
Test voltage(AC.V) 1 min	1500	1500	1500	1500	1200	1200	1200
Contact resistance (mΩ)	2.5	2.5	5	5	5	5	5
Wire size (mm <sup>2</sup> / AWG)	≤2/14	≤2/14	≤0.785/18	≤0.785/18	≤0.785/18	≤0.785/18	≤0.785/18

## • SA16 Series Mating diagram

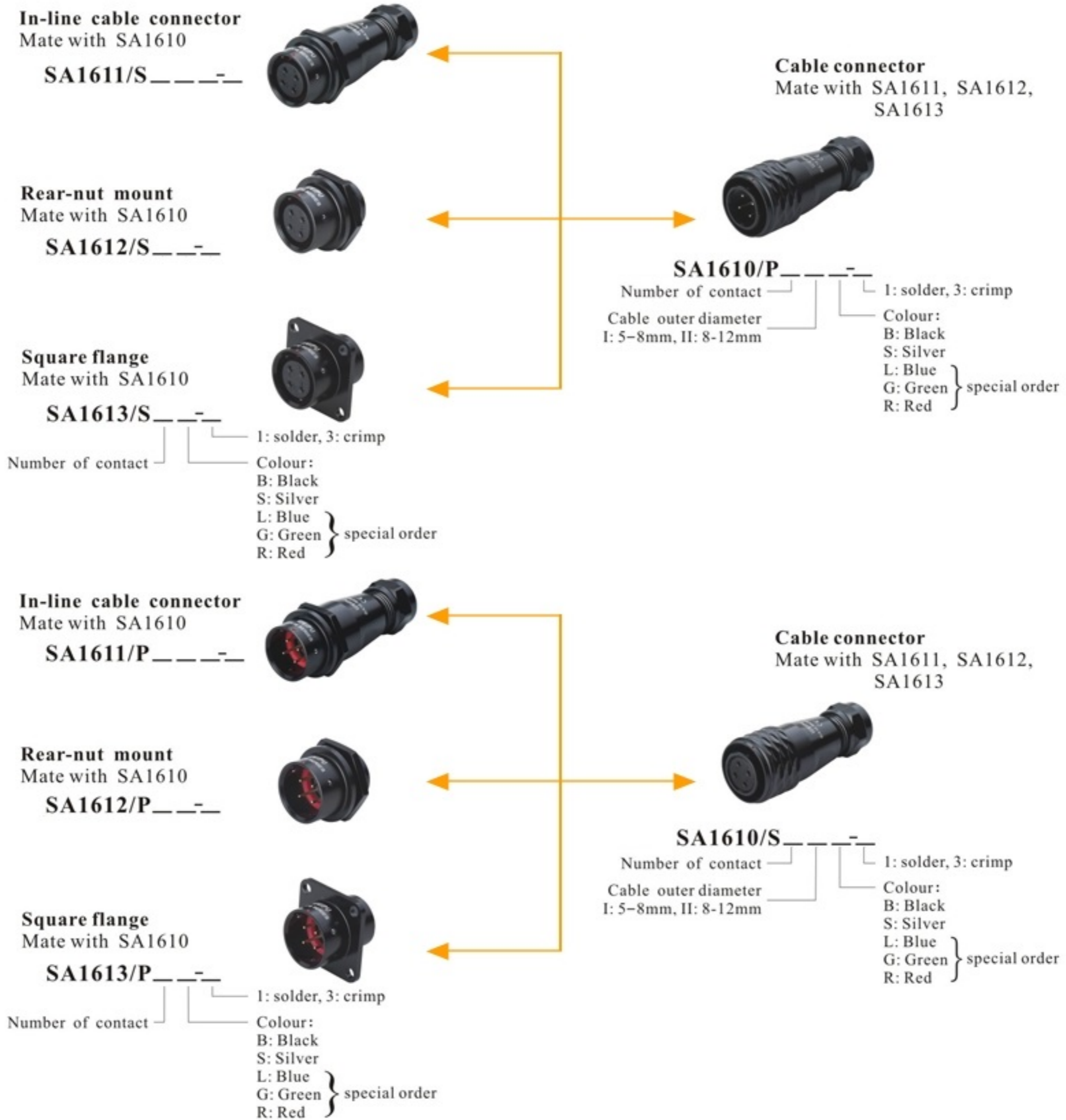

### Application

#### SA16

This state of the art, miniature IP67 waterproof connector is designed for any high-end products need a high-end connector to match with, such as medical devices, high-end equipments, testing or measuring equipments, communications, marine equipment etc., for data and power.