

A-A

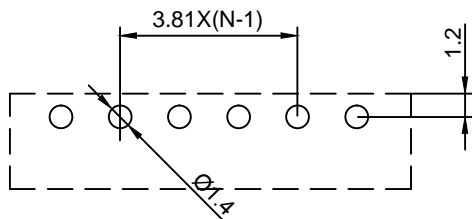
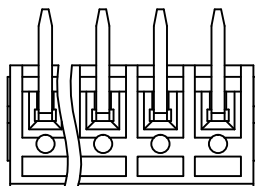
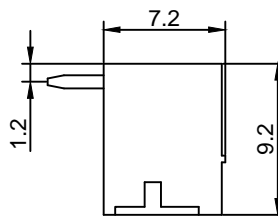
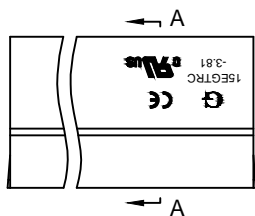
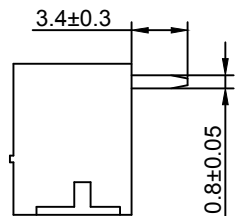
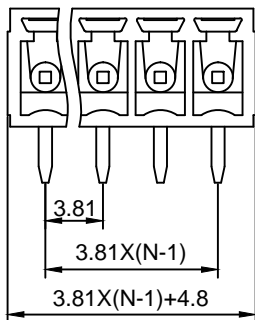

Material :

- ① Housing : PA66(UL94V-0)
- ② Pin Header : Brass , Tin Plated

Electrical :

- 1.Rated Voltage : 300V UL IEC
- 2.Rated Current : 8A 250V 7A
- 6.Withstanding Voltage : AC1600V/1Min.
- 7.Operating Temperature : -40°C~+105°C
- 8.RoHS Compliance
- 9.Safety Approval :
- 10.Undimensioned Tolerances:

Pitch Range In mm			Nominal Dimension Range In mm					—	∩	∇
≤6	6 ~ 10	10 ~ 24	≤30	30 ~ 60	60 ~ 100	100 ~ 150	>150	0.05/10		
±0.10	±0.15	±0.25	±0.20	±0.30	±0.50	±0.70	±1.00	±0.1°		

15EGTRC - 3.81 - XXP - X X - 00 AH

① ② ③ ④ ⑤ ⑥ ⑦

- ① Series No.
- ② Pitch
- ③ Poles
- ④ 1 Single Pitch
2 Double Pitch
- ⑤ Color: 1 Grey
2 Blue
3 Black
4 Green(Standard For AH)
5 Orange
6 Red
7 Transparent
8 Yellow
9 White
- ⑥ Customer Request : 00--Standard
- ⑦ AH--Standard(PA66)

DETACHED LISTS	Grolten 宁波冠泰电子有限公司 NINGBO GOLTEN ELECTRONICS CO., LTD.	
	APPD: MA_11/24/16'	PART NO. 15EGTRC-3.81-XXP-XX-00AH
	CHKD: Yu_11/23/16'	
	DRFT: Chen_11/22/16'	
	THIRD ANGLE PROJECTION	MM (INCH)
	DO NOT SCALE DRAWING	SCALE 1/1