



**Model**  
**ESPE 0612 W2E**

| Output                            |  |           |
|-----------------------------------|--|-----------|
| Voltage                           | Current                                  | Power     |
| <b>12Vdc</b>                      | <b>0.5A</b>                              | <b>6W</b> |
| CE                                |  |           |
| EMC                               | 2014/30/EU                               |           |
| LVD                               | 2014/35/EU EN 60950-1:2006+A11+A1+A12+A2 |           |
| M.T.B.F.                          |  |           |
| 50.000 h Calculated Hours at 25°C |  |           |

| Output Characteristics:                |           |             |                 |                 |
|--|-----------|-------------|-----------------|-----------------|
| Voltage                                | Min. Load | Rated. Load | peak Load       | Output Power    |
| 12Vdc                                  | 0.00A     | 0.5A        | 0.7A (30sec)    | 6W              |
| Combined Load/Line Regulation          |           |             |                 |                 |
| Voltage                                | Min. Load | Rated. Load | Line Regulation | Load Regulation |
| 12Vdc                                  | 0.00A     | 0.5A        | +/- 3%          | +/-5%           |
| Ripple and Noise (Max.)                |           |             |                 |                 |
| <200mV p-p                             |           |             |                 |                 |
| Efficiency:                            |           |             |                 |                 |
| Energy Star Compliance: Level V 73,49% |           |             |                 |                 |
| Standby Power                          |           |             |                 |                 |
| 0.3W max                               |           |             |                 |                 |
| Protection Function                    |           |             |                 |                 |

| Input Characteristics: |           |          |                |                       |
|------------------------|-----------|----------|----------------|-----------------------|
| Voltage                | Frequency | Current  | Inrush Current | Ac Leakage Current    |
| 100-240 Vac            | 50/60Hz   | 0.25Amps | 30 Amps Max.   | 0.25mA Max. At 264Vac |

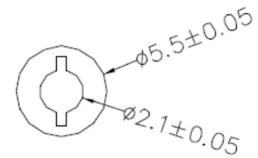
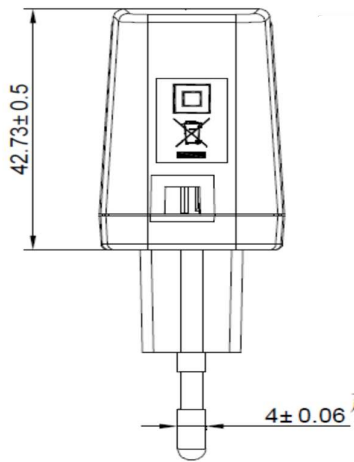
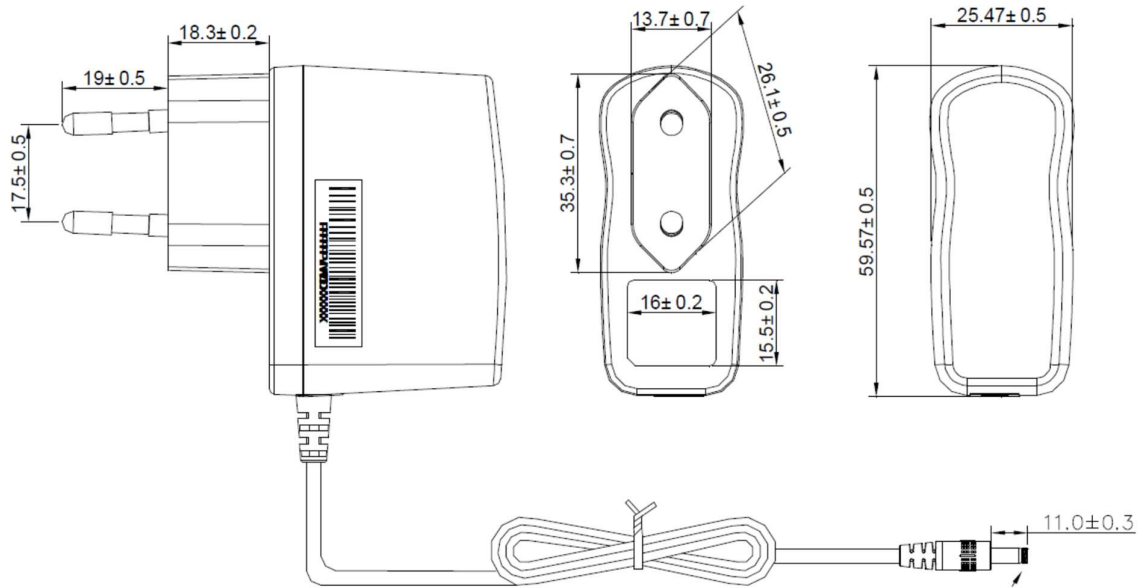

| Model              | Optional DC plug       |
|--------------------|------------------------|
| ESPE 0612-W2E      | 2.1x5.5mm              |
| ESPE 0612-W2E-0723 | 0.7x2.35mm             |
| ESPE 0612-W2E-1130 | 1.1x3.0mm              |
| ESPE 0612-W2E-1135 | 1.1x3.5mm              |
| ESPE 0612-W2E-1335 | 1.3x3.5mm              |
| ESPE 0612-W2E-1740 | 1.7x4.0mm              |
| ESPE 0612-W2E-1748 | 1.7x4.8mm              |
| ESPE 0612-W2E-1755 | 1.7x5.5mm              |
| ESPE 0612-W2E-2555 | 2.5x5.5mm              |
| ESPE 0612-W2E-3055 | 3.0x5.5mm - center pin |