

enclosures:

- size "66.16" from page 166
- size "57.27" from page 184
- size "77.27" from page 198
- size "104.27" from page 212

inserts with screw fixing centre distance:

- 66 x 16 mm (enclosures CZAV/MZAV/MZVF 25...)
- 57 x 27 mm (enclosures CAV/MAV/MFV 10...)
- 77.5 x 27 mm (enclosures CAV/MAV/MFV 16... and CAF/MAF/MFF 16...)
- 104 x 27 mm (enclosures CAV/MAV/MFV 24... and CAF/MAF/MFF 24...)

hoods with double top entry



hoods with double front entry



description	part No.		entry Pg		part No.		entry M	
with pegs for 1 lever used with enclosures size "66.16"	CZAV 25 L216		16 x 2		MZAV 25 L220		20 x 2	
with pegs for 1 lever, without adaptor * used with enclosures size "66.16"	CZVF 25 L216		16 x 2		MZVF 25 L220		20 x 2	
with pegs for 2 lever - used with enclosures size "57.27" - used with enclosures size "77.27" - used with enclosures size "77.27" - used with enclosures size "104.27" - used with enclosures size "104.27"	CAV 10.213 CAV 16.216 CAV 16.221 CAV 24.221 CAV 24.229		13,5 x 2 16 x 2 21 x 2 21 x 2 29 x 2		MAV 10.220 MAV 16.220 MAV 16.225 MAV 24.232		20 x 2 20 x 2 25 x 2 32 x 2	
with pegs for 2 lever, without adaptor * - used with enclosures size "57.27" - used with enclosures size "77.27" - used with enclosures size "77.27" - used with enclosures size "104.27"	CFV 10.213 CFV 16.216 CFV 16.221 CFV 24.221		13,5 x 2 16 x 2 21 x 2 21 x 2		MFV 10.220 MFV 16.220 MFV 16.225 MFV 24.232		20 x 2 20 x 2 25 x 2 32 x 2	
with pegs for 2 lever - used with enclosures size "77.27" - used with enclosures size "104.27"					CAF 16.221 CAF 24.221		21 x 2 21 x 2	MAF 16.225 MAF 24.225 25 x 2 25 x 2
with pegs for 2 lever, without adaptor * - used with enclosures size "77.27" - used with enclosures size "104.27"					CFF 16.221 CFF 24.221		21 x 2 21 x 2	MFF 16.225 MFF 24.225 25 x 2 25 x 2

* enclosure without adaptor, threaded on the body, to be used only with a complete cable clamp.

dimensions in mm

CZAV/CZVF L2 and (MZAV/MZVF L2)

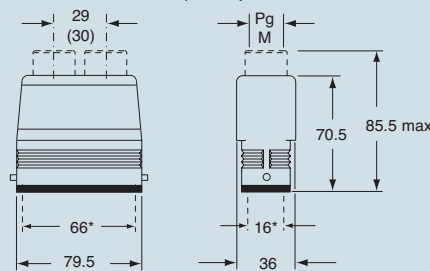

CAV/CFV and MAV/MFV

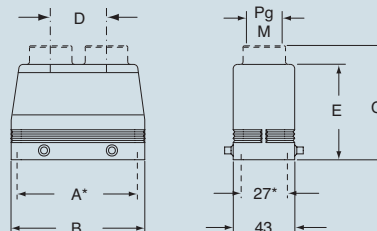

dimensions in mm

CAF/CFF and MAF/MFF

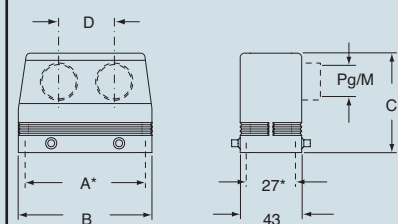

part No.	A*	B	C	D
CAF/CFF 16.221 / MAF/MFF 16.225	77.5	93.5	76	40
CAF/CFF 24.221 / MAF/MFF 24.225	104	120	76	50

*) screw fixing centre distance

CAV[®]US Type 4/4X/12

part No.	A*	B	C	D	E
CAV 10.213/MAV 10.220	57	73	82 (84.5)	26 (28.5)	70
CAV 16.216/MAV 16.220	77.5	93.5	89 (90.5)	35 (30)	76
CAV 16.221/MAV 16.225	77.5	93.5	90.5	40	76
CAV 24.221/MAV 24.232	104	120	90.5 (91)	50	76
CAV 24.229	104	120	90.5	50	76
CFV 10.213/MFV 10.220	57	73	--	28.5 (26)	70
CFV 16.216/MFV 16.220	77.5	93.5	--	30 (35)	76
CFV 16.221/MFV 16.225	77.5	93.5	--	40	76
CFV 24.221/MFV 24.232	104	120	--	50	76

*) screw fixing centre distance

dimensions indicated are not binding and may be changed without notice

enclosures:

- size "49.16".....from page 162
- size "66.16".....from page 166
- size "44.27".....from page 176
- size "57.27".....from page 184
- size "77.27".....from page 198
- size "104.27".....from page 212

inserts with screw fixing centre distance:

- 49 x 16 mm (enclosures CZAC 15 L)
- 66 x 16 mm (enclosures CZAC 25 L)
- 44 x 27 mm (enclosures CAC 06 L)
- 57 x 27 mm (enclosures CAC 10)
- 77.5 x 27 mm (enclosures CAC 16)
- 104 x 27 mm (enclosures CAC 24)
- 104 x 27 mm (enclosures CQO / MQO and CQV / MQV)

**enlarged hoods,
side or top entry**



**hoods
without entry, to be pierced**



description	part No.		part No.		part No.	
		entry Pg		entry M	with 2 pegs	with 4 pegs
used with enclosures size "104.27" - with pegs for two levers, side entry - with pegs for two levers, top entry	CQO 24 CQV 24	36 36	MQO 24.40 MQV 24.40	40 40		
with pegs for levers - used with enclosures size "49.19" - used with enclosures size "66.16" - used with enclosures size "44.27" - used with enclosures size "57.27" - used with enclosures size "77.27" - used with enclosures size "104.27"					CZAC 15 L CZAC 25 L CAC 06 L CAC 10 L CAC 16 L CAC 24 L	CAC 10 CAC 16 CAC 24

dimensions in mm

CQO and MQO

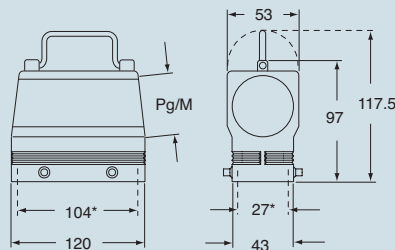

CQV and MQV

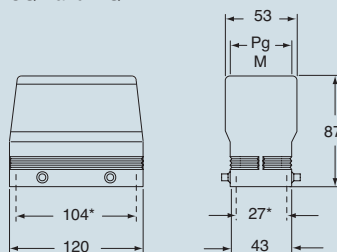

*) screw fixing centre distance

dimensions in mm

CZAC L

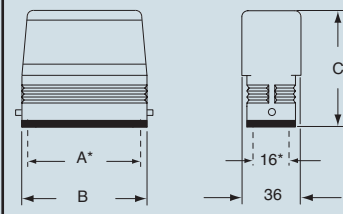

part No.	A*	B	C
CZAC 15 L	49.5	63	64.5
CZAC 25 L	66	79.5	70.5

*) screw fixing centre distance

CAC L

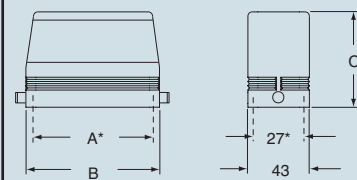

CAC

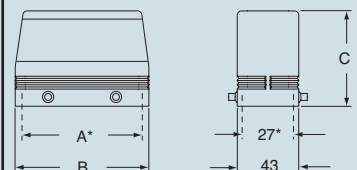

part No.	A*	B	C
CAC 06 L	44	60	72
CAC 10 - CAC 10 L	57	73	70
CAC 16 - CAC 16 L	77.5	93.5	76
CAC 24 - CAC 24 L	104	120	76

*) screw fixing centre distance

CALUS® Type 4/4X/12

(certification being applied for CQO and CQV 24, MQO and MQV 24.40)

dimensions indicated are not binding and may be changed without notice



inserts:		page
CD	64 poles + ⊕	45
CDD	108 poles + ⊕	58
CQE	46 poles + ⊕	77
CN	24 poles + ⊕	83
CCE	24 poles + ⊕	92
CNE, CSE	24 poles + ⊕	93
CSS	24 poles + ⊕	101
CMSE	10+2 (aux) poles + ⊕	118
CMCE	10+2 (aux) poles + ⊕	118
CX	4/8 poles + ⊕	133
MIXO	6 modules	137÷151

insert centre distance:
104 x 27 mm

hoods for ribbon cable
dual closure



NEW

seals
for ribbon cable hood



NEW

description	part No.	part No.
with levers, side entry	CAN 24	
ribbon cable seals (supplied separately) - a slot for cable sizes 18.8 x 5.8 mm - a slot for cable sizes 63.8 x 5.1 mm - a slot for cable sizes 36 x 9 mm - not pre-drilled		CRN 1 CRN 2 CRN 3 CRN P

dimensions in mm

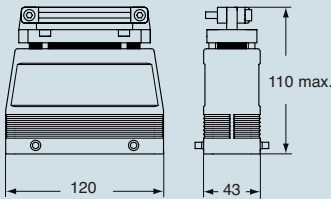

CAN

CEC® Type
US 4/4X/12
(certification being applied)

dimensions indicated are not binding
and may be changed without notice



inserts:	page
CME 10 + 2 (aux) poles + ⊕	119
CME, CMCE .. 16 + 2 (aux) poles + ⊕	124

insert centre distance:
104 x 27 mm

**hoods for ribbon cable
dual closure**



NEW

**seals
for ribbon cable hood**



NEW

description	part No.	part No.
with levers, side entry	CMAN 16	
ribbon cable seals (supplied separately) - a slot for cable sizes 18.8 x 5.8 mm - a slot for cable sizes 63.8 x 5.1 mm - a slot for cable sizes 36 x 9 mm - not pre-drilled		CRN 1 CRN 2 CRN 3 CRN P

dimensions in mm

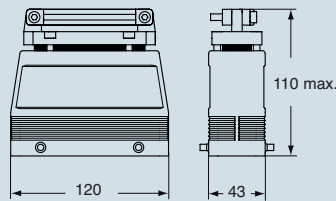

CEC® Type
US 4/4X/12
(certification being applied)

dimensions indicated are not binding
and may be changed without notice

cable passing hoods
degree of protection IP54



cable passing housings



description	part No.	part No.
-------------	----------	----------

with pegs for two levers
- 3 holes for round cables $\varnothing 5 \div 13.5$ mm
- 4 holes for round cables $\varnothing 5 \div 13.5$ mm

CYR 16.3
CYR 24.4

with two levers
- for hoods CYR 16.3
- for hoods CYR 24.4

CHI 16
CHI 24

CYR enclosures for round cables

The CYR enclosures are used in installations that require a passage for round cables for data transmission (e.g. computers or PLC) via equipment such as command or control panels, ensuring a good condition of the cable connections.

The enclosures are in two parts and have sealing gaskets to preserve the degree of protection of the equipment. The enclosures also contain a rapid cable block device.

The CYR 16.3 and 24.4 can be used with the bulkhead enclosures CHI 16 and CHI 24 respectively.

dimensions in mm

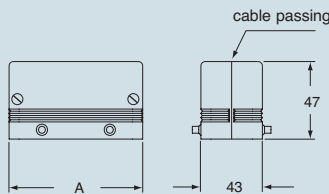

part No.	A	grommet entry	nr.
CYR 16.3	93.5	$\varnothing 5 / 13.5$	3
CYR 24.4	120	$\varnothing 5 / 13.5$	4

dimensions in mm

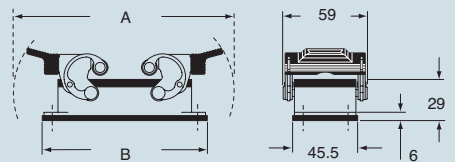

part No.	A	B
CHI 16	153	115.5
CHI 24	179.5	142.5

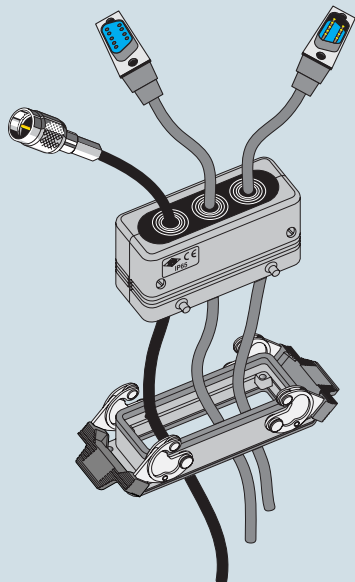

CHI housings panel cut-out in mm

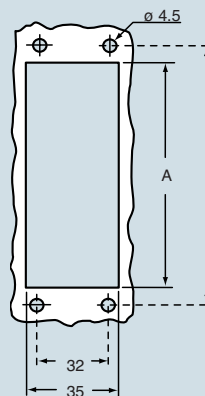

part No.	A	B
CHI 16	86	103
CHI 24	112	130

CALUS® Type 4/4X/12

(certification being applied for CYR 16.3 and CYR 24.4)

dimensions indicated are not binding and may be changed without notice

CYR

enclosures:
size "77.27"from page 198

inserts with screw fixing centre distance:
77.5 x 27 mm

N.B.: the enclosures ensure IP66 protection (or IP65 cover versions) rating when mated and locked with the closing levers.
The door only ensures mechanical protection, but does not ensure IP65 protection rating.

enclosures for in-line joints
degree of protection IP65



bulkhead housings
for in-line joint



description	part No.	part No.
without housings (to be ordered separately) made in two halves	CYG 16	
use with CYG for in-line joint - with one lever, without cover - with one lever and cover - with two levers - with pegs - with pegs and aluminium cover - with pegs and plastic cover		CHI 16 L CHI 16 LS CHI 16 CHI 16 C CHI 16 CS CHI 16 CP

CYG 16 in-line joint

- the joint is made with the CYG 16 enclosure and two bulkhead housings "size 77.27" with one or two levers (to be ordered separately).
- the joint is ideal for use with extension connections and/or as adaptor.
- made in two halves to facilitate conductor cabling.
- two inserts in various combinations may be inserted in the joint (to be ordered separately):

- » female/female inserts (as adaptor joint)
- » male/male inserts (as adaptor joint)
- » female/male inserts (as extension joint)

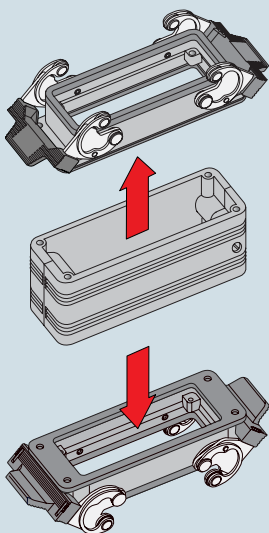

dimensions in mm

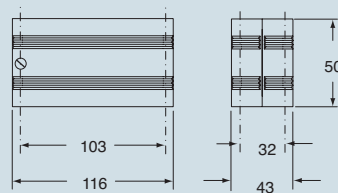

dimensions in mm

CHI 16 L

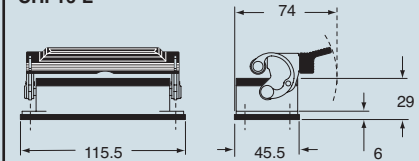

CHI 16 LS

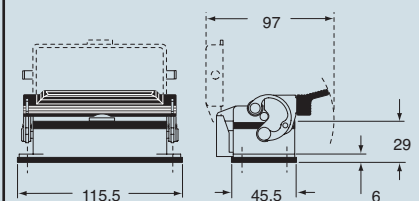

CHI 16

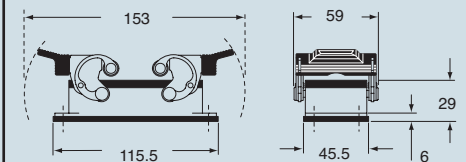

CHI C

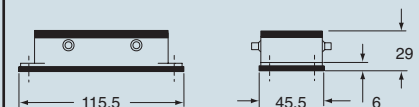

CHI 16 CS/CP

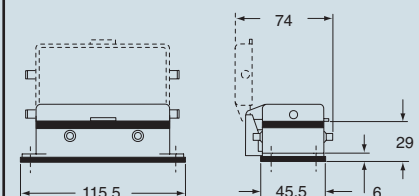

CALUS® Type 4/4X/12
(certification being applied for CYG 16)

dimensions indicated are not binding
and may be changed without notice

enclosures:

- size "44.27"from page 176
- size "57.27"from page 184
- size "77.27"from page 198
- size "104.27"from page 212

inserts with screw fixing centre distance:

- 44 x 27 mm (enclosures CHI and CAP/MAP 06...)
- 57 x 27 mm (enclosures CHI and CAP/MAP 10...)
- 77.5 x 27 mm (enclosures CHI and CAP/MAP 16...)
- 104 x 27 mm (enclosures CHI and CAP/MAP 24...)

bulkhead mounting housings for central lever



NEW

surface mounting housings, high construction with 2 entries for central lever



NEW

description	part No.	part No.	entry Pg	part No.	entry M
bulkhead mounting with pegs for central lever size "44.27" size "57.27" size "77.27" size "104.27"	CHI 06 YC CHI 10 YC CHI 16 YC CHI 24 YC				
surface mounting, high construction, with pegs, for central lever size "44.27" size "57.27" size "77.27" size "104.27"		CAP 06 YC229 CAP 10 YC229 CAP 16 YC229 CAP 24 YC229	29x2 29x2 29x2 29x2	MAP 06 YC232 MAP 10 YC232 MAP 16 YC232 MAP 24 YC232	32x2 32x2 32x2 32x2

panel cut-out bulkhead mounting housings in mm

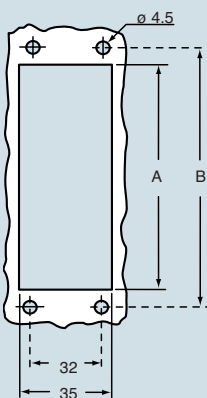

part No.	A	B
CHI 06 YC	52	70
CHI 10 YC	65	83
CHI 16 YC	86	103
CHI 24 YC	112	130

dimensions in mm

CHI YC

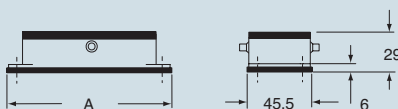

part No.	A
CHI 06 YC	82.5
CHI 10 YC	95.5
CHI 16 YC	115.5
CHI 24 YC	142.5

dimensions in mm

CAP YC and MAP YC

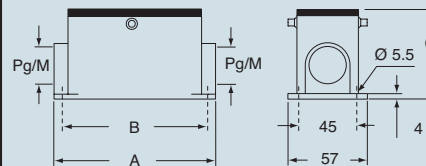

part No	A	B	C
CAP 06 YC / MAP 06 YC	82	70	74
CAP 10 YC / MAP 10 YC	93.5	82	74
CAP 16 YC / MAP 16 YC	117	105	81
CAP 24 YC / MAP 24 YC	144	132	81

special enclosures

CRUS® Type 4/4X/12

(certification being applied)

dimensions indicated are not binding and may be changed without notice

enclosures:

- size "44.27"from page 176
- size "57.27"from page 184
- size "77.27"from page 198
- size "104.27"from page 212

inserts with screw fixing centre distance:

- 44 x 27 mm (enclosures CAO/MAO and CAV/MAV 06...)
- 57 x 27 mm (enclosures CAO/MAO and CAV/MAV 10...)
- 77.5 x 27 mm (enclosures CAO/MAO and CAV/MAV 16...)
- 104 x 27 mm (enclosures CAO/MAO and CAV/MAV 24...)

hoods with central lever



NEW

hoods with central lever



NEW

description	part No.		entry Pg		part No.		entry M	
side entry, high construction								
size "44.27"	CAO 06 YX21	21	MAO 06 YX25	25				
size "44.27"	CAO 06 YX29	29	MAO 06 YX32	32				
size "57.27"	CAO 10 YX21	21	MAO 10 YX32	32				
size "57.27"	CAO 10 YX29	29	MAO 10 YX40	40				
size "77.27"	CAO 16 YX21	21	MAO 16 YX32	32				
size "77.27"	CAO 16 YX29	29	MAO 16 YX40	40				
size "104.27"	CAO 24 YX21	21	MAO 24 YX32	32				
size "104.27"	CAO 24 YX29	29	MAO 24 YX40	40				
top entry, high construction								
size "44.27"			CAV 06 YX21	21	MAV 06 YX25	25		
size "44.27"			CAV 06 YX29	29	MAV 06 YX32	32		
size "57.27"			CAV 10 YX21	21	MAV 10 YX32	32		
size "57.27"			CAV 10 YX29	29	MAV 10 YX40	40		
size "77.27"			CAV 16 YX21	21	MAV 16 YX32	32		
size "77.27"			CAV 16 YX29	29	MAV 16 YX40	40		
size "104.27"			CAV 24 YX21	21	MAV 24 YX32	32		
size "104.27"			CAV 24 YX29	29	MAV 24 YX40	40		

dimensions in mm
CAO..YX and MAO..YX

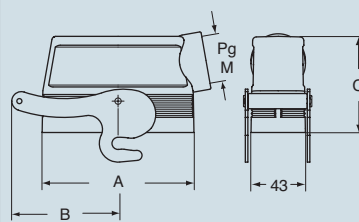

dimensions in mm
CAV..YX and MAV..YX

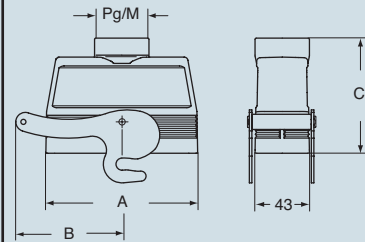

CAVUS® Type 4/4X/12

(certification being applied)

part No.	A	B	C
CAO 06 YX/MAO 06 YX	60	66	72
CAO 10 YX/MAO 10 YX	73	66	70
CAO 16 YX/MAO 16 YX	93.5	76	76
CAO 24 YX/MAO 24 YX	120	84	76

part No.	A	B	C
CAV 06 YX/MAV 06 YX	60	66	87 max
CAV 10 YX/MAV 10 YX	73	66	85
CAV 16 YX/MAV 16 YX	93.5	76	91
CAV 24 YX/MAV 24 YX	120	84	91

dimensions indicated are not binding and may be changed without notice

CG/MG series

The new CG/MG series of fixed and portable enclosures for connectors combines water tightness to IP68 rating and high mechanical sturdiness compliant with EMC standards.

The enclosures ensure the highest level of protection from external interferences; more specifically, they protect people from accessing the dangerous components housed inside the enclosures (direct contact) and they protect the internal connector inserts from the ingress of foreign matters (dust) and from the harmful effects of fluid ingress. The water tightness between the flush mounted enclosure and the panel is ensured by an O-ring seal held in position in a slot within the flush mounted enclosure base. A second O-ring seal fitted around the edges of the enclosure ensures the water tightness between the portable and the fixed enclosure when the connector is mated.

To ensure the water tightness when the enclosure is fitted onto a cabinet panel, the optional mounting frame with four M6 threaded blind holes may need to be installed inside the panel. The fastening screws must be fitted inside the enclosure and, through the fastening holes to be drilled on the panel, must be tightened onto the M6 mounting frame internal thread instead of the usual fastening nuts.

The flush mounted fixed enclosure fastening holes have been drilled inside the O-ring seal in order to avoid having to use other seals. Although these enclosures are larger than the standard enclosures to leave more space for the cables, and the walls are thicker to achieve more mechanical sturdiness, the fixing points have remained the same as those of the standard enclosures.

The series is offered with two types of locking systems: bayonet and screw. The two closing points are located in asymmetrical positions to ensure an optimal water tightness and the lowest footprint in case of multiple enclosures placed alongside at the front. The locking parts of both versions are made of high quality stainless steel and are firmly fastened inside the portable enclosure. These locking parts can be fitted and removed by using either a 1.5 mm flat blade screwdriver or a 10 mm hexagonal key.

The fixed and portable enclosures are made of foundry grade aluminium alloy, particularly resistant to sea water corrosion. The finish is made from epoxy polyester powder, which gives the enclosures high scratch and shock resistant properties.

The metal cover is made with the same quality materials as the enclosures, and is fitted with a short cord to make it always retrievable.

Scope of Application

External interconnections in vehicles, in harsh environments and in humid areas and with sensitive interconnections requiring screening.

They are particularly suitable for the applications in the railway industry and any application requiring high resistance to pressure, impact and corrosion, with IP68 protection rating. They also ensure a good screening for electromagnetic compatibility.

The IP68 protection rating printed on the enclosure is ensured if the enclosures are correctly installed and the cable entry devices have equal or higher rating.

Protection rating compliant with EN 60529 standard

When closed, the CG/MG enclosures protect the connector inserts fitted inside from outside interference, such as mechanical knocks, foreign bodies, humidity, dust, water or other fluids such as cleaning or cooling agents, oils etc.

The IP68 protection rating ensured by the enclosure is fully described in the EN 60529 standard, which classifies the enclosures according to their protection from the ingress of foreign bodies and water.

IP68 = total protection against dust, and from access to harmful parts with accessibility of Ø 1mm (First digit), and protection against the effects of prolonged submersion (>30') in water at the maximum depth of > 1 m (Second digit).

These enclosure have also successfully passed the tests required for the IPX6 protection rating compliant with EN 60529 standard and for the IPX9K protection rating compliant with DIN 40050-9 standard

The following table shows the different levels of protection required by the IP standard

1st Digit			2nd Digit		
IP	External solid objects	Protection	IP	Tests	Protection
0		none	0		none
1		against solid objects with Ø greater than 50 mm (for example contact with a hand)	1		against vertically falling drops of water
2		against solid objects with Ø greater than 12 mm (for example contact with a finger)	2		against vertically falling drops of water tilted at an angle of up to 15° from the vertical position
3		against solid objects with Ø greater than 2.5 mm (for example tools and wires)	3		against vertically falling drops of water tilted at an angle of up to 60° from the vertical position
4		against solid objects with Ø greater than 1 mm (for example thin tools and wires)	4		against water splashed from any direction
5		against dust (no harmful build-up)	5		against water jets from a nozzle from any direction
6		total protection against dust	6		against powerful water jets similar to sea waves
			7		against ingress of water when the enclosure is temporarily immersed in water at a maximum depth of 1 metre
			8		against the continuous submersion in water

special enclosures

- 1 Threaded cable entry hole, available in different Pg diameters (types with prefix starting with "C") or metric pitch (types with prefix starting with "M") compliant with EN 60423 standard, for cable entry devices compliant with EN 50262 standard, for vertical or horizontal layout.
- 2 Sturdy, corrosion proof foundry grade aluminium alloy enclosures, with chromate treated die cast. The following types are available: wall mounted, flush mounted fixed and portable enclosures with portable protective cover.
- 3 Oven painted with epoxy polyester powder in black RAL 9005, which gives the enclosures a high mechanical strength and makes them resistant to external agents.
- 4 The inserts are made of UL certified self-extinguishing fibreglass reinforced thermoplastics, and feature an operating temperature range between -40 °C and +125 °C.
- 5 Insert profile polarised with asymmetrical guides to avoid incorrect matings. The inserts have a mechanical life equal to or higher than 500 mating cycles.
- 6 Inserts are manufactured in compliance with European standard EN 61984 (DIN VDE 0627), certified and identified with UL and CSA markings.
- 7 Special NBR elastomere, anti-ageing, oil and fuel resistant seals which, together with the cable entry devices (not supplied) ensure mated connectors IP68 protection rating. The seals are internally positioned to give a better protection from sunlight and outside elements.
- 8 Fixings are available in two solutions: with hexagonal head stainless steel screws or bayonet type. The slotted hexagonal head screws can be fitted and removed by using either a 1.5mm thick blade screwdriver or a 10mm hexagonal key, and can be easily accessed even when fitted on enclosures with horizontally exited cables. Tightening torque 2.5 Nm.
- 9 Captive insert fastening screws, with anti-slackening spring washer.
- 10 Contact position identified with numbers or codes on both sides of each insert and printed with a laser system or from a die.
- 11 Silver or gold plated brass contacts connected to the wires by means of captive screws supplied already slackened, with spring terminal, by means of crimping (contacts available separately), or with a built-in 45° terminal block (still with screw or spring terminal).
- 12 Protective earth terminal with a wide contact surface.
- 13 CE marking which certifies compliance with the 73/23/EEC Low Voltage Directive and its 93/68/EEC amendment.
- 14 Fixed, flush mounted enclosure with fastening screws inside the seal.
- 15 Wider enclosures to give more space for the cabling.
- 16 They ensure a good screening for electromagnetic compatibility, resistance to vibrations in compliance with EN 61373 standard and to pressurised water.

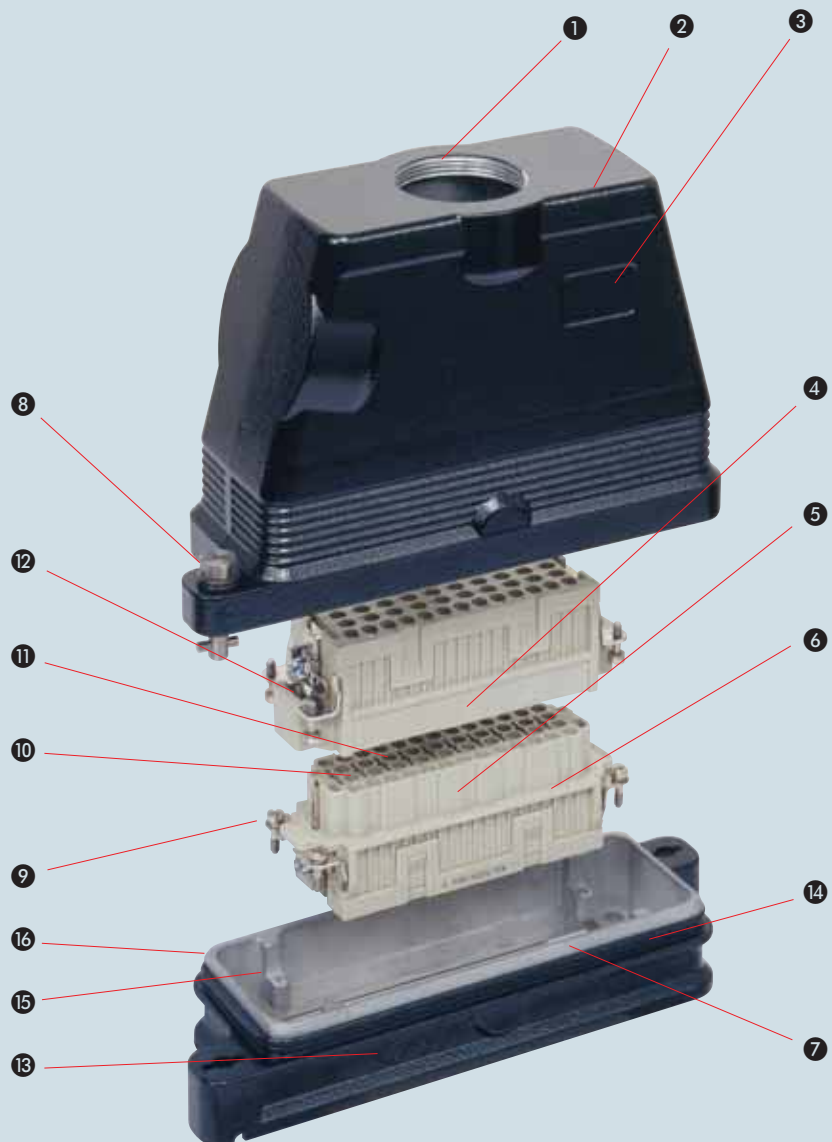



enclosures:
size "21.21" page 247

inserts with screw fixing centre distance:
21 x 21 mm

bulkhead mounting housing



angled bulkhead mounting housings



description	part No.	part No.		part No.	
		entry Pg	entry M	entry M	entry M
bulkhead mounting housing	CGK I				
without cable gland outlet		CGK IA	--		
with threaded entry		CGK IAP13	13,5	MGK IAP20	20

ON RESEARCH

ON RESEARCH

dimensions indicated are not binding and may be changed without notice

special enclosures



enclosures:
 size "21.21" page 246

inserts with screw fixing centre distance:
 21 x 21 mm

hoods



description	part No.	entry Pg	part No.	entry M
top entry	CGK V13	13,5	MGK V20	20

ON RESEARCH

dimensions indicated are not binding
 and may be changed without notice



enclosures and covers:

- size "44.27"page 249
- size "57.27"page 249
- size "77.27"page 249
- size "104.27"page 249

inserts with screw fixing centre distance:

- 44 x 27 mm (enclosures CGI and CGP/MGP 06)
- 57 x 27 mm (enclosures CGI and CGP/MGP 10)
- 77 x 27 mm (enclosures CGI and CGP/MGP 16)
- 104 x 27 mm (enclosures CGI and CGP/MGP 24)

bulkhead mounting housing

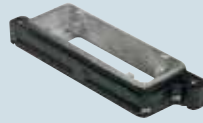

surface mounting housing



description	part No.	part No.		part No.	
		entry Pg	entry M	entry Pg	entry M
size "44.27"	CGI 06				
size "57.27"	CGI 10				
size "77.27"	CGI 16				
size "104.27"	CGI 24				
size "44.27"		CGP 06.29	29	MGP 06.32	32
size "57.27"		CGP 10.29	29	MGP 10.32	32
size "77.27"		CGP 16.36	36	MGP 16.40	40
size "104.27"		CGP 24.36	36	MGP 24.40	40
size "104.27"		CGP 24.236	36 x 2	MGP 24.240	40 x 2

panel cut-out for bulkhead mounting housings in mm

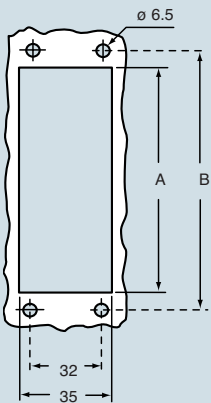

part No.	A	B
CGI 06	52	70
CGI 10	65	83
CGI 16	86	103
CGI 24	112	130

dimensions in mm

CGI

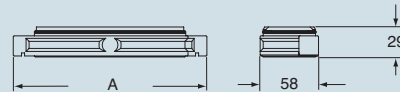

part No.	A
CGI 06	133
CGI 10	146
CGI 16	166
CGI 24	193

dimensions in mm

CGP and MGP

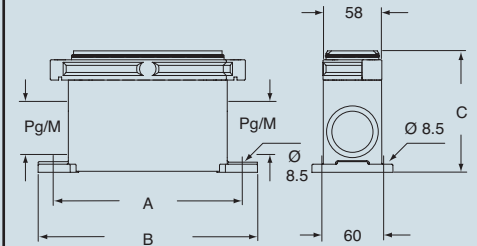

part No.	A	B	C
CGP 06 - MGP 06	127	156	110
CGP 10 - MGP 10	140	169	110
CGP 16 - MGP 16	160	189	121
CGP 24 - MGP 24	187	216	121

special enclosures



dimensions indicated are not binding and may be changed without notice



enclosures:

- size "44.27"page 248
- size "57.27"page 248
- size "77.27"page 248
- size "104.27"page 248

inserts with screw fixing centre distance:

- 44 x 27 mm (enclosures CGO/MGO and CGV/MGV 06)
- 57 x 27 mm (enclosures CGO/MGO and CGV/MGV 10)
- 77 x 27 mm (enclosures CGO/MGO and CGV/MGV 16)
- 104 x 27 mm (enclosures CGO/MGO and CGV/MGV 24)

hoods



covers



description	part No.		part No.		part No.
		entry Pg		entry M	
side entry					
size "44.27"	CGO 06.16	16	MGO 06.25	25	
size "44.27"	CGO 06.21	21	MGO 06.32	32	
size "44.27"	CGO 06.29	29			
size "57.27"	CGO 10.16	16	MGO 10.25	25	
size "57.27"	CGO 10.21	21	MGO 10.32	32	
size "57.27"	CGO 10.29	29			
size "77.27"	CGO 16.21	21	MGO 16.32	32	
size "77.27"	CGO 16.29	29	MGO 16.40	40	
size "77.27"	CGO 16.36	36	MGO 16.50	50	
size "104.27"	CGO 24.21	21	MGO 24.32	32	
size "104.27"	CGO 24.29	29	MGO 24.40	40	
size "104.27"	CGO 24.36	36	MGO 24.50	50	
top entry					
size "44.27"	CGV 06.16	16	MGV 06.25	25	
size "44.27"	CGV 06.21	21	MGV 06.32	32	
size "44.27"	CGV 06.29	29	MGV 06.40	40	
size "57.27"	CGV 10.16	16	MGV 10.25	25	
size "57.27"	CGV 10.21	21	MGV 10.32	32	
size "57.27"	CGV 10.29	29	MGV 10.40	40	
size "77.27"			MGV 16.25	25	
size "77.27"			MGV 16.225	25x2	
size "77.27"	CGV 16.21	21	MGV 16.32	32	
size "77.27"	CGV 16.221	21x2			
size "77.27"	CGV 16.29	29	MGV 16.40	40	
size "77.27"	CGV 16.36	36	MGV 16.50	50	
size "104.27"			MGV 24.325	25x3	
size "104.27"	CGV 24.21	21	MGV 24.32	32	
size "104.27"			MGV 24.232	32x2	
size "104.27"	CGV 24.29	29	MGV 24.40	40	
size "104.27"	CGV 24.229	29x2	MGV 24.240	40x2	
size "104.27"	CGV 24.36	36	MGV 24.50	50	
size "44.27"					CGC 06
size "57.27"					CGC 10
size "77.27"					CGC 16
size "104.27"					CGC 24

special enclosures



dimensions in mm
CGO/MGO and CGV/MGV

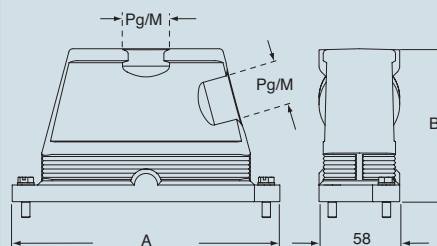

part No.	A	B
CGO/MGO and CGV/MGV 06	133	101
CGO/MGO and CGV/MGV 10	146	101
CGO/MGO and CGV/MGV 16	166	111
CGO/MGO and CGV/MGV 24	193	111

dimensions in mm
CGC

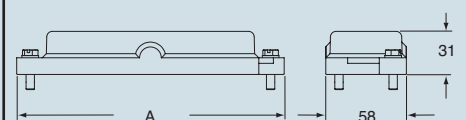

part No.	A
CGC 06	133
CGC 10	146
CGC 16	166
CGC 24	193

dimensions indicated are not binding and may be changed without notice

enclosures and covers:

- size "44.27"page 251
- size "57.27"page 251
- size "77.27"page 251
- size "104.27"page 251

inserts with screw fixing centre distance:

- 44 x 27 mm** (enclosures CGI 06 B)
- 57 x 27 mm** (enclosures CGI 10 B)
- 77 x 27 mm** (enclosures CGI 16 B)
- 104 x 27 mm** (enclosures CGI 24 B)

bulkhead mounting housings



description	part No.
size "44.27"	CGI 06 B
size "57.27"	CGI 10 B
size "77.27"	CGI 16 B
size "104.27"	CGI 24 B

panel cut-out for bulkhead mounting housings in mm

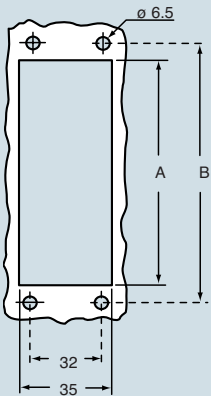

part No.	A	B
CGI 06 B	52	70
CGI 10 B	65	83
CGI 16 B	86	103
CGI 24 B	112	130

dimensions in mm

CGI..B

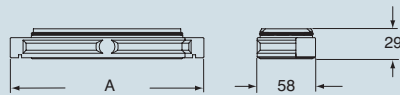

part No.	A
CGI 06 B	133
CGI 10 B	146
CGI 16 B	166
CGI 24 B	193

special enclosures



dimensions indicated are not binding and may be changed without notice



enclosures:

- size "44.27"page 250
- size "57.27"page 250
- size "77.27"page 250
- size "104.27"page 250

inserts with screw fixing centre distance:

- 44 x 27 mm (enclosures CGO/MGO and CGV/MGV 06 B)
- 57 x 27 mm (enclosures CGO/MGO and CGV/MGV 10 B)
- 77 x 27 mm (enclosures CGO/MGO and CGV/MGV 16 B)
- 104 x 27 mm (enclosures CGO/MGO and CGV/MGV 24 B)

hoods



covers



description	part No.		part No.		part No.
		entry Pg		entry M	
side entry					
size "44.27"	CGO 06.16 B	16	MGO 06.25 B	25	
size "44.27"	CGO 06.21 B	21	MGO 06.32 B	32	
size "44.27"	CGO 06.29 B	29			
size "57.27"	CGO 10.16 B	16	MGO 10.25 B	25	
size "57.27"	CGO 10.21 B	21	MGO 10.32 B	32	
size "57.27"	CGO 10.29 B	29			
size "77.27"	CGO 16.21 B	21	MGO 16.32 B	32	
size "77.27"	CGO 16.29 B	29	MGO 16.40 B	40	
size "77.27"	CGO 16.36 B	36	MGO 16.50 B	50	
size "104.27"	CGO 24.21 B	21	MGO 24.32 B	32	
size "104.27"	CGO 24.29 B	29	MGO 24.40 B	40	
size "104.27"	CGO 24.36 B	36	MGO 24.50 B	50	
top entry					
size "44.27"	CGV 06.16 B	16	MGV 06.25 B	25	
size "44.27"	CGV 06.21 B	21	MGV 06.32 B	32	
size "44.27"	CGV 06.29 B	29	MGV 06.40 B	40	
size "57.27"	CGV 10.16 B	16	MGV 10.25 B	25	
size "57.27"	CGV 10.21 B	21	MGV 10.32 B	32	
size "57.27"	CGV 10.29 B	29	MGV 10.40 B	40	
size "77.27"			MGV 16.25 B	25	
size "77.27"			MGV 16.225 B	25x2	
size "77.27"	CGV 16.21 B	21	MGV 16.32 B	32	
size "77.27"	CGV 16.221 B	21x2			
size "77.27"	CGV 16.29 B	29	MGV 16.40 B	40	
size "77.27"	CGV 16.36 B	36	MGV 16.50 B	50	
size "104.27"			MGV 24.325 B	25x3	
size "104.27"	CGV 24.21 B	21	MGV 24.32 B	32	
size "104.27"			MGV 24.232 B	32x2	
size "104.27"	CGV 24.29 B	29	MGV 24.40 B	40	
size "104.27"	CGV 24.229 B	29x2	MGV 24.240 B	40x2	
size "104.27"	CGV 24.36 B	36	MGV 24.50 B	50	
size "44.27"					CGC 06 B
size "57.27"					CGC 10 B
size "77.27"					CGC 16 B
size "104.27"					CGC 24 B

dimensions in mm

CGO/MGO..B and CGV/MGV..B

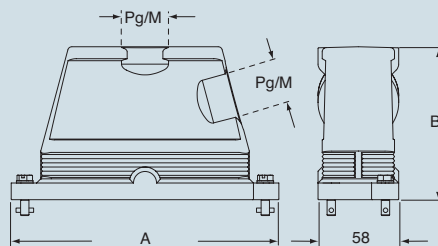

part No.	A	B
CGO/MGO and CGV/MGV 06 B	133	101
CGO/MGO and CGV/MGV 10 B	146	101
CGO/MGO and CGV/MGV 16 B	166	111
CGO/MGO and CGV/MGV 24 B	193	111

dimensions in mm

CGC..B

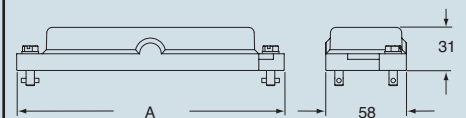

part No.	A
CGC 06 B	133
CGC 10 B	146
CGC 16 B	166
CGC 24 B	193



dimensions indicated are not binding and may be changed without notice



bulkhead mounting housings:

- size "44.27"page 248-250
- size "57.27"page 248-250
- size "77.27"page 248-250
- size "104.27"page 248-250

frames for bulkhead mounting housings

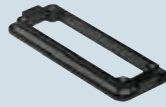

description	part No.
size "44.27"	CG 06 FL
size "57.27"	CG 10 FL
size "77.27"	CG 16 FL
size "104.27"	CG 24 FL

dimensions in mm

CG..FL

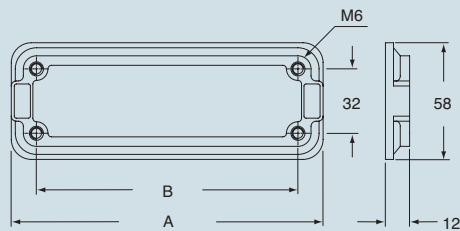

part No.	A	B
CG 06 FL	96	70
CG 10 FL	109	83
CG 16 FL	129	103
CG 24 FL	156	130

special enclosures

CRUS® Type 4/4X/12

dimensions indicated are not binding and may be changed without notice



enclosures:

size "44.27"from page 176

size "57.27"from page 184

inserts with screw fixing centre distance:

44 x 27 mm

57 x 27 mm

1 branch-off T-BOX coupling



NEW

1 branch-off T-BOX coupling
be fitted on DIN rails



NEW

description	part No.	part No.
for 2 C portable enclosures with lever and seal "44.27" size and one CHI enclosure "44.27" A size	CYG 06H06	
for 2 C portable enclosures with lever and seal "44.27" size and one CHI enclosure "57.27" A size	CYG 06H10	
for 2 C portable enclosures with lever and seal "44.27" size and one CHI enclosure "44.27" A size		CYG 06H06D
for 2 C portable enclosures with lever and seal "44.27" size and one CHI enclosure "57.27" A size		CYG 06H10D

How to use the CYG 06H branch coupling

The cables are branched off by using the CYG 06H coupling in the 1 or 2 branch-off versions. Multi-pole inserts "44.27" size can be fitted inside the two side recesses.

The entire unit can be used with one lever flying enclosures complete with connector inserts.

The front faces can be fitted with "44.27" and/or "57.27" size flush mounted enclosures.

The coupling may also be used as an adapter by using a combination of different insert versions.

The CHC 06 LG cover may be used to close the coupling side faces.

In the branch-offs, the CSS series dual spring terminal inserts allow two wires to be connected without having to fit additional terminals inside the coupling.

dimensions in mm

CYG...H06 / H10

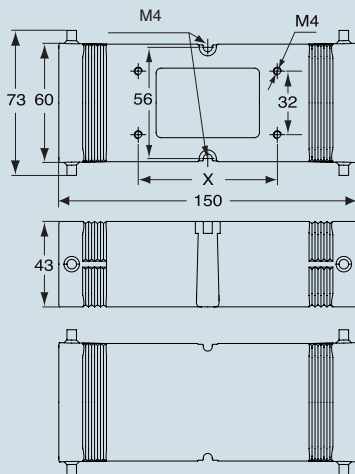

part No.	X
CYG 06H06	70
CYG 06H10	83

dimensions in mm

CYG...H06D / H10D

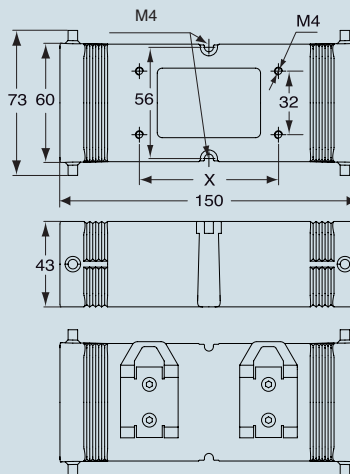

part No.	X
CYG 06H06D	70
CYG 06H10D	83

part No.	A	C
	CHI	CHV .. LG *
CYG 06H06	06	06
CYG 06H10	10	06
CYG 06H06D	06	06
CYG 06H10D	10	06

* the following enclosures may also be used:
MHV / CAV / MAV / CFV / MFV 06 LG

CALUS® Type 4/4X/12

(certification being applied)

dimensions indicated are not binding and may be changed without notice

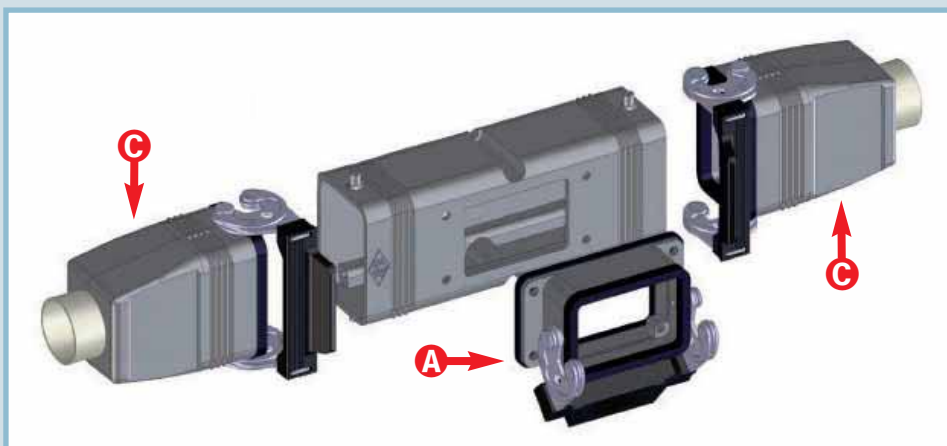

enclosures:

size "44.27"from page 176
 size "57.27"from page 184

inserts with screw fixing centre distance:

44 x 27 mm
 57 x 27 mm

2 branch-off T-BOX coupling



NEW

2 branch-off T-BOX coupling



NEW

description	part No.	part No.
for 2 "44.27" size portable enclosures with lever and seal and 1 "44.27" size fixing side CHI enclosure and one "57.27" size CHI enclosure	CYG 06H0610	
for 2 "44.27" size portable enclosures with lever and seal and 1 "57.27" size fixing side CHI enclosure and one "44.27" size CHI enclosure	CYG 06H1006	
for 2 "44.27" size portable enclosures with lever and seal and two "44.27" size CHI enclosures		CYG 06H0606
for 2 "44.27" size portable enclosures with lever and seal and two "57.27" size CHI enclosures		CYG 06H1010

How to use the CYG 06H branch coupling

The cables are branched off by using the CYG 06H coupling in the 1 or 2 branch-off versions. Multi-pole inserts "44.27" size can be fitted inside the two side recesses. The entire unit can be used with one lever flying enclosures complete with connector inserts. The front faces can be fitted with "44.27" and/or "57.27" size flush mounted enclosures. The coupling may also be used as an adapter by using a combination of different insert versions. The CHC 06 LG cover may be used to close the coupling side faces. In the branch-offs, the CSS series dual spring terminal inserts allow two wires to be connected without having to fit additional terminals inside the coupling.

dimensions in mm

CYG...H0610 / H1006 and CYG...H0606 / H1010

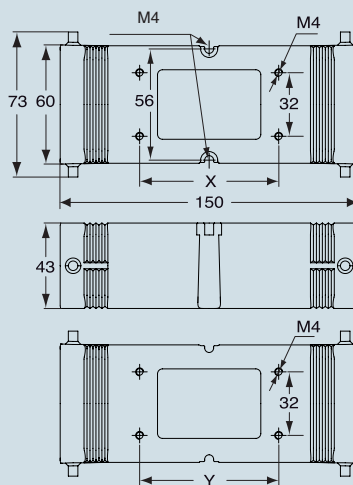

part No.	X	Y
CYG 06H0610	83	70
CYG 06H1006	70	83
CYG 06H0606	70	70
CYG 06H1010	83	83

part No.	A	B	C
	CHI	CHI	CHV .. LG *
CYG 06H0610	06	10	06
CYG 06H1006	10	06	06
CYG 06H0606	06	06	06
CYG 06H1010	10	10	06

* the following enclosures may also be used:
 MHV / CAV / MAV / CFV / MFV 06 LG

CALUS® Type 4/4X/12
 (certification being applied)

dimensions indicated are not binding and may be changed without notice

