



inserts: page
CME3 + 2 (aux) poles + ⊕ 115

insert centre distance:
57 x 27 mm

bulkhead mounting housings with 2 levers or 4 pegs



bulkhead mounting housings with single lever



description	part No.	part No.
with one or two levers	CMI 03	CMI 03 L
with pegs and aluminium cover ¹⁾	CMI 03 CS	
with pegs and plastic cover ¹⁾	CMI 03 CP	
with lever and cover		CMI 03 LS

¹⁾ May be combined with hoods:
 - CMO/CMAO 03 X e CMV/CMAV 03 X
 - MMO/MMAO 03 X e MMV/MMAV 03 X

N.B.: the enclosures ensure IP66 protection (or IP65 cover versions) rating when mated and locked with the closing levers.
 The cover (CS, CP) only ensures mechanical protection, but does not ensure IP65 protection rating.

panel cut-out for bulkhead mounting housings in mm

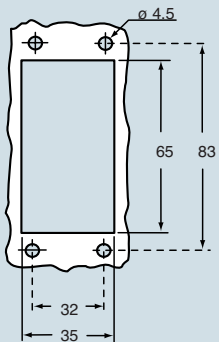

dimensions in mm

CMI

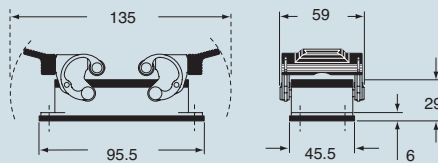

dimensions in mm

CMI L

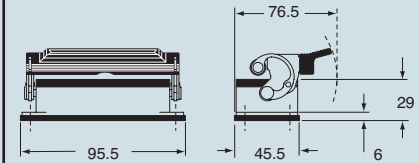

CMI CS/CP

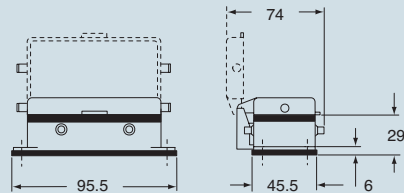

CMI LS

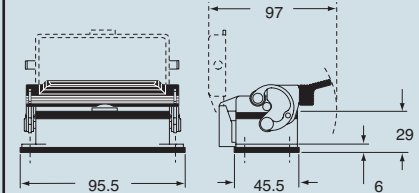

CRAUS® Type 4/4X/12
 (excluding enclosures with plastic cover)

dimensions indicated are not binding and may be changed without notice

size 57.27



inserts: page
CME3 + 2 (aux) poles + ⊕ 115

insert centre distance:
57 x 27 mm

surface mounting housings with 2 levers or 4 pegs



surface mounting housings with single lever



description	part No.		part No.		part No.		part No.	
		entry Pg		entry M		entry Pg		entry M
with levers	CMP 03	16	MMP 03.20	20	CMP 03 L	16	MMP 03 L20	20
with levers	CMP 03.2	16 x 2	MMP 03.220	20 x 2	CMP 03 L2	16 x 2	MMP 03 L220	20 x 2
with levers, high construction	CMAP 03.21	21	MMAP 03.32	32	CMAP 03 L	21	MMAP 03 L32	32
with levers, high construction	CMAP 03.221	21 x 2	MMAP 03.232	32 x 2	CMAP 03 L2	21 x 2	MMAP 03 L232	32 x 2
with levers, high construction	CMAP 03.29	29	MMAP 03.40	40	CMAP 03 L29	29	MMAP 03 L40	40
with levers, high construction	CMAP 03.229	29 x 2	MMAP 03.240	40 x 2	CMAP 03 L229	29 x 2	MMAP 03 L240	40 x 2
with pegs and aluminium cover ¹⁾	CMP 03 CS	16	MMP 03 CS20	20				
with pegs and aluminium cover ¹⁾	CMP 03 CS2	16 x 2	MMP 03 CS220	20 x 2				
with pegs and aluminium cover, high construction ¹⁾	CMAP 03 CS	21	MMAP 03 CS32	32				
with pegs and aluminium cover, high construction ¹⁾	CMAP 03 CS2	21 x 2	MMAP 03CS232	32 x 2				
with pegs and aluminium cover, high construction ¹⁾	CMAP 03 CS29	29	MMAP 03 CS40	40				
with pegs and aluminium cover, high construction ¹⁾	CMAP 03CS229	29 x 2	MMAP 03CS240	40 x 2				
with pegs and plastic cover ¹⁾	CMP 03 CP	16	MMP 03 CP20	20				
with pegs and plastic cover ¹⁾	CMP 03 CP2	16 x 2	MMP 03 CP220	20 x 2				
with pegs and plastic cover, high construction ¹⁾	CMAP 03 CP	21	MMAP 03 CP32	32				
with pegs and plastic cover, high construction ¹⁾	CMAP 03 CP2	21 x 2	MMAP 03CP232	32 x 2				
with pegs and plastic cover, high construction ¹⁾	CMAP 03 CP29	29	MMAP 03 CP40	40				
with pegs and plastic cover, high construction ¹⁾	CMAP 03CP229	29 x 2	MMAP 03CP240	40 x 2				
with lever and cover					CMP 03 LS	16	MMP 03 LS20	20
with lever and cover					CMP 03 LS2	16 x 2	MMP 03 LS220	20 x 2
with lever and cover, high construction					CMAP 03 LS	21	MMAP 03 LS32	32
with lever and cover, high construction					CMAP 03 LS2	21 x 2	MMAP 03LS232	32 x 2
with lever and cover, high construction					CMAP 03 LS29	29	MMAP 03 LS40	40
with lever and cover, high construction					CMAP 03LS229	29 x 2	MMAP 03LS240	40 x 2

¹⁾ May be combined with hoods:
 - CMO/CMAO 03 X and CMV/CMAV 03 X
 - MMO/MMAO 03 X and MMV/MMAV 03 X

N.B.: the enclosures ensure IP66 protection (or IP65 cover versions) rating when mated and locked with the closing levers.
 The cover (CS, CP) only ensures mechanical protection, but does not ensure IP65 protection rating.

dimensions in mm

CMP - CMAP and MMP - MMAP

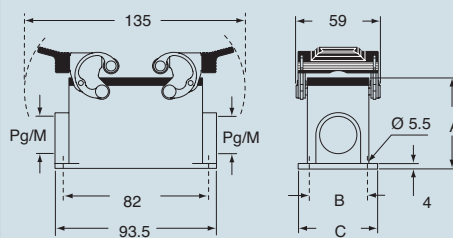

CMP CS/CP - CMAP CS/CP and MMP CS/CP - MMAP CS/CP

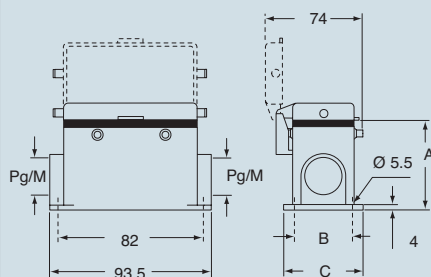

type	A	B	C
CMP / MMP	57	40	52
CMAP / MMAP	74	45	57
CMP CS / MMP CS	57	40	52
CMAP CS / MMAP CS	74	45	57
CMP CP / MMP CP	57	40	52
CMAP CP / MMAP CP	74	45	57

dimensions in mm

CMP L - CMAP L and MMP L - MMAP L

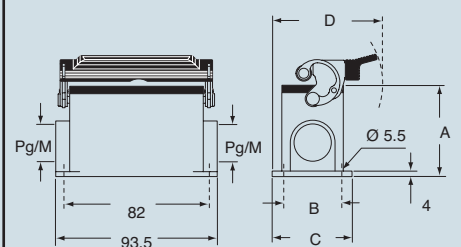

CMP LS - CMAP LS and MMP LS - MMAP LS

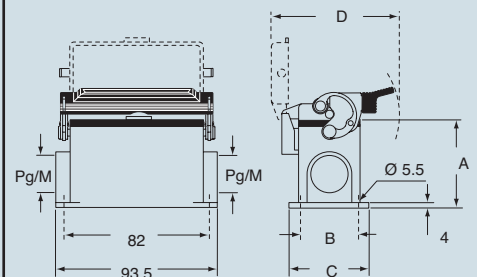

type	A	B	C	D
CMP L / MMP L	57	40	52	79.5
CMAP L / MMAP L	74	45	57	82
CMP LS / MMP LS	57	40	52	97
CMAP LS / MMAP LS	74	45	57	97

CRAUS® Type 4/4X/12

(excluding enclosures with plastic cover)

dimensions indicated are not binding and may be changed without notice

size 57.27



inserts: page
CME3 + 2 (aux) poles + ⊕ 115

insert centre distance:
57 x 27 mm

hoods with 4 pegs



hoods with 2 pegs

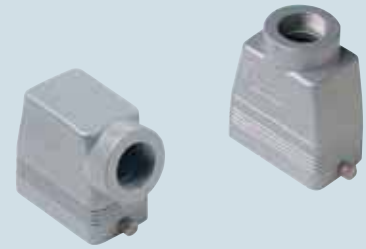

description	part No.		part No.		part No.		part No.	
		entry Pg		entry M		entry Pg		entry M
with pegs, side entry	CMO 03	16	MMO 03.20	20	CMO 03 L	16	MMO 03 L20	20
with pegs, side entry			MMO 03.25	25			MMO 03 L25	25
with pegs, side entry, high construction	CMAO 03.21	21	MMAO 03.32	32	CMAO 03 L21	21	MMAO 03 L32	32
with pegs, side entry, high construction	CMAO 03.29	29	MMAO 03.40	40	CMAO 03 L29	29	MMAO 03 L40	40
with pegs, top entry	CMV 03	16	MMV 03.20	20	CMV 03 L	16	MMV 03 L20 **	20
with pegs, top entry			MMV 03.25	25			MMV 03 L25	25
with pegs, top entry, high construction	CMAV 03.21	21	MMAV 03.32	32	CMAV 03 L21	21	MMAV 03 L32	32
with pegs, top entry, high construction	CMAV 03.29	29	MMAV 03.40	40	CMAV 03 L29	29	MMAV 03 L40	40
with pegs, frontal entry, high construction	CMAF 03	16	MMAF 03.20	20				
with pegs, frontal entry, high constr., without adaptor *	CMFF 03	16	MMFF 03.20	20				

* enclosure without adaptor, threaded on the body, to be used only with a complete cable clamp.

** can only be used with a complete cable clamp (to be purchased separately)

dimensions in mm

CMO (CMAO) and MMO (MMAO)

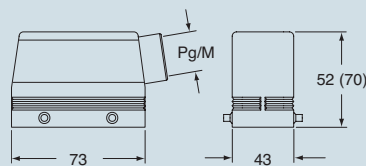

dimensions in mm

CMO L (CMAO L) and MMO L (MMAO L)

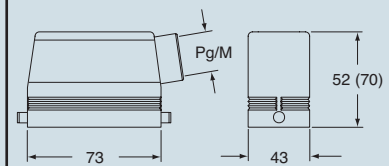

CMV (CMAV) and MMV (MMAV)

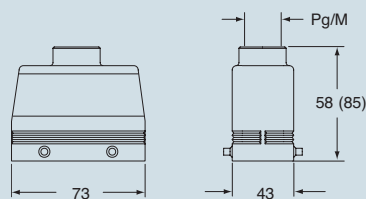

CMV L (CMAV L) and MMV L (MMAV L)

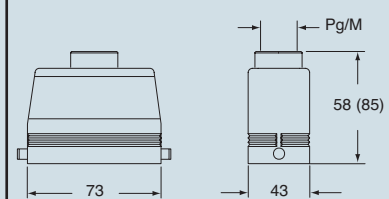

CMAF/CMFF and MMAF/MMFF

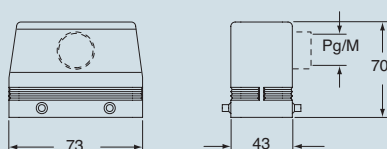

dimensions indicated are not binding and may be changed without notice

size 57.27



inserts: page
CME3 + 2 (aux) poles + ⊕ 115

insert centre distance:
57 x 27 mm

hoods with 2 levers



hoods with single lever



description	part No.		entry Pg		part No.		entry M	
with levers and gasket, top entry	CMV 03 G	16	MMV 03 G25	25	CMV 03 LG	16	MMV 03 LG25	25
with levers and gasket, top entry, high construction	CMAV 03 G	21	MMAV 03 G25	25	CMAV 03 LG21	21	MMAV 03 LG25	25
with levers and gasket, top entry, high construction	CMAV 03 G29	29	MMAV 03 G32	32	CMAV 03 LG29	29	MMAV 03 LG32	32
with levers and gasket, top entry, high constr., without adaptor *	CMFV 03 G	21	MMFV 03 G25	25	CMFV 03 LG21	21	MMFV 03 LG25	25
with levers and gasket, top entry, high constr., without adaptor *	CMFV 03 G29	29	MMFV 03 G32	32	CMFV 03 LG29	29	MMFV 03 LG32	32

* enclosure without adaptor, threaded on the body, to be used only with a complete cable clamp.

dimensions in mm

**CMV G (CMAV G) and [CMFV G],
 MMV G (MMAV G) and [MMFV G]**

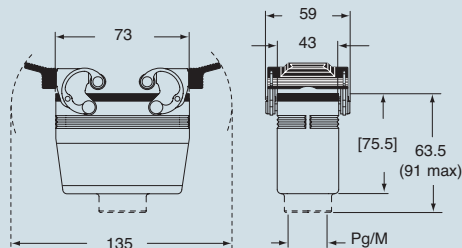

dimensions in mm

**CMV LG (CMAV LG) and [CMFV LG],
 MMV LG (MMAV LG) and [MMFV LG]**

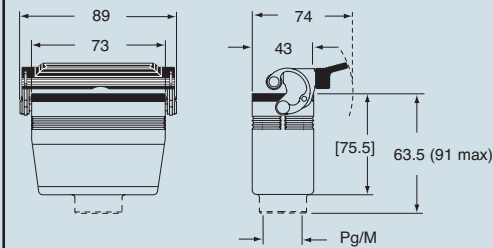

size 57.27



dimensions indicated are not binding and may be changed without notice



inserts: page
CME3 + 2 (aux) poles + ⊕ 115

insert centre distance:
57 x 27 mm

Covers G and LG version are not suitable to be used with code pins. If this application is required please contact ILME SpA.

hoods with 2 levers



covers

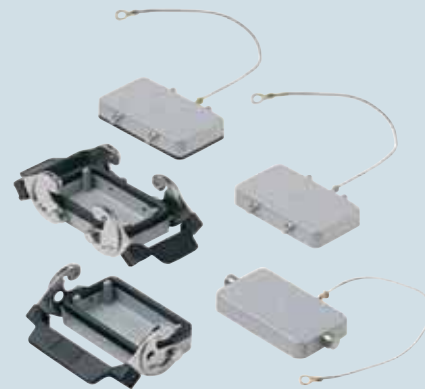

description	part No.		part No.		part No.
		entry Pg		entry M	
with levers, side entry ¹⁾	CMO 03 X	16	MMO 03 X20	20	
with levers, side entry ¹⁾			MMO 03 X25	25	
with levers, side entry, high construction ¹⁾	CMAO 03 X	21	MMAO 03 X32	32	
with levers, side entry, high construction ¹⁾	CMAO 03 X29	29	MMAO 03 X40	40	
with levers, top entry ¹⁾	CMV 03 X	16	MMV 03 X20	20	
with levers, top entry ¹⁾			MMV 03 X25	25	
with levers, top entry, high construction ¹⁾	CMAV 03 X	21	MMAV 03 X32	32	
with levers, top entry, high construction ¹⁾	CMAV 03 X29	29	MMAV 03 X40	40	
with 4 pegs (for housings with 2 levers with gasket)					CHC 10
with 4 pegs and gasket (for housings with 2 levers) ²⁾					CHC 10 C
with 2 pegs (for housings with 1 lever with gasket)					CHC 10 L
with 2 levers (for hoods with 4 pegs)					CHC 10 G
with 1 lever (for hoods with 2 pegs)					CHC 10 LG

¹⁾ May be combined with housings:
 - CMI/CMP/CMAV 03 CS/CP
 - MMP/MMAV 03 CS/CP

²⁾ May be combined with housings:
 - CMO/CMAO 03 X and CMV/CMAV 03 X
 - MMO/MMAO 03 X and MMV/MMAV 03 X

dimensions in mm

CMO X (CMAO X) and MMO X (MMAO X)

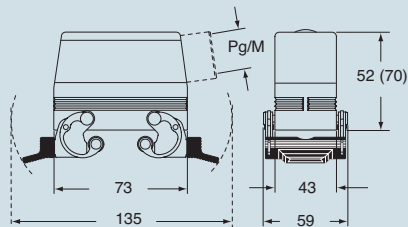

CMV X (CMAV X) and MMV X (MMAV X)

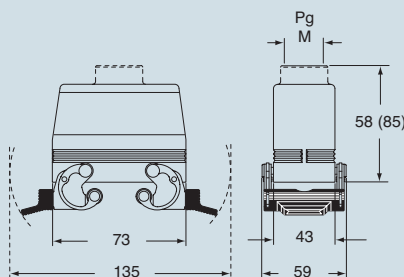

dimensions in mm

CHC

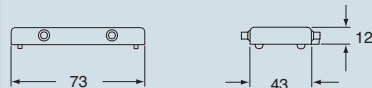

CHC C

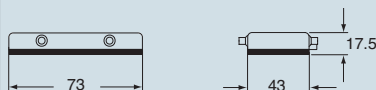

CHC L



CHC G

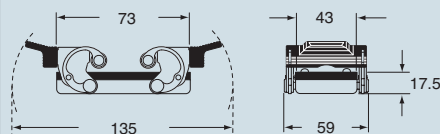

CHC LG

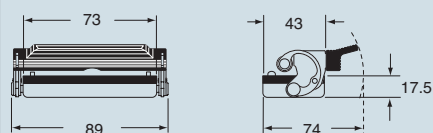

CALUS® Type 4/4X/12

dimensions indicated are not binding and may be changed without notice

size 57.27