

RoHS compliant

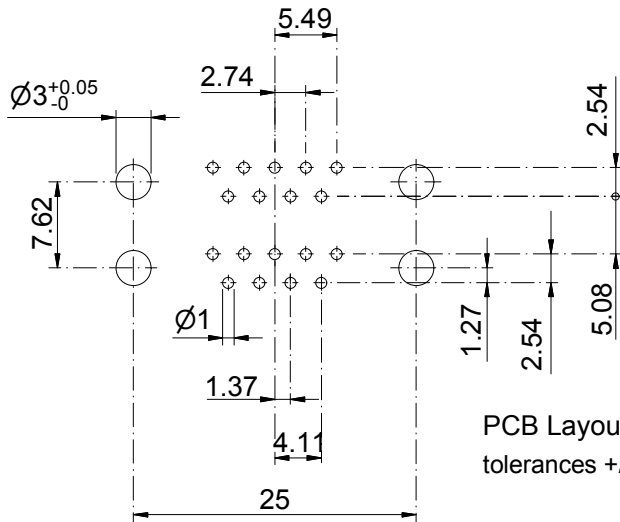

PCB Layout tolerances +/-0.1

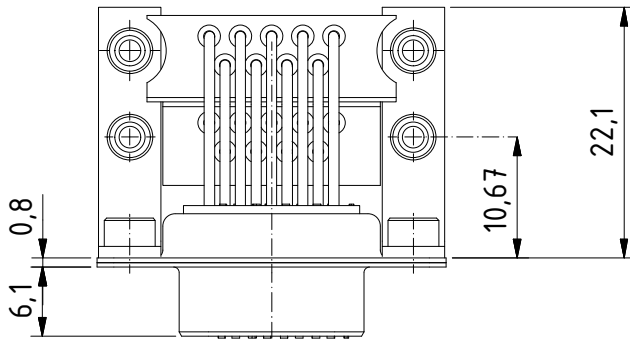
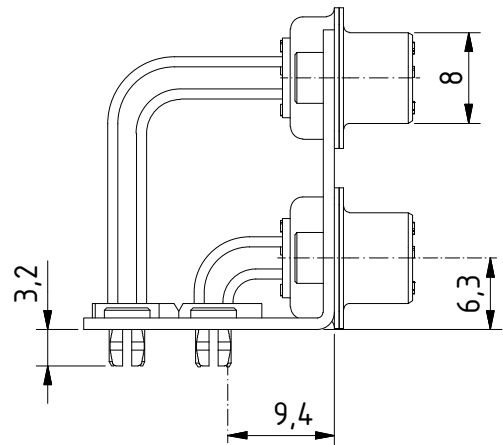
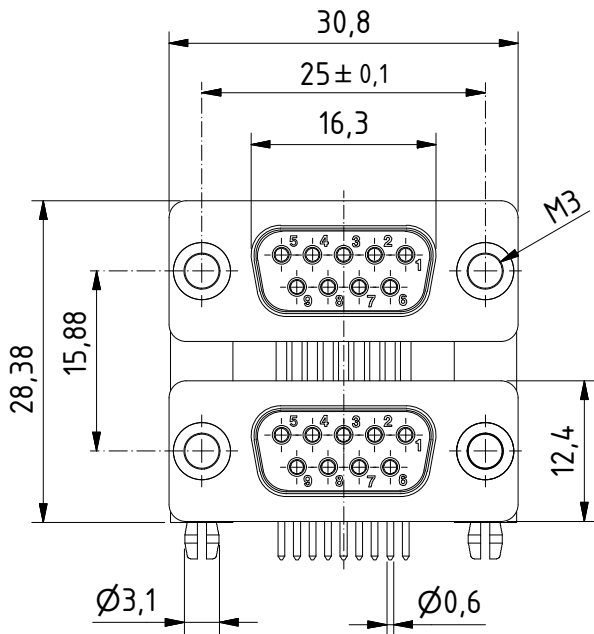
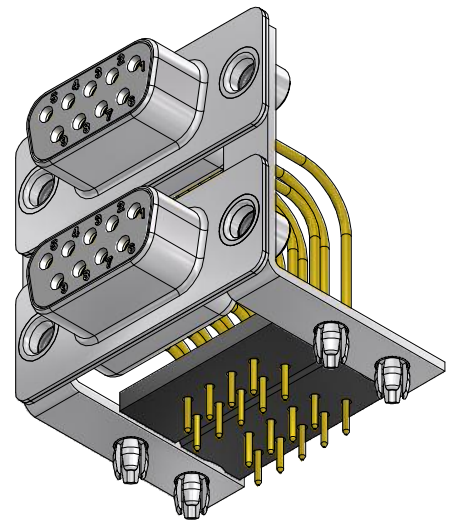

MATERIALS

- Insulator: Thermoplastic UL 94-V-0 white
- Contact: Copper alloy
- Contact finish: Quality class 1
- Shell: steel tin plated

CHARAKTERISTICS

- Working voltage: 125V
- Current rating: 5A
- Contact resistance: max. 10mΩ - DIN41652
- Insulation resistance: >5GΩ
- Temperature range: -55° to +125°C

General tolerances (Deltron standard)			
size in mm			
> 0.5	> 3	> 6	> 30
up to 3	up to 6	up to 30	up to 120
tolerances			
±0.1	±0.2	±0.2	±0.3

modification	Rev. a) 17.05.2013 mw	Rev.	Rev.	DE016343		
	Rev.	Rev.	Rev.	part no.		
MDPA09SN34/09SN34-S/1	1.5:1	drawn	24.04.2013	mw		
		checked				
		approved				
 Industrie Neuhof 8c CH-3422 Kirchberg			K061357 a			
			drawing no.			